

| Pos. Nr. Pos.no. | Beschreibung Description | Art.-Nr. Art.no. | Preisgruppe Price bracket |
|---------------------|--|---------------------|------------------------------|
| 1 | LOKGEHAEUSE BR 64 DB Body assembly complete | 10406101 | 031 |
| 2 | LICHTLEITER-SATZ Light conductor set | 00131063 | 012 |
| 3 | BESCHWERUNG Ballast | 00164063 | 016 |
| 4 | PFEIFE Whistle | 00194601 | 004 |
| 5 | LEITERN-SATZ Set of ladders | 00224175 | 011 |
| 6 | FAHRGESTELL MIT MOTOR, BESCHWE Chassis complete with motor&ballast | 40406101 | --- |
| 7 | LOKFAHRGESTELL M.MOTOR,GETRIEB Chassis with motor and gear train | 41406101 | --- |
| 8 | DECKPLATTE Cover plate | 00414064 | 007 |
| 9 | STEUERUNG KPL.M.KUPPELSTANGEN Reversing gear complete with coupling rods | 42406101 | --- |
| 10 | ZYLINDERKASTEN F.4062/4143 Cylinder box | 00434062 | 011 |
| 11 | LUFTKESSEL Air tank | 00444064 | 006 |
| 12 | KESSELSTUETZE KPL. Boiler support, complete | 00454063 | 013 |
| 13 | VORLAUFGESTELL M.ANDRUCKFEDER Carrying wheelset (front/rear) with pressure spring | 00474063 | 015 |
| 14 | ANKER KPL.M.SCHWUNGMASSE Rotor complete with integr. flywheel | 00504607 | 025 |
| 15 | LAGERSCHILD ISOL.M.SCHNITTST. Motor PCB, insulated, with interface | 00504731 | 017 |
| 16 | KOHLLENROHRKAPPE Brush pipe cap | 00504801 | 002 |
| 17 | L.RAD F.VOR.-NACHLAUF ROT Carrying wheel for carrying wheelset front/rear | 00514218 | 006 |
| 18 | KUPPELRAD LI. ROT BR 24/64/65 Left coupled wheel, red paint | 00514224 | 006 |
| 19 | KUPPELRAD RECHTS ISO.ROT Right coupled wheel, insulated, red | 00514226 | 007 |
| 20 | L.RAD F.VOR.-NACHLAUF ISO. Carrying wheel, insul., for carrying wheelset front/rear | 00514228 | 007 |
| 21 | L.RAD M.Z.O.N. Loco wheel with gear, w/o traction tyre | 00514291 | 008 |
| 22 | TREIBRAD RECHTS ISO.ROT Right driving wheel, insulated, red | 00514292 | 008 |
| 23 | TREIBRAD LINKS ROT F.BR 24/64 Left driving wheel, red | 00514293 | 008 |
| 24 | ACHSE GERAENDEL 20 MM Milled axle, 20mm | 00524006 | 002 |
| 25 | UNTERSETZUNGSRAD Z:28/13 SCHWA Reduction gear wheel Z:28/13, black | 00564102 | 002 |
| 26 | ZAHNRAD Z:32 ROT Gear wheel Z:32, red | 00564137 | 002 |
| 27 | UNTERSETZUNGSRAD Z:32/13 ROT Reduction gear wheel Z:32/13, red | 00564138 | 002 |
| 28 | RITZEL Z:15 Gear wheel Z:15 | 00564604 | 006 |
| 29 | SICHERUNGSRING GROSS Securing ring, big | 00564702 | 001 |
| 30 | UNTERLEGSCH. ROT 2,2X5X0,5 Washer, red 2.2X5X0.5 | 00564742 | 001 |
| | UNTERLEGSCH. ROT 2,3 X 5 X 0,1 (o. Abb.) Washer 2.3X5X0.3 (collector side) (w/o illustr.) | 00564747 | 001 |
| | UNTERLEGSCH. ROT 2,2X5X0,3 (o. Abb.) Washer, red 2.2X5X0.3 (gear side) (w/o illustr.) | 00564751 | 001 |
| 33 | STROMABNEHMER ISO. Power pick-up assembly, insulated | 00614021 | 008 |
| 34 | KONTAKTFEDER F.89 U.64 Contact spring | 00614914 | 002 |
| 35 | LAMPENFASSUNG 4061/4062/4063 Lamp socket | 00624064 | 012 |
| 36 | ENTSTOERDROSSEL Suppressor choke | 00644101 | 007 |
| 37 | KONTAKTPILZGARNITUR L:17,5 MM Contacter pin assembly | 00644406 | 011 |

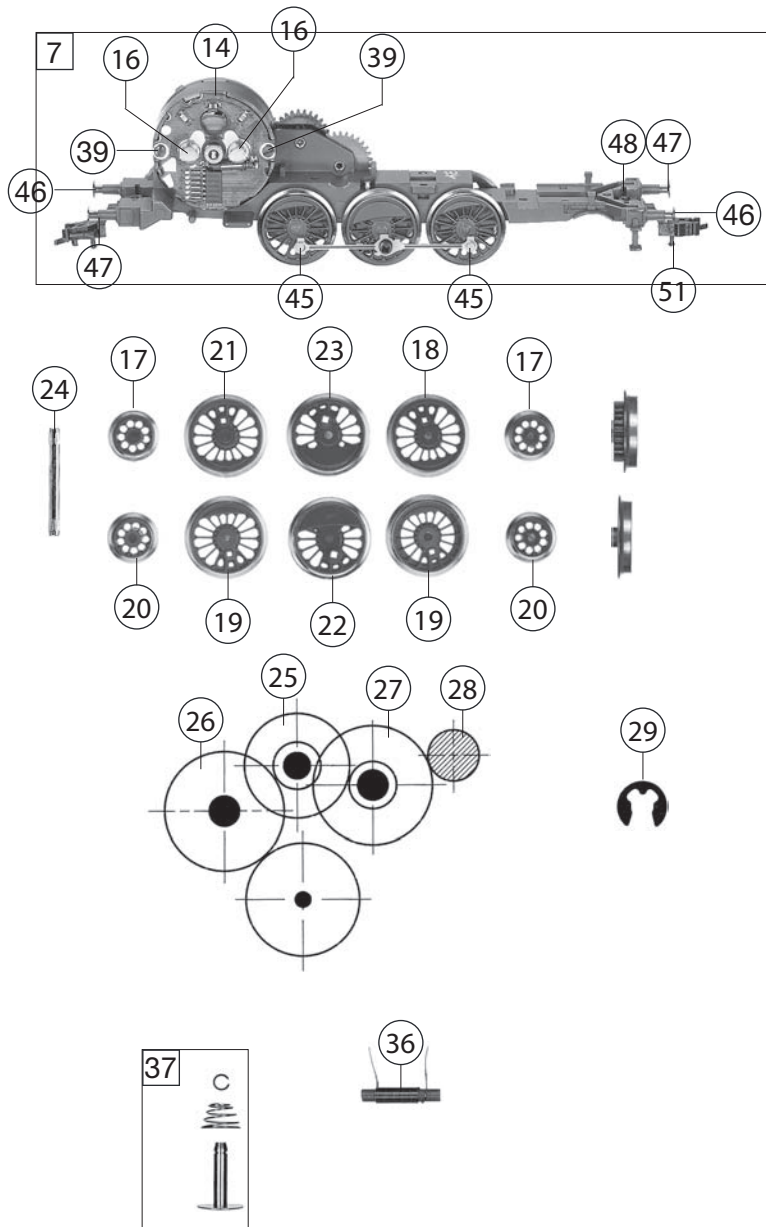

| 406401 | | BR 064 DB | 064355-1 | = | H0 |
|---------------------|--|---------------------|------------------------------|---|----|
| Pos. Nr. Pos.no. | Beschreibung Description | Art.-Nr. Art.no. | Preisgruppe Price bracket | | |
| 38 | SCHNITTST.-BLINDSTECKER 6-POL. Jumper, 6-pin | 00664002 | 013 | | |
| 39 | SCHRAUBE Screw | 00700313 | 001 | | |
| 40 | ZYLINDERKOPFSCHRAUBE Cylinder head screw | 00700403 | 001 | | |
| 41 | SCHRAUBE Screw | 00700405 | 001 | | |
| 42 | SCHRAUBE Screw | 00700408 | 001 | | |
| 43 | SCHRAUBE Screw | 00713516 | 001 | | |
| 44 | SPLINT F. SCHLITZKPPL Split pin for coupling adaptor | 00730503 | 001 | | |
| 45 | BOLZEN F.KUPPELSTANGE Linkage pin for coupling rod | 00730569 | 001 | | |
| 46 | Steckpuffer Plug-in buffer, curved | 00754006 | 002 | | |
| 47 | STECK-PUFFER FLACH Plug-in buffer, flat | 00754015 | 002 | | |
| 48 | BLATTRICHTFEDER L=14 MM Flat spring l=14mm | 00764012 | 002 | | |
| 49 | BLATTFEDER F.VORLAUFGEST Flat spring for carrying wheelset | 00764307 | 005 | | |
| 50 | DRUCKFEDER F.LOKRADSATZ Pressure spring for loco wheelset | 00764310 | 001 | | |
| 51 | PROFI-SCHLITZKUPPLUNG Profi slot coupling | 6516 | --- | | |
| | ERSATZ-SCHLEIFKOHLEN (o. Abb.) Carbon brushes set (w/o illustration) | 6519 | --- | | |
| | Fleischmann Schlitz-Kupplung (o. Abb.) Fleischmann slot coupling (w/o illustr.) | 6520 | --- | | |
| | STANDARD Schlitzkupplung (o. Abb.) STANDARD slot coupling (w/o illustr.) | 6523 | --- | | |
| 55 | ERS.-GLÜHLAMPE M.SCHRAUBFAS. Spare bulb with screw base | 00006530 | 007 | | |