

14

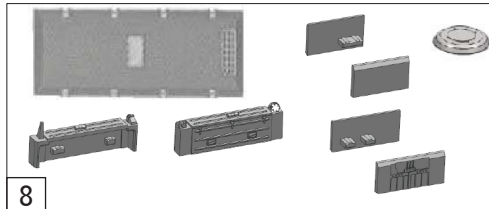

8

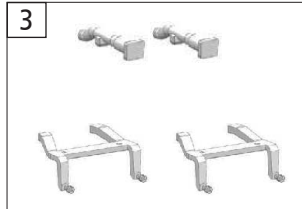

3

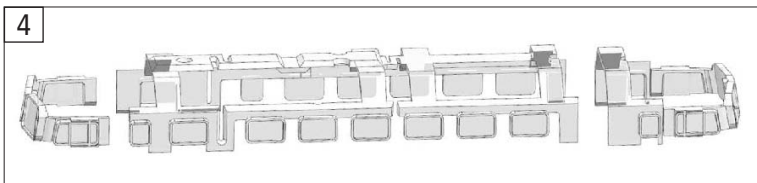

4

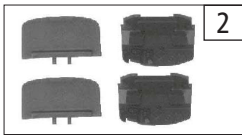

2

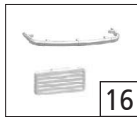

16

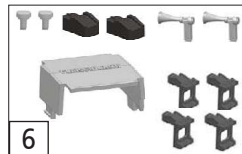

6



17

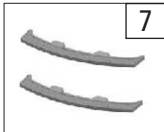

7

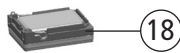

18

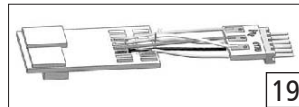

19



13

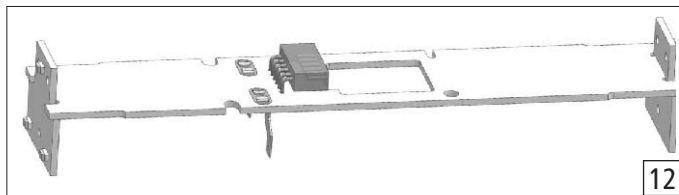

12

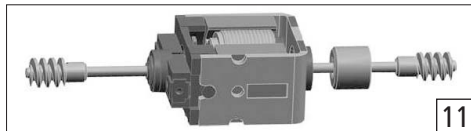

11

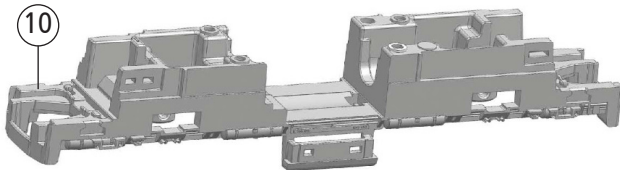

10



15

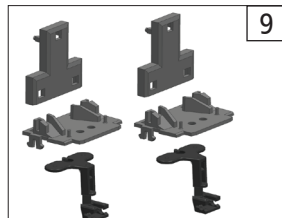

9

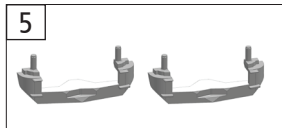

5

Pos. Nr. Pos.no.	Beschreibung Description	Art.-Nr. Art.no.	Preisgruppe Price bracket
725210	RZD M62	=	N
725290		=	N
1	GEHÄUSE KPL. Betr. Nr. M62-1675 Body assembly Loco no. M62-1675	145270	035
2	HIMMEL-FÜHRERSTAND-SATZ Part set for drivers cab	12725201	019
3	LICHT-LICHTLEITER-SATZ Part set - light, light guide	13725201	011
4	TS - FENSTER Part set - Windows	145271	016
5	TS - SCHÜRZEN Part set - Skirt	145272	008
6	TS-TREPPE-KONSOLE-MAKROFON Part set - Stairs,bracket,makrofon	18725206	011
7	TS-UMLAUF Part set - Running board	145273	008
8	TS - DACHDECKEL,TANKBEHÄLTER Part set - Roof cover,fuel tank	145274	011
9	DEICHSEL,DEICHSELABD.,LED MASKE Drawbar,drawbar cover,LED mask	145275	019
10	GRUNDRAHMEN Main frame	40725206	023
11	MOTOR KPL. Motor complete	50725201	031
12	PLATINE KPL. PCB complete	65719300	020
13	GF-SCHRAUBE M1,6X5 GF-screw M1,6X5	70900013	001
14	PUFFER RUND Buffer round	75711300	002
15	DEICHSELFEDER Spring for rod	76702400	001
16	TS - GRIFFE,LÜFTERGITTER Part set - Handle,fan grill	145315	011
17	STECKER F. SCHNITTSTELLE Connector for interface	00664005	013
Sound			
18	LAUTSPRECHER Loudspeaker	68700300	016
19	SOUNDDECODER Sound decoder	68725271	041

Änderungen in Konstruktion und Ausführung vorbehalten
We reserve the right to change the construction and specification

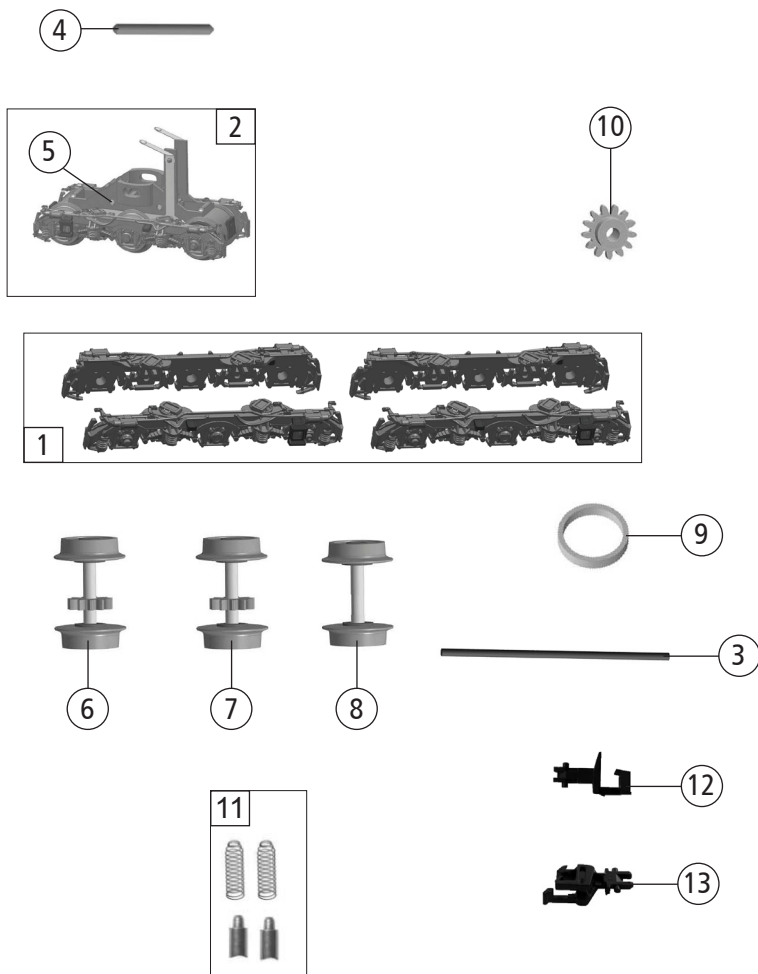

725210		RZD	M62	=		N
725290				=	🔊	N
Pos. Nr. Pos.no.	Beschreibung Description	Art.-Nr. Art.no.	Preisgruppe Price bracket			
1	TS-DREHGESTELLBLENDEN 1+2 Part set - Boogie frame 1+2	41725206	019			
2	DREHGESTELLBLOCK KPL. Bogie complete	45725206	017			
3	KUPPLUNGSHALTESTANGE Clutch retainer rod	38734501	009			
4	ACHSE Z. DG. BEFESTIGUNG Axle for bogie fastening	00527002	002			
5	ACHSE Axle	00527009	001			
6	RADSATZ KPL. MIT ZAHNRAD Wheelset complete with gear	53716100	013			
7	RADSATZ KPL. MIT ZAHNRAD Wheelset complete with gear	53716200	013			
8	RADSATZ KPL. Wheelset complete	53716300	014			
9	HAFTREIFEN Traction tyre	00547001	001			
10	ZAHNRAD Z:13 Gear Z:13	00567149	006			
11	SCHLEIFKOHLEN Carbon brushes	6518	---			
12	STANDARD-STECKKUPLUNG Standard coupling	9525	---			
13	PROFI-STECKKUPLUNG Profi coupling	9545	---			