

| 931891 Lokomotion BR 193 | | | | N |
|--------------------------|--|---------------------|------------------------------|---|
| Pos. Nr. Pos.no. | Beschreibung Description | Art.-Nr. Art.no. | Preisgruppe Price bracket | |
| 1 | GEHÄUSE KPL. Betr. Nr. 772-1 Body assembly complete Loco no.772-1 | 144841 | 037 | |
| 2 | FÜHRERSTAND SATZ Driver cabine set | 12739305 | 019 | |
| 3 | LICHTMASKE Light mask | 12739302 | 006 | |
| 4 | TS - FENSTER + LICHTLEITER Part set - Windows + light conductor | 144649 | 018 | |
| 5 | ZUGHAKEN-BREMSKUPPLUNG SATZ Coupling hook,break coupling set | 19733001 | 012 | |
| 6 | UMSCHALT.-VERTEILER-FLANSCH SATZ Switch-distributor flange set | 19739302 | 012 | |
| 7 | ISOLATOREN SATZ Set of isolators | 19739304 | 012 | |
| 8 | SIGNALHORN Signal horn | 19766300 | 011 | |
| 9 | DACHLEITUNG SATZ Roof wiring set | 19771800 | 011 | |
| 10 | ANTENNE SATZ Antenna set | 19771700 | 006 | |
| 11 | TRITT Treadle | 19771600 | 006 | |
| 12 | SCHIENENRÄUMER SATZ Rail guard set | 22739313 | 012 | |
| 13 | TRAFOWANNE Transformer tub | 33739305 | 012 | |
| 14 | KUKU-DEICHSEL Short coupling reception | 00387006 | 005 | |
| 15 | ZAHNRAD Z:11 Gear wheel Z:11 | 56716100 | 003 | |
| 16 | PUFFER Buffer | 75715900 | 005 | |
| 17 | PUFFERBOHLE KPL. Buffer beam complete | 75739313 | 013 | |
| 18 | EINHOLMSTROMABN. M. LANGEM SCH. Single arm panto with long contact shoe | 67703800 | 022 | |
| 19 | EINHOLMSTROMABN. M. KURZEM SCH. Single arm panto with short cont. shoe | 67703900 | 021 | |
| 20 | EINHOLMSTROMABN. M. KURZEM SCH. Single arm panto with short cont. shoe | 67708700 | 021 | |

Änderungen in Konstruktion und Ausführung vorbehalten
We reserve the right to change the construction and specification

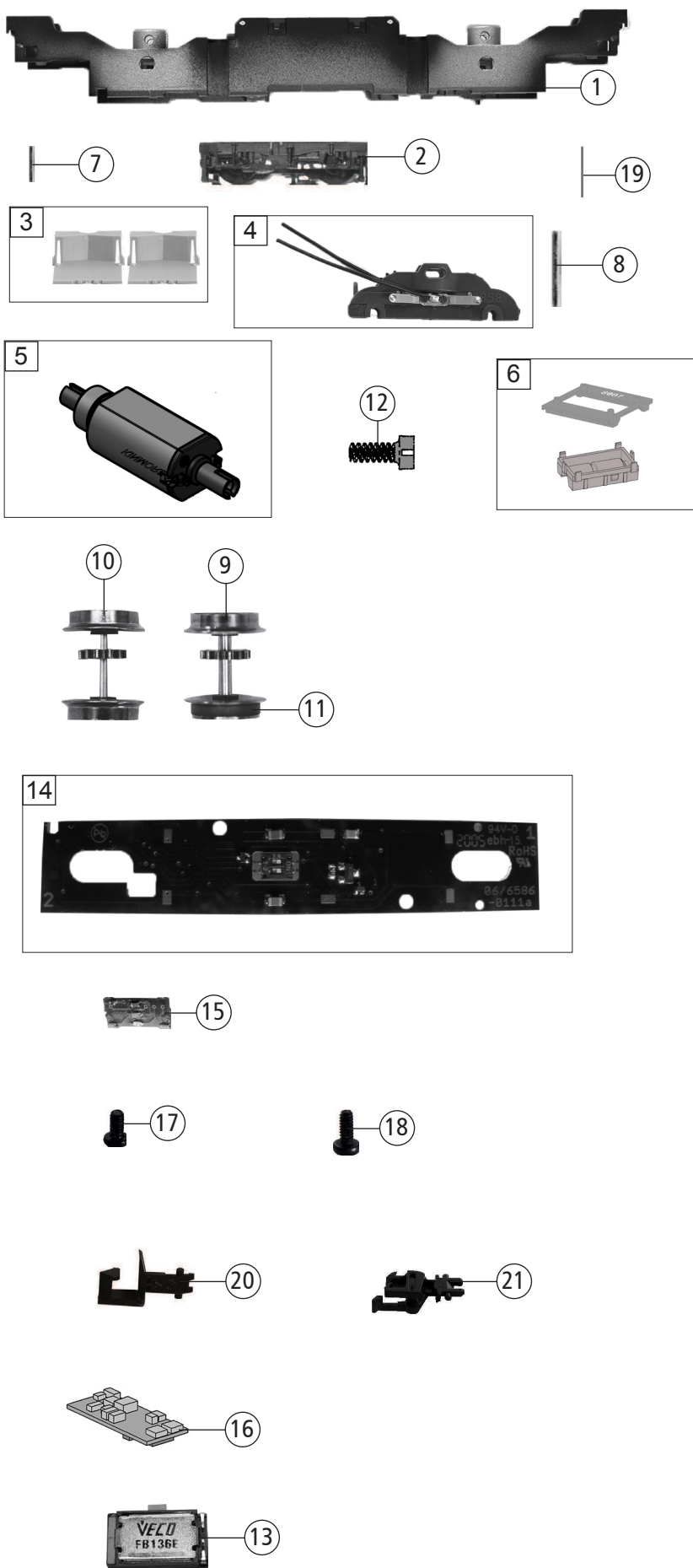

| 931891 Lokomotion BR 193 | | 🔊 | ⚖️ | N |
|--------------------------|---|---------------------|------------------------------|---|
| Pos. Nr. Pos.no. | Beschreibung Description | Art.-Nr. Art.no. | Preisgruppe Price bracket | |
| 1 | GRUNDRAHMEN Basic frame | 40739305 | 019 | |
| 2 | DREHGESTELLRAHMEN SATZ Bogie framework set | 41739313 | 011 | |
| 3 | DEICHSELABDECKUNG SATZ Shaft cover plate set | 43724501 | 009 | |
| 4 | DREHGESTELLBLOCK KPL. Bogie block complete | 144842 | 018 | |
| 5 | MOTOR KPL. Motor complete | 144448 | 028 | |
| 6 | TS - MOTORDISTANZPLATE,LS. BOX Part set -Motor spacer,loudspeakerbox | 144468 | 006 | |
| 7 | ACHSE Axle | 00527009 | 001 | |
| 8 | ACHSE F. DREHGESTELBEFESTIGUN Bogie fixation pin | 00527010 | 001 | |
| 9 | RADSATZ KPL. MIT ZAHNRAD M. 1H. Wheelset compl. w.gear whe. w. 1 tr.tyre | 144465 | 012 | |
| 10 | RADSATZ KPL. MIT ZAHNRAD OHNE H. Wheelset compl. w.gear whe. w/o tr.tyre | 144466 | 011 | |
| 11 | HAFTREIFEN Traction tyre | 00547002 | 001 | |
| 12 | SCHNECKE Worm gear | 00567601 | 007 | |
| 13 | LAUTSPRECHER Loudspeaker | 68701100 | 016 | |
| 14 | LEITERPLATTE KPL. OBEN Upper PCB complete | 144653 | 020 | |
| 15 | LED-PLATINE LICHTWECHSEL LED-PCB with light alternation | 65723700 | 025 | |
| 16 | SOUNDDECODER Sound decoder | 68739375 | 034 | |
| 17 | LINSENSCHRAUBE M 1,2 X 3 H Button screw M 1,2 X 3 H | 70900005 | 002 | |
| 18 | SCHRAUBE M 1,6 X 4 H Screw M 1,6 X 4 H | 70900006 | 002 | |
| 19 | RICHTFEDER F.DEICHSEL Straightening spring f. drawbar | 00767008 | 001 | |
| 20 | STANDARD-STECKKUPPLUNG Clip-in coupling | 9525 | --- | |
| 21 | PROFI STECKKUPPLUNG Profi coupling | 9545 | --- | |