

Pos. Nr. Pos.no.	Beschreibung Description	Art.-Nr. Art.no.	Preisgruppe Price bracket
1	Gehäuse kpl. f.Triebwagen m.Mo Motor coach body	10447102	---
2	DACH KPL.O.PANTO.4470 TK Roof, complete, for motor coach	00124470	33
3	LICHTLEITER-SATZ Light conductor set	00134470	13
5	BESCHWERUNG Ballast	00164438	16
6	HALTETRAVERSE-SATZ Pantograph isolator set	00174470	12
8	WAGENBODEN F.4471 M.MOT. Floor plate for motor coach	00304471	17
9	BUEGEL F.INNENBELEUCHTUNG Illumination contact plate	00354430	9
10	KUPPLUNGSADAPTER Coupling adaptor	00384001	6
12	DREHGESTELLRAHMEN Bogie framework	00414470	11
13	ANTRIEBSRAHMEN M.LOKFUEH Interior fitting/bogie reception with driver	00454470	20
14	DREHGEST.RAHMEN F.TRIEBW.M.MOT Rear bogie for motor coach	00471471	14
15	MOTOR Motor with flywheel	50447102	---
16	ANKER KPL.M.SCHWUNGMASSE Rotor with integrated flywheel, complete	00504607	25
17	LAGERSCHILD Motor PCB, insulated	50474400	---
18	KOHLLENROHRKAPPE Brush pipe cap	00504801	2
21	L.RAD M.Z.M.N.ISO. Loco wheel with gear, with trac. tyre, insulated	00514259	7
20	L.RAD O.Z.M.N.ISOL Loco wheel w/o gear, with trac. tyre, insulated	00514260	7
19	L.RAD O.Z.O.N.ISO. Loco wheel w/o gear, w/o trac. tyre, insulated	00514261	7
22	L.RAD M.Z.O.N.ISO. Loco wheel with gear, w/o trac. tyre	00514262	7
23	ACHSE GERAENDELT 20 MM Milled axle, 20mm	00524006	2
25	HAFTREIFEN HO Traction tyre	00544007	1
26	UNTERSETZUNGSRAD Z:28/13 SCHWA Reduction gear wheel Z:28/13, black	00564102	2
27	ZWISCHENRAD Z:18 SCHWARZ Gear wheel Z:18, black	00564105	2
28	ZWISCHENRAD Z:13 SCHWARZ Gear wheel Z:13, black	00564106	2
29	UNTERSETZUNGSRAD Z:32/13 SCHWA Reduction gear wheel Z:32/13, black	00564107	2
30	RITZEL Z:10 Gear wheel Z:10	00564602	4
31	SICHERUNGSRING KLEIN Securing ring, small	00564701	1
32	SICHERUNGSRING GROSS Securing ring, big	00564702	1
	UNTERLEGSCH. 2,3 X 5 X 0,1 (o. Abb.) Washer (w/o illustr.)	00564747	1
	UNTERLEGSCH.ROT 2,2X5X0,3 (o. Abb.) Washer, red (w/o illustr.)	00564751	1
35	MOTORSTROMABNEHMER Motor contact clip	00614916	2
37	STROMABNEHMERFEDER Power pick-up spring	00614948	2
39	KONDENSATOR Capacitor	64420900	5
41	UMSCHALTER Switch	00644470	9
42	SCHALTPLATTE kpl.f.Triebw.m.Mo PCB for motor coach	65417100	---
44	EINHOLMSTROMABNEHMER Single arm pantograph	67433200	18
	DCC-DECODER ZIMO MX630 (o. Abb.) DCC-decoder ZIMO MX630 (w/o illustr.)	68397102	---

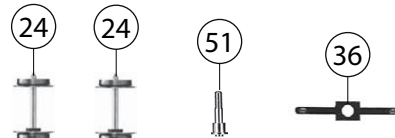
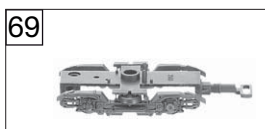
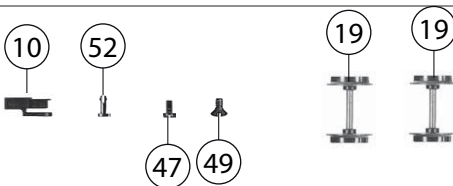
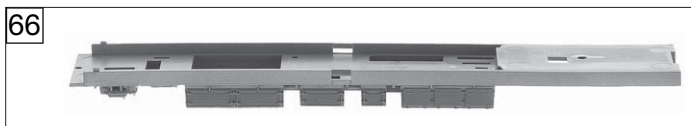
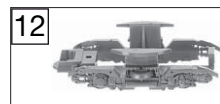
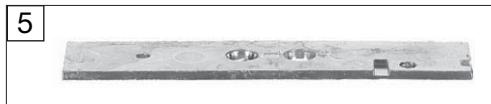
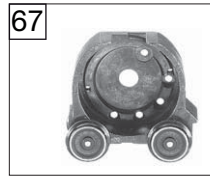
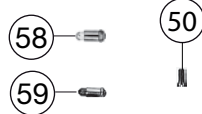
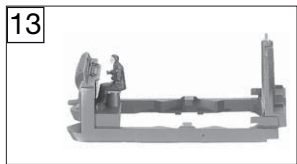
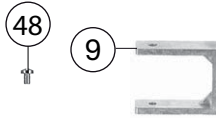
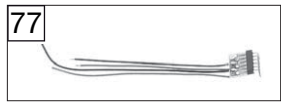
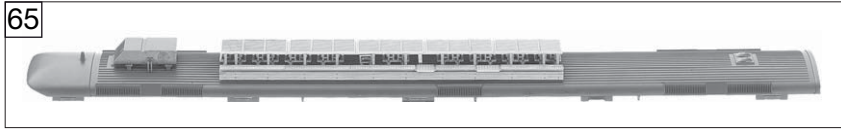
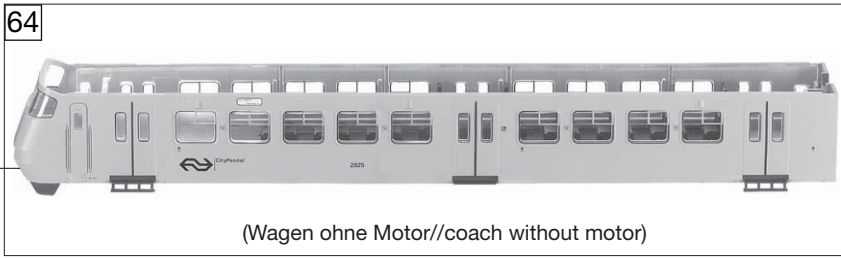

36	BELEUCHTUNGSFEDER H0 Light contact spring H0	00614919	002
76	SCHALTPLATTE F.4471 O.MOTOR PCB for non-motorized coach	65417200	---
77	STECKER 6-POL.M.4 LITZEN 4471 6-pin plug with 4 cables	00654085	020

397102	Strand-Sprinter NS	2026	~	HO
Pos. Nr. Pos.no.	Beschreibung Description	Art.-Nr. Art.no.	Preisgruppe Price bracket	
34	SCHLEIFER Center pick-up	69202800	---	
45	SCHRAUBE Screw	00700307	1	
46	SCHRAUBE Screw	00700313	1	
47	SCHRAUBE Screw	00700404	1	
48	SCHRAUBE Screw	00700604	1	
49	SCHRAUBE Screw	00702403	1	
50	SCHRAUBE Screw	00730003	1	
51	ZAPPENSCHRAUBE F.HO WAGEN Flanged bolt	00730027	2	
52	SPLINT F. KUPPLUNGSADAPT Split pin for coupling adaptor	00730525	1	
53	BLATTRICHTFEDER L=9,5MM Flat straightening spring l=9.5mm	00764007	1	
	Fleischmann- Steckkupplung (Lok) (o. Abb.) Fleischmann plug-in coupling (loco) (w/o illustr.)	6509	---	
	Standard- Steckkupplung (o. Abb.) Standard- coupling (w/o illustration)	6511	---	
	PROFI-STECKKUPPLUNG (o. Abb.) Profi coupling (w/o illustration)	6515	---	
	ERSATZ-SCHLEIFKOHLEN (o. Abb.) Carbon brushes (w/o illustr.)	6519	---	
58	ERS.-GLUEHLAMPE KLAR M.STECKFA Replacement bulb, clear, with plug-in socket	00006535	8	
24	AUSTAUSCH-RADSATZ 25 MM Exchange wheelset 25mm	6561	---	
59	ERS.-GLUEHLAMPE ROT M.STECKFSS Replacement bulb, red, with plug-in socket	00009531	9	

3	LICHTLEITER-SATZ Light conductor set for non-motor coach	00134470	13
5	BESCHWERUNG Ballast	00164438	16
64	GEHÄUSE KPL.FÜR TRIEBWAGEN OHN Non-motorized coach body	20447102	---
65	DACH F. TRIEBW.O.MOTOR Roof for non-motorized coach body	00224470	20
66	WAGENBODEN F.4471 O.MOT. Floor plate for non-motorized coach body	00304470	18
67	MOTORDREHGESTELLBL.O.M. Motor bogie block	00311438	21
9	BUEGEL F.INNENBELEUCHTUNG Illumination contact plate	00354430	9
69	DREHGEST.RAHMEN M.KONT.4471-3 Bogie framework with contacts	00374471	12
10	KUPPLUNGSADAPTER Coupling adaptor	00384001	6
12	DREHGESTELLRAHMEN Bogie framework (front)	00414470	11
13	ANTRIEBSRAHMEN M.LOKFUEH Interior fitting/bogie reception with driver	00454470	20
19	L.RAD O.Z.O.N.ISO. Loco wheel w/o gear, w/o. trac. tyre, insulated	00514261	7