

408605		BR 86 DR	861590-8	=	H0
Pos. Nr. Pos. no.	Beschreibung Description		Art.-Nr. Art. no.	Preisgruppe Price bracket	
1	LOKGEHAEUSE BR 86 DR Body assembly complete		10408605	037	
2	LICHTLEITER-SATZ F.4087 Light conductor set		00134087	009	
3	AUFSTIEGSTRITT / SATZ F.4086 Set of ladders		00154086	012	
	HANDRAD (o. Abb.) Hand wheel (w/o illustration)		00194707	003	
4	GRIFFSTANGEN F.BR 86 Hand-rail -set		00194713	002	
5	KUPPLUNGSHAKEN (o.Abb.) Coupling hook (w/o illustration)		00194824	002	
6	LEITER TENDERSEITE F.4086 Rear ladder		00194832	002	
7	SCHIENENRAEUMER Rail guard		00224130	007	
8	LOKFAHRGESTELL KPL. M.SCHNITTS Chassis complete with interface		40408605	047	
9	LOKFAHRGEST.M.GETR.U.RAEDERN Loco chassis with gearset and wheels		41408671	040	
10	STEUERUNG NEU BR 86 Reversing gear complete (new)		42408671	031	
11	ZYLINDERKASTEN - SATZ Cylinder box		00434086	012	
12	RAUCHKAMMERTRAEGER F.4087 Smoke box support		00454087	014	
13	DREHGESTELL Bogie		00470086	016	
14	DEICHELSELFUEHRUNG-VORN M.PUFF. Front framework with buffers		47408605	018	
15	DREHGEST.FUEHRUNG-HINT.F.4087 Rear framework with buffers		00494087	017	
16	ANKER KPL.M.SCHWUNGMASSE Rotor complete with integr. flywheel		00504607	025	
17	LAGERSCHILD ISOL.F.BR 78 U.86 Motor PCB insulated		00504733	017	
18	KOHLENROHRKAPPE Brush pipe cap		00504801	002	
19	LOKRAD GR.GEGENGEW. Loco wheel (big counterweight)		00514322	008	
20	TREIBRAD RECHTS ISOL.F BR 86 Right driving wheel, insulated		00514323	009	
21	LOKRAD KL.GEGENGEW. Loco wheel (small counterweight)		00514324	008	
22	LOKRAD KL.GEGENGEW. Loco wheel (small counterweight)		00514325	009	
23	KUPPELRAD LINKS M.N.F. BR 86 Left coupled wheel with traction tyre		00514326	008	
24	LOKRAD KL.GEGENGEW. M.N. Loco wheel (small counterweight) with trac. tyre		00514327	009	
25	ACHSE 10 MM Axle 10mm		00524002	002	
26	ACHSE GERAENDELT 20 MM Milled axle 20mm		00524006	002	
27	ACHSE Axle		00524008	005	
28	VORLAUFRADSATZ BR 03,86,56 Carrying wheelset complete		00534047	012	
29	HAFTREIFEN H0 Traction tyre H0		00544006	001	
30	ZAHNRAD Z:23 MS F.4086/87 Brass gear wheel Z:23		00564155	008	
31	UNTERSETZUNGSRAD Z:24/12 BR 86 Reduction gear wheel Z:24/12		00564156	006	
32	UNTERSETZUNGSRAD Z:24/12 SCHWA Reduction gear wheel Z:24/12, black		00564157	006	
33	UNTERSETZUNGSRAD Z:32/25 SCHWA Reduction gear wheel Z:32/25, black		00564158	006	
34	RITZEL Z:9 F. 4086/87 Gear wheel Z:9		00564608	007	
35	SICHERUNGSRING F.BR 78/86 Securing ring		00564704	001	

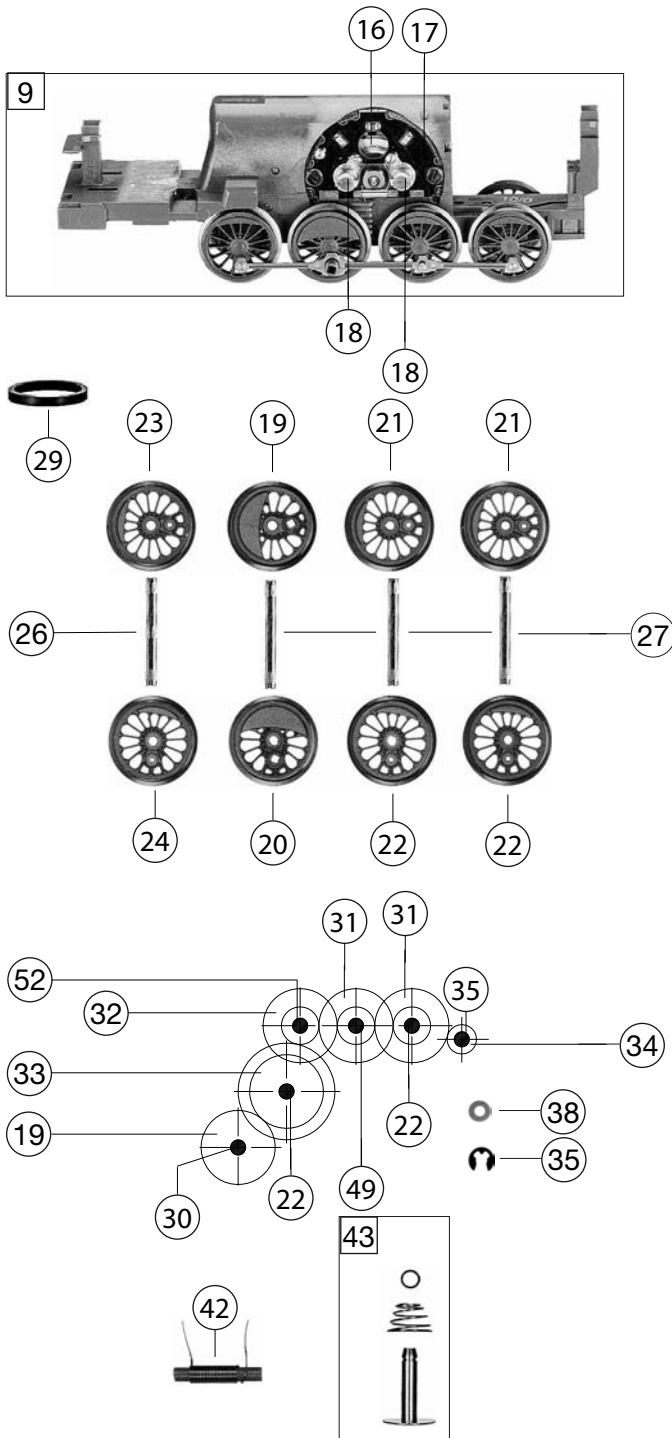

408605		BR 86 DR	861590-8	=	HO
Pos. Nr. Pos.no.	Beschreibung Description	Art.-Nr. Art.no.	Preisgruppe Price bracket		
36	UNTERLEGSCH. 2,3 X 5 X 0,1 (o. Abb.) Washer for rotor (w/o illustration)	00564747	001		
37	UNTERLEGSCH. ROT 2,2X5X0,3 (o. Abb.) Washer for rotor, red (w/o illustration)	00564751	001		
38	UNTERLEGSCH. F. 4086 Washer	00564753	001		
39	DISTANZRING (o. Abb.) Spacer ring for reversing gear (w/o illustration)	00564775	002		
40	STROMABNEHMEREINS. BR 86 SCHN.S Power pick-up assembly	00604088	016		
41	LAMPENKONT.-HALTER BR 86 SS Lamp support complete	00634088	009		
42	ENTSTOERDROSSEL Suppressor choke	00644101	007		
43	KONTAKTPILZGARNITUR L:11,5 MM Contacter pin assembly	00644403	011		
44	BUCHSENLEISTE 6-POL.F.SCHNITT. Connector interface, 6-pin	00654073	014		
45	SCHNITTST.-BLINDSTECKER 6-POL. Jumper, 6-pin	00664002	013		
46	SCHRAUBE Screw	00700313	001		
47	SCHRAUBE Screw	00700404	001		
48	SCHRAUBE F.GEHAEUSE Body fixation screw	00712516	001		
49	ZYLINDERSTIFT F. ZAHNRAD Cylinder pin for gear wheel	00730519	002		
50	GESTÄNGEBOLZEN SCHW.VERN. Linkage pin; nickel-plated, black	00730553	002		
51	GEST.BOLZEN F.4.RS BR 41 Linkage pin for 4th wheelset	00730554	002		
52	BOLZEN F.ZAHNRAD Bolt for gear wheel	00730547	002		
53	Steckpuffer Plug-in buffer, curved	00754006	002		
54	STECK-PUFFER FLACH Plug-in buffer, flat	00754015	002		
55	DRAHTRICHTFEDER L=27 MM (o. Abb.) Thread straightening spring L=27mm (w/o illust.)	00764016	002		
56	ANDRUCKFEDER F.RADSATZ 4086 Pressure spring for wheelset	00764316	001		
	FLEISCHMANN KUPPLUNG Fleischmann coupling	6510	---		
	STECK-TAUSCHKUPPLUNG Standard coupling	6511	---		
	PROFI-STECKKUPPLUNG Profi coupling	6515	---		
	ERSATZ-SCHLEIFKOHLEN Carbon brushes set	6519	---		
61	ERS.-GLUEHLAMPE KLAR M.STECKFA Replacement bulb clear with plug-in socket	00006535	008		