

| 408606              |  | BR 86 DB | 86780               | =                            | H0 |
|---------------------|--|----------|---------------------|------------------------------|----|
| Pos. Nr.<br>Pos.no. | Beschreibung<br>Description  |          | Art.-Nr.<br>Art.no. | Preisgruppe<br>Price bracket |    |
| 1                   | LOKGEHAEUSE BR 86 DB<br>Body assembly complete                               |          | 10408606            | 037                          |    |
| 2                   | LICHTLEITER-SATZ<br>Light conductor set                                      |          | 00134086            | 011                          |    |
| 3                   | AUFSTIEGSTRITT / SATZ F.4086<br>Set of ladders                               |          | 00154086            | 012                          |    |
| 4                   | GRIFFSTANGEN F.BR 86<br>Hand-rail -set                                       |          | 00194713            | 002                          |    |
| 5                   | KUPPLUNGSHAKEN (o.Abb.)<br>Coupling hook (w/o illustration)                  |          | 00194824            | 002                          |    |
| 6                   | LEITER TENDERSEITE F.4086<br>Rear ladder                                     |          | 00194832            | 002                          |    |
| 7                   | SCHIENENRAEUMER<br>Rail guard  |          | 00224130            | 007                          |    |
| 8                   | LOKFAHRGESTELL M.MOTOR S KPL.<br>Chassis complete with interface             |          | 40408606            | 047                          |    |
| 9                   | LOKFAHRGE.M.GETR.U.RAEDERN<br>Loco chassis with gearset and wheels           |          | 41408601            | 040                          |    |
| 10                  | STEUERUNG NEU BR 86<br>Reversing gear complete (new)                         |          | 42408671            | 031                          |    |
| 11                  | ZYLINDERKASTEN - SATZ<br>Cylinder box  |          | 00434086            | 012                          |    |
| 12                  | RAUCHKAMMERTRAEGER<br>Smoke box support                                      |          | 00454086            | 014                          |    |
| 13                  | DREHGESTELL M.SCHEIBEN-RS 4088<br>Bogie with disc wheelset                   |          | 04740881            | 014                          |    |
| 14                  | DEICHSELFUEHRUNG-VORN M.PUFF.<br>Front framework with buffers                |          | 47408606            | 018                          |    |
| 15                  | DEICHSEL-FUEHRUNG HINT.F.4088<br>Rear framework with buffers                 |          | 00494088            | 017                          |    |
| 16                  | ANKER KPL.M.SCHWUNGMASSE<br>Rotor complete with integr. flywheel             |          | 00504607            | 025                          |    |
| 17                  | LAGERSCHILD ISOLF.BR 78 U.86<br>Motor PCB insulated                          |          | 00504733            | 017                          |    |
| 18                  | KOHLENROHRKAPPE<br>Brush pipe cap  |          | 00504801            | 002                          |    |
| 19                  | LOKRAD GR.GEGENGEW.<br>Loco wheel (big counterweight)                        |          | 00514322            | 008                          |    |
| 20                  | TREIBRAD RECHTS ISOLF.BR 86<br>Right driving wheel, insulated                |          | 00514323            | 009                          |    |
| 21                  | LOKRAD KL.GEGENGEW.<br>Loco wheel (small counterweight)                      |          | 00514324            | 008                          |    |
| 22                  | LOKRAD KL.GEGENGEW.<br>Loco wheel (small counterweight)                      |          | 00514325            | 009                          |    |
| 23                  | KUPPELRAD LINKS M.N.F. BR 86<br>Left coupled wheel with traction tyre        |          | 00514326            | 008                          |    |
| 24                  | LOKRAD KL.GEGENGEW. M.N.<br>Loco wheel (small counterweight) with trac. tyre |          | 00514327            | 009                          |    |
| 25                  | ACHSE 10 MM<br>Axle 10mm   |          | 00524002            | 002                          |    |
| 26                  | ACHSE GERAENDELT 20 MM<br>Milled axle 20mm                                   |          | 00524006            | 002                          |    |
| 27                  | ACHSE<br>Axle  |          | 00524008            | 005                          |    |
| 28                  | SCHEIB.VORLAUFRADS.F.4088,DRG<br>Disc wheelset                               |          | 00534079            | 011                          |    |
| 29                  | HAFTREIFEN H0<br>Traction tyre H0  |          | 00544006            | 001                          |    |
| 30                  | ZAHNRAD Z:23 MS F.4086/87<br>Brass gear wheel Z:23                           |          | 00564155            | 008                          |    |
| 31                  | UNTERSETZUNGSRAD Z:24/12 BR 86<br>Reduction gear wheel Z:24/12               |          | 00564156            | 006                          |    |
| 32                  | UNTERSETZUNGSRAD Z:24/12 SCHWA<br>Reduction gear wheel Z:24/12, black        |          | 00564157            | 006                          |    |
| 33                  | UNTERSETZUNGSRAD Z:32/25 SCHWA<br>Reduction gear wheel Z:32/25, black        |          | 00564158            | 006                          |    |
| 34                  | RITZEL Z:9 F. 4086/87<br>Gear wheel Z:9                                      |          | 00564608            | 007                          |    |
| 35                  | SICHERUNGSRING F.BR 78/86<br>Securing ring                                   |          | 00564704            | 001                          |    |

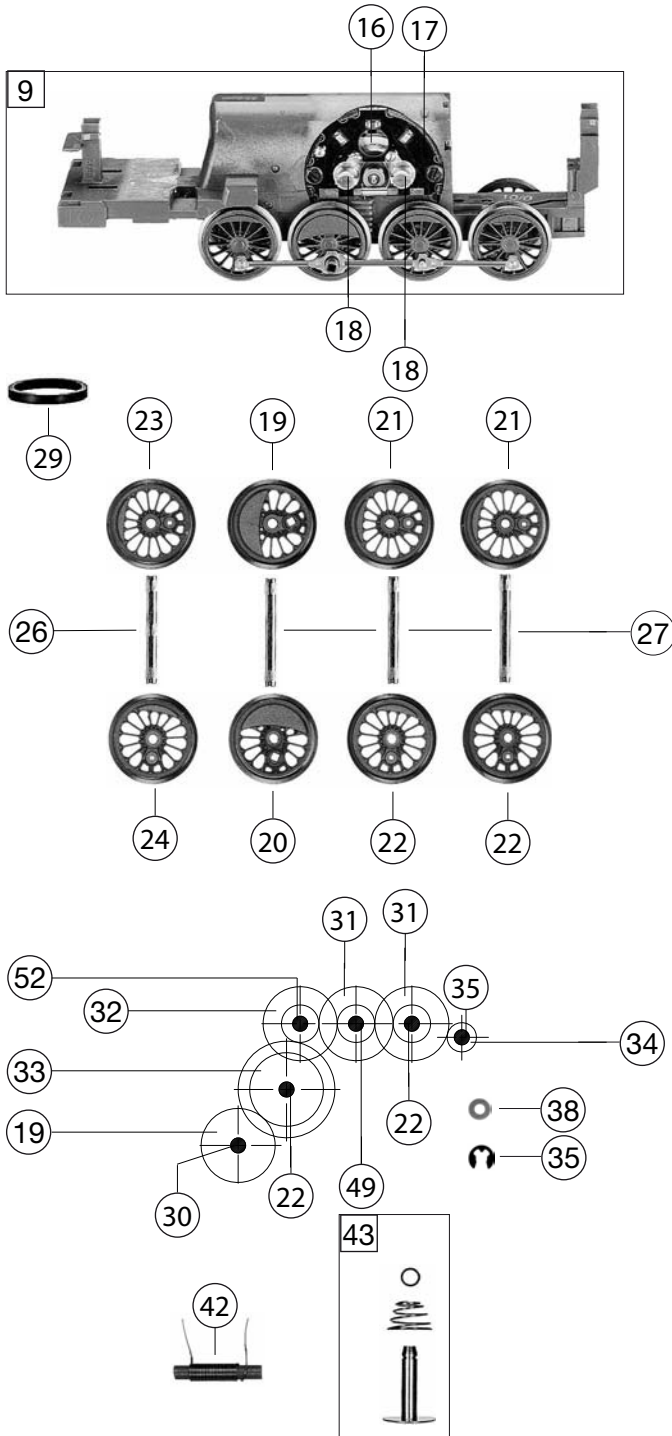

| 408606              |   | BR 86 DB            | 86780                        | = | HO |
|---------------------|---|---------------------|------------------------------|---|----|
| Pos. Nr.<br>Pos.no. | Beschreibung<br>Description   | Art.-Nr.<br>Art.no. | Preisgruppe<br>Price bracket |   |    |
| 36                  | UNTERLEGSCH. 2,3 X 5 X 0,1 (o.Abb.)<br>Washer for rotor (w/o illustration)            | 00564747            | 001                          |   |    |
| 37                  | UNTERLEGSCH. ROT 2,2X5X0,3 (o.Abb.)<br>Washer for rotor, red (w/o illustration)       | 00564751            | 001                          |   |    |
| 38                  | UNTERLEGSCH. F. 4086<br>Washer  | 00564753            | 001                          |   |    |
| 39                  | DISTANZRING (o.Abb.)<br>Spacer ring for reversing gear (w/o illustration)             | 00564775            | 002                          |   |    |
| 40                  | STROMABNEHMEREINS. BR 86 SCHN.S<br>Power pick-up assembly                             | 00604088            | 016                          |   |    |
| 41                  | LAMPENKONT.-HALTER BR 86 SS<br>Lamp support complete                                  | 00634088            | 009                          |   |    |
| 42                  | ENTSTOERDROSSEL<br>Suppressor choke   | 00644101            | 007                          |   |    |
| 43                  | KONTAKTPILZGARNITUR L:11,5 MM<br>Contacter pin assembly                               | 00644403            | 011                          |   |    |
| 44                  | BUCHSENLEISTE 6-POL.F.SCHNITT.<br>Connector interface, 6-pin                          | 00654073            | 014                          |   |    |
| 45                  | SCHNITTST.-BLINDSTECKER 6-POL.<br>Jumper, 6-pin                                       | 00664002            | 013                          |   |    |
| 46                  | SCHRAUBE<br>Screw   | 00700313            | 001                          |   |    |
| 47                  | SCHRAUBE<br>Screw   | 00700404            | 001                          |   |    |
| 48                  | SCHRAUBE F.GEHAEUSE<br>Body fixation screw  | 00712516            | 001                          |   |    |
| 49                  | ZYLINDERSTIFT F. ZAHNRAD<br>Cylinder pin for gear wheel                               | 00730519            | 002                          |   |    |
| 50                  | GESTÄNGEBOLZEN SCHW.VERN.<br>Linkage pin; nickel-plated, black                        | 00730553            | 002                          |   |    |
| 51                  | GEST.BOLZEN F.4.RS BR 41<br>Linkage pin for 4th wheelset                              | 00730554            | 002                          |   |    |
| 52                  | BOLZEN F.ZAHNRAD<br>Bolt for gear wheel   | 00730547            | 002                          |   |    |
| 53                  | STECKPUFFER GEWÖL.M.WEIB.RING<br>Plug-in buffer, curved, with white ring              | 00754040            | 006                          |   |    |
| 54                  | STECKPUFFER FLACH.M.WEIB.RING<br>Plug-in buffer, flat, with white ring                | 00754041            | 006                          |   |    |
| 55                  | DRAHTRICHTFEDER L=27 MM (o. Abb.)<br>Thread straightening spring L=27mm (w/o illust.) | 00764016            | 002                          |   |    |
| 56                  | ANDRUCKFEDER F.RADSATZ 4086<br>Pressure spring for wheelset                           | 00764316            | 001                          |   |    |
|                     | FLEISCHMANN KUPPLUNG<br>Fleischmann coupling  | 6510                | ---                          |   |    |
|                     | STECK-TAUSCHKUPPLUNG<br>Standard coupling   | 6511                | ---                          |   |    |
|                     | PROFI-STECKKUPPLUNG<br>Profi coupling   | 6515                | ---                          |   |    |
|                     | ERSATZ-SCHLEIFKOHLEN<br>Carbon brushes set  | 6519                | ---                          |   |    |
| 61                  | ERS.-GLUEHLAMPE KLAR M.STECKFA<br>Replacement bulb clear with plug-in socket          | 00006535            | 008                          |   |    |