

| 408677 BR 86 ÖBB 86 452 |  | =                   | 🔊                            | H0 |
|-------------------------|--|---------------------|------------------------------|----|
| Pos. Nr.<br>Pos.no.     | Beschreibung<br>Description  | Art.-Nr.<br>Art.no. | Preisgruppe<br>Price bracket |    |
| 1                       | LOKGEHÄUSE KPL.<br>Body assembly complete                                    | 10408677            | 032                          |    |
| 2                       | LICHTLEITER-SATZ<br>Light conductor set                                      | 00134087            | 020                          |    |
| 3                       | AUFSTIEGSTRITT -SATZ<br>Set of ladders                                       | 15408677            | 012                          |    |
| 4                       | GRIFFSTANGE ROT<br>Handrail -set, red  | 19473400            | 011                          |    |
|                         | KUPPLUNGSHAKEN (o.Abb.)<br>Coupling hook (w/o illustration)                  | 00194824            | 024                          |    |
| 6                       | LEITER TENDERSEITE F.4086<br>Rear ladder                                     | 00194832            | 012                          |    |
| 7                       | SCHIENENRAEUMER F.408602<br>Rail guard                                       | 22408603            | 012                          |    |
| 8                       | LOKFAHRGESTELL KPL. MIT SCHNIT<br>Chassis complete with interface            | 40408677            | 013                          |    |
| 9                       | LOKFAHRGESTELL MIT MOTOR<br>Loco chassis with motor                          | 41408677            | 015                          |    |
| 10                      | STEUERUNG NEU BR 86<br>Reversing gear complete (new)                         | 42408671            | 002                          |    |
| 11                      | ZYLINDERKASTEN - SATZ<br>Cylinder box  | 00434086            | 022                          |    |
| 12                      | RAUCHKAMMERTRAEGER<br>Smoke box support                                      | 00454087            | 012                          |    |
| 14                      | DEICHSELFÜHRUNG VORN<br>Front framework                                      | 47408603            | 007                          |    |
| 13                      | DREHGESTELL KPL.(Speichenräder<br>Bogie complete (spoked wheels)             | 47408607            | 015                          |    |
| 13a                     | DREHGESTELL KPL.(Scheibenräder<br>Bogie complete (disc type wheels)          | 474086071           | 047                          |    |
| 15                      | DEICHSELFÜHRUNG HINTEN<br>Rear framework                                     | 49408603            | 035                          |    |
| 16                      | ANKER KPL.M.SCHWUNGMASSE<br>Rotor complete with integr. flywheel             | 00504607            | 013                          |    |
| 17                      | LAGERSCHILD KPL.<br>Motor PCB, insulated                                     | 50474300            | 009                          |    |
| 18                      | KOHLENROHRKAPPE<br>Brush pipe cap  | 00504801            | 015                          |    |
| 19                      | LOKRAD GR.GEGENGEW.<br>Loco wheel (big counterweight)                        | 00514322            | 006                          |    |
| 20                      | TREIBRAD RECHTS ISOLF BR 86<br>Right driving wheel, insulated                | 00514323            | 005                          |    |
| 21                      | LOKRAD KL.GEGENGEW.<br>Loco wheel (small counterweight)                      | 00514324            | 015                          |    |
| 22                      | LOKRAD KL.GEGENGEW.<br>Loco wheel (small counterweight)                      | 00514325            | 035                          |    |
| 23                      | KUPPELRAD LINKS M.N.F. BR 86<br>Left coupled wheel with traction tyre        | 00514326            | 017                          |    |
| 24                      | LOKRAD KL.GEGENGEW. M.N.<br>Loco wheel (small counterweight) with trac. tyre | 00514327            | 011                          |    |
| 25                      | ACHSE 10 MM<br>Axle 10mm   | 00524002            | 007                          |    |
| 26                      | ACHSE GERAENDELT 20 MM<br>Milled axle 20mm                                   | 00524006            | 025                          |    |
| 27                      | ACHSE<br>Axle  | 00524008            | 002                          |    |
| 28                      | SCHEIB.VORLAUFRADS.<br>Carrying wheelset, disc type                          | 00534079            | 006                          |    |
| 28a                     | RADSATZ KPL. GESTEMP.<br>Carrying wheelset, printed                          | 53428600            | 007                          |    |
| 29                      | HAFTREIFEN H0<br>Traction tyre H0  | 00544006            | 007                          |    |
| 30                      | ZAHNRAD Z:23 MS F.4086/87<br>Brass gear wheel Z:23                           | 00564155            | 007                          |    |
| 31                      | UNTERSETZUNGSRAD Z:24/12 BR 86<br>Reduction gear wheel Z:24/12               | 00564156            | 008                          |    |
| 32                      | UNTERSETZUNGSRAD Z:24/12 SCHWA<br>Reduction gear wheel Z:24/12, black        | 00564157            | 008                          |    |
| 33                      | UNTERSETZUNGSRAD Z:32/25 SCHWA<br>Reduction gear wheel Z:32/25, black        | 00564158            | 008                          |    |

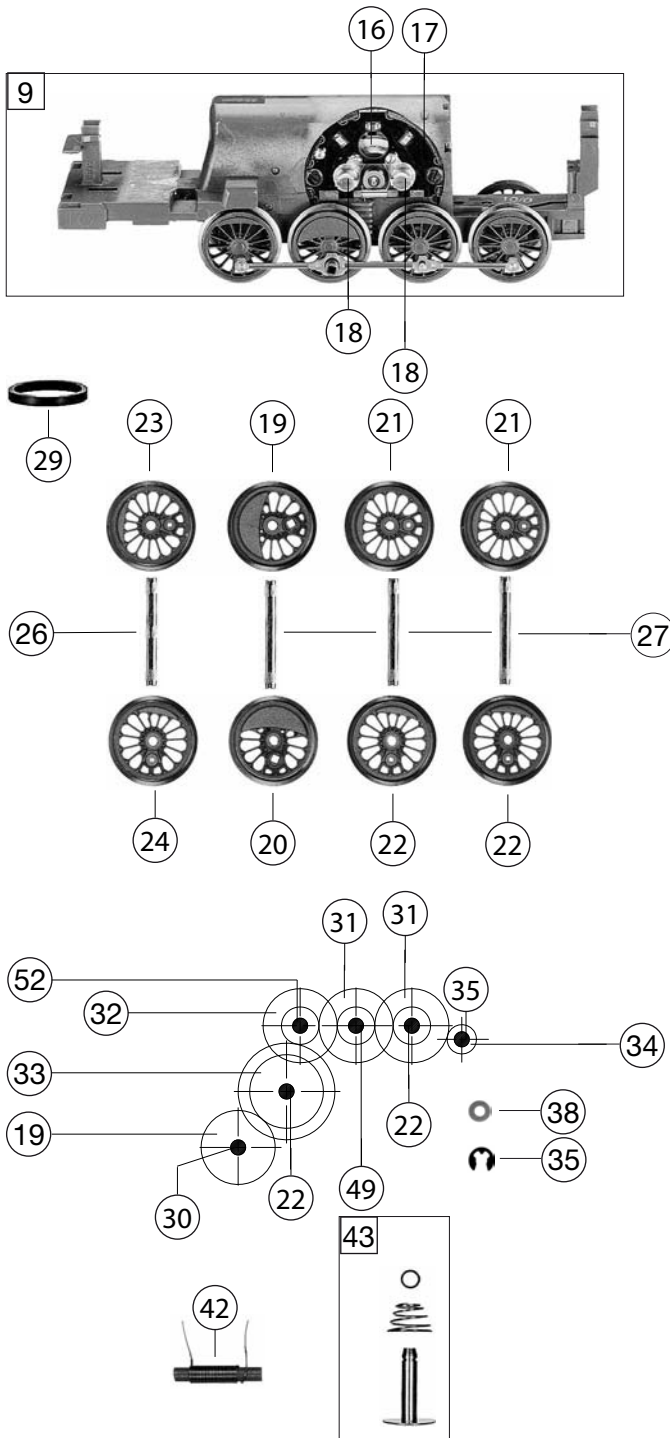

| 408677              |  | BR 86 ÖBB | 86 452              | =                            | 🔊 | HO |
|---------------------|--|-----------|---------------------|------------------------------|---|----|
| Pos. Nr.<br>Pos.no. | Beschreibung<br>Description  |           | Art.-Nr.<br>Art.no. | Preisgruppe<br>Price bracket |   |    |
| 34                  | RITZEL Z:9<br>Gear wheel Z:9   |           | 00564608            | 7                            |   |    |
| 35                  | SICHERUNGSRING F.BR 78/86<br>Securing ring   |           | 00564704            | 1                            |   |    |
|                     | UNTERLEGSCH. ROT 2,2X5X0,3 (o.Abb.)<br>Washer for rotor, red (w/o illustration)        |           | 00564747            | 1                            |   |    |
|                     | UNTERLEGSCH. ROT 2,2X5X0,3 (o.Abb.)<br>Washer for rotor, red (w/o illustration)        |           | 00564751            | 1                            |   |    |
| 38                  | UNTERLEGSCH. ROT 2,2X5X0,3 (o.Abb.)<br>Washer  |           | 00564753            | 1                            |   |    |
|                     | DISTANZRING (o.Abb.)<br>Spacer ring for reversing gear (w/o illustration)              |           | 00564775            | 2                            |   |    |
| 40                  | STROMABNEHMEREINS.BR 86 SCHN.S<br>Power pick-up assembly                               |           | 60408603            | 16                           |   |    |
|                     | HALTEPLATTE (o. Abb.)<br>Mounting plate (w/o illustr.)                                 |           | 62408671            | 12                           |   |    |
| 41                  | LAMPENKONTAKTHALTER<br>Lamp support complete   |           | 00631118            | 8                            |   |    |
| 42                  | ENTSTOERDROSSEL<br>Suppressor choke  |           | 00644101            | 7                            |   |    |
| 43                  | KONTAKTPILZGARNITUR L:11,5 MM<br>Contacter pin assembly                                |           | 00644403            | 11                           |   |    |
|                     | LAUTSPRECHER Ø 23 mm 8 Ohm (o. Abb.)<br>Loudspeaker (w/o illustr.)                     |           | 68400300            | 16                           |   |    |
|                     | SOUND-DECODER (o. Abb.)<br>Sound decoder (w/o illustr.)                                |           | 68408677            | ---                          |   |    |
| 46                  | SCHRAUBE<br>Screw  |           | 00700313            | 1                            |   |    |
| 47                  | SCHRAUBE<br>Screw  |           | 00700404            | 1                            |   |    |
| 48                  | SCHRAUBE F.GEHAEUSE<br>Body fixation screw   |           | 00712516            | 1                            |   |    |
| 49                  | ZYLINDERSTIFT F. ZAHNRAD<br>Cylinder pin for gear wheel                                |           | 00730519            | 2                            |   |    |
| 52                  | BOLZEN F.ZAHNRAD<br>Bolt for gear wheel  |           | 00730547            | 2                            |   |    |
| 50                  | GESTÄNGEBOLZEN SCHW.VERN.<br>Linkage pin; nickel-plated, black                         |           | 00730553            | 2                            |   |    |
| 51                  | GEST.BOLZEN F.4.RS BR 41<br>Linkage pin for 4th wheelset                               |           | 00730554            | 2                            |   |    |
| 53                  | Steckpuffer gewölbt<br>Plug-in buffer, curved  |           | 00754006            | 2                            |   |    |
| 54                  | STECK-PUFFER FLACH<br>Plug-in buffer, flat   |           | 00754015            | 2                            |   |    |
| 55                  | DRAHTRICHTFEDER L=27 MM (o. Abb.)<br>Thread straightening spring L=27mm (w/o illustr.) |           | 00764016            | 2                            |   |    |
| 56                  | ANDRUCKFEDER F.RADSATZ<br>Pressure spring for wheelset                                 |           | 00764316            | 1                            |   |    |
|                     | FLEISCHMANN KUPPLUNG<br>Fleischmann coupling   |           | 6510                | ---                          |   |    |
|                     | STECK-TAUSCHKUPPLUNG<br>Standard coupling  |           | 6511                | ---                          |   |    |
|                     | PROFI-STECKKUPPLUNG<br>Profi coupling  |           | 6515                | ---                          |   |    |
|                     | ERSATZ-SCHLEIFKOHLEN<br>Carbon brushes set   |           | 6519                | ---                          |   |    |
| 61                  | ERS.-GLUEHLAMPE KLAR M.STECKFA<br>Replacement bulb clear with plug-in socket           |           | 00006535            | 8                            |   |    |