

409402		BR T16.1 KPEV	8169	=	H0
Pos. Nr. Pos.no.	Beschreibung Description	Art.-Nr. Art.no.	Preisgruppe Price bracket		
1	LOKGEHÄUSE KPL. Body assembly complete	10409402	037		
2	FLUTLICHTLEITER U.PETROLEUMLAM Light conductor& kerosene lamp set	13409402	015		
3	PFEIFE Whistle	00194607	004		
	REICHSBAHN LATERNE VORN (o. Abb.) REICHSBAHN lamp, front (w/o illustration)	00194804	008		
	LATERNE HINTEN (o. Abb.) Lamp, rear (w/o illustration)	00194805	008		
4	KUPPLUNGSHAKEN (o.Abb.) Coupling hook (w/o illustration)	00194824	002		
5	SCHEIBEN MAGNET F.BR 94 Disc magnet	00195005	006		
6	KUKU-DEICHEL -SATZ Short coupling reception -set	38403900	012		
7	DEICHELABSTÜTZUNGEN -SATZ Short coupling reception cover -set	38404000	012		
8	FAHRGESTELL M. MOTOR U. SCHNIT Chassis complete with interface	40409402	046		
9	LOKFAHRGEST.M.GETR.U.RAED. Loco chassis with gearset and wheels	41409402	040		
10	STEUERUNG KPL.M.VERBUNDSTANGEN Reversing gear complete	42409402	033		
11	ZYLINDERKASTEN F.BR 94 Cylinder box	00434096	011		
12	LICHTABDECKUNG F.BR 94 Light cover	00454096	006		
13	ANKER KPL.M.SCHWUNGMASSE Rotor complete with integr. flywheel	00504607	025		
14	LAGERSCHILD ISOLIERT Motor PCB insulated	00504732	017		
15	KOHLENROHRKAPPE Brush pipe cap	00504801	002		
16	LOKRAD H.H. ROTBRAUN LACK. Driving wheel, w/o gear wheel, w/o trac. tyre, red brown	51441100	007		
17	LOKRAD H.H. ROTBRAUN LACK. UGR Driving wheel, w/o gear wheel, w/o trac. tyre, insul.,red brown	51441200	008		
18	LOKRAD N.H. ROTBRAUN LACK. Coupled wheel w/o traction tyre, w/o gear wheel, red brown	51441300	007		
19	LOKRAD N.H. ROTBRAUN LACK. UGR Coupled wheel w/o traction tyre, w/o gear wheel, red brown	51441400	008		
20	LOKRAD N.H. M.N. ROTBRAUN LACK Coupled wheel with traction tyre, w/o gear wheel, red brown	51441500	008		
21	LOKRAD N.H. M.N. ROTBRAUN LACK Coupled wheel with tract. tyre, w/o gear wheel, insul.,red brown	51441600	008		
22	ACHSE 10 MM Axle 10mm	00524002	002		
23	ACHSE Axle	00524011	001		
24	HAFTREIFEN H0 Traction tyre H0	00544006	001		
25	UNTERSETZUNGSRAD Z:28/13 SCHWA Reduction gear wheel Z:28/13, black	00564102	002		
26	UNTERSETZUNGSRAD Z:33/14 SCHWA Reduction gear wheel Z:33/14, black	00564115	002		
27	ZAHNRAD Z:18 SCHWARZ Gear wheel Z:18, black	00564120	003		
28	MESSINGZAHNRAD Z:18 Brass gear wheel Z:18	00564133	007		
29	RITZEL Gear wheel Z:10	56461300	006		
30	SICHERUNGSRING KLEIN Securing ring, small	00564701	001		
31	UNTERLEGSCH. ROT 2,2X5X0,5 (o.Abb.) Washer, red, 2.2X5X0.5 (gear side) (w/o illustr.)	00564742	001		
32	UNTERLEGSCH. ROT 2,3 X 5 X 0,1 Washer 2.3X5X0.1 (collector side)	00564747	001		
33	UNTERLEGSCH. ROT 2,2X5X0,3 (o.Abb.) Washer, red, 2.2X5X0.3 (gear side) (w/o illustr.)	00564751	001		

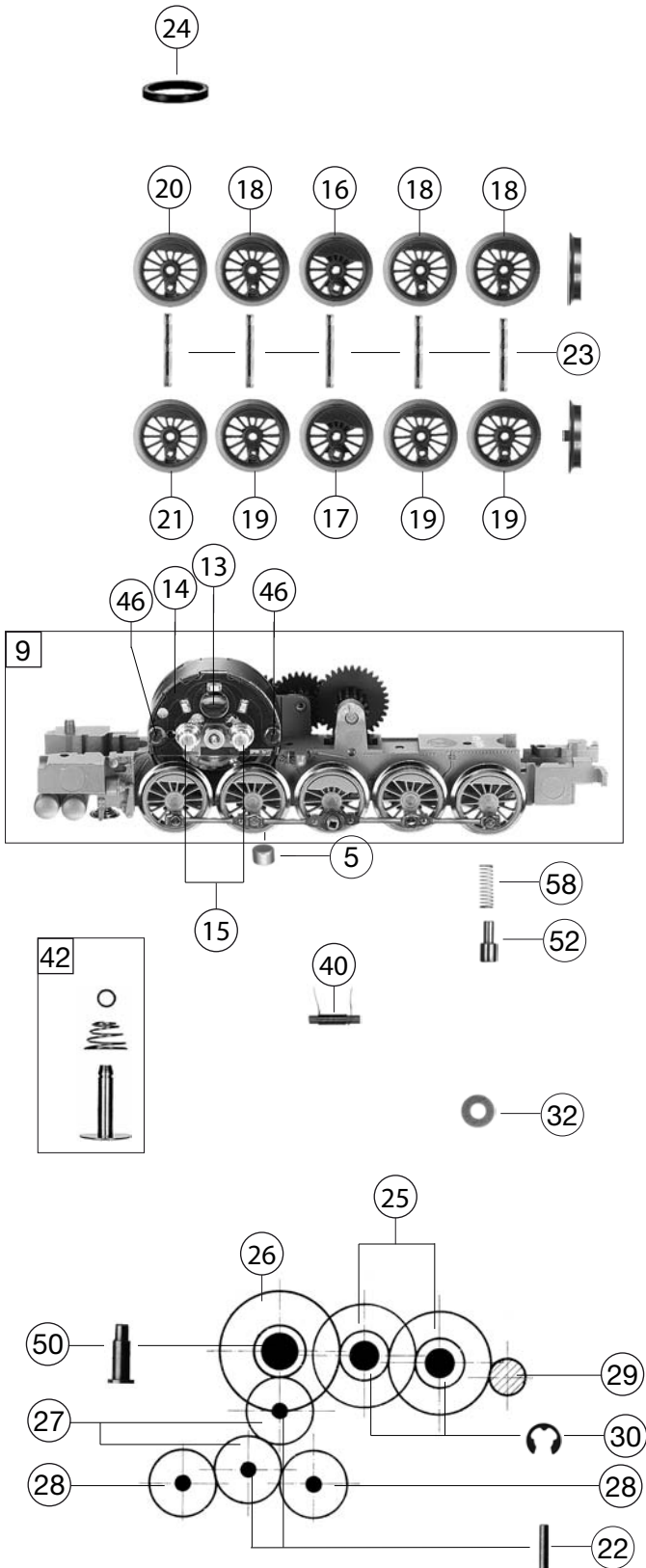

409402		BR T16.1 KPEV	8169	=	HO
Pos. Nr. Pos.no.	Beschreibung Description	Art.-Nr. Art.no.	Preisgruppe Price bracket		
34	STROMABNEHMEREINSATZ BR T16.1 Power pick-up assembly	60409402	017		
35	KONTAKTFEDER LINKS F.BR 94 Contacter sheet, left side	00614920	006		
36	KONTAKTFEDER RECHTS F.BR 94 Contacter sheet, right side	00614921	006		
37	ABDECKBLECH M.FASSUNG HINTEN Cover sheet with lamp socket (rear)	00624096	012		
38	ABDECKBLECH M.FASSUNG VORNE Cover sheet with lamp socket (front)	06240961	011		
39	HALTEPLATTE Mounting plate	00627170	002		
40	ENTSTOERDROSSEL Suppressor choke	00644101	007		
41	ENTSTOERDROSSEL(MAERKLIN) Suppressor choke (MAERKLIN)	00644102	005		
42	KONTAKTPILZGARN.F. BR 94 Contacter pin assembly	00644412	011		
43	BUCHSENLEISTE 6-POL.F.SCHNITT. Connector interface, 6-pin	00654073	014		
44	SCHNITTST.-BLINDSTECKER 6-POL. Jumper, 6-pin	00664002	013		
45	SCHRAUBE M 1,4 X 3 Screw M 1.4 X 3	00700203	001		
46	SCHRAUBE Screw	00700313	001		
47	SCHRAUBE Screw	00700405	001		
48	SCHRAUBE Screw	00700410	001		
49	SCHRAUBE Screw	00713516	001		
50	BOLZEN F. ZAHNRAD Cylinder pin for gear wheel	00730509	004		
51	BOLZEN F.KUPPELSTANGE Bolt for coupling rod	00730569	001		
52	LAGERBOLZEN Bearing bolt	00730571	002		
53	BOLZEN F.KUPPELSTANGE Bolt for coupling rod	00730572	002		
55	STANGEN-STECKPUFFER FLACH Plug-in shank buffer, flat	75401600	006		
54	STANGEN-STECKPUFF.GEWOELBT Plug-in shank buffer, curved	75401700	006		
56	DRAHTRICHTFEDER Thread straightening spring	00764023	002		
57	DRAHTRICHTFEDER L=15 MM Thread straightening spring, L=15mm	00764024	002		
58	DRUCKFEDER Pressure spring	00764332	002		
	FLEISCHMANN KUPPLUNG Fleischmann coupling	6510	---		
	STECK-TAUSCHKUPPLUNG Standard coupling	6511	---		
	PROFI-STECKKUPPLUNG Profi coupling	6515	---		
	ERSATZ-SCHLEIFKOHLEN Carbon brushes set	6519	---		
63	ERS.-GLÜHLAMPE M.SCHRAUBFAS. Screw-type bulb	00006530	007		