

436001		BR E60 DRG	E 6008	=	H0
Pos. N.r. Pos.no.	Beschreibung Description	Art.-N.r. Art.n.o.	Preisgruppe Price bracket		
1	LOKGEHÄUSE KPL. Body assembly complete	10436001	34		
2	FÜHRERHAUSDACH VORMONT. LACK. Roof of driver's cab assy , painted	11436001	14		
3	UMLAUFBLECH Running board	11436001	21		
4	FÜHRERSTAND Driver's cab complete	12436001	13		
5	LICHTLEITER -SATZ Light conductor set	13436001	12		
6	FENSTERBLENDEN-SATZ Window set	14436001	11		
7	STIRNFENSTER, SCHEIBENWISCHER- Windshield wiper set	14436001	11		
8	BESCHWERUNG Ballast	16436001	7		
9	ISOLATOREN-SATZ Set of isolators	18436001	12		
10	DACHLEITUNG-ÜBERSCHLAGRAHMEN Roof wiring, flashover frame	18436001	12		
11	SCHUTZBLECHSATZ Mudguard set	19436001	11		
	KLEINTEILE-SATZ (o. Abb.) Set of small parts (w/o illustr.)	19436001	11		
13	PFEIFE Whistle	00194617	2		
14	KUPPLUNGSHAKEN Coupling hook	00194824	2		
	KLEINTEILESATZ FÜR GEHÄUSE (o. Abb.) Set of small parts for body (w/o illustr.)	19492700	14		
16	TRITT-SATZ Treadle set	19503500	14		
17	GLOCKE, DACHLAUFBRETT Bell, roof running board	19503600	9		
18	SCHALTRAD Switch-wheel	19503700	3		
19	SIGNALSTÜTZE Signal support	19503800	2		
20	LOKLATERNE Loco lamp	19503900	9		
21	FAHRGESTELL Chassis	30436001	27		
22	BREMSKUPPLUNG KURZ/LANG -SATZ Brake coupling short/long - set	31436001	8		
23	BREMSEHÄNGE Brake rigging	31436001	9		
24	KUKU-DEICHSEL VORNE Short coupling reception front side	00384028	7		
25	KUKU-DEICHSEL Short coupling reception rear side	38403300	6		
26	KUPPELSTANGEN -SATZ Short coupling reception rear side	42436001	11		
27	DREHGESTELL KPL. Pony truck, complete	47436001	15		
28	MOTOR M.SCHW.F.4046 Motor with flywheel	00504046	29		
29	KOHLENHALTER Carbon brush holder	00507801	1		
30	MOTORHALTEBUEGEL Motor retainer clip	00507903	4		
31	TREIBRAD LI. Driving wheel, left	51447300	11		
	TREIBRAD RE. (o. Abb.) Driving wheel, right (w/o illustr.)	51447400	11		
33	KUPPELRAD LINKS Coupled wheel, left	51447500	9		
	KUPPELRAD RECHTS (o. Abb.) Coupled wheel, right (w/o illustr.)	51447600	9		
35	BLINDWELLENKURBEL Jackshaft crank	51447700	8		
	BLINDWELLENKURBEL RECHTS (o. Abb.) Jackshaft crank (w/o illustr.)	51447800	8		
37	ACHSE Axle	00527008	1		

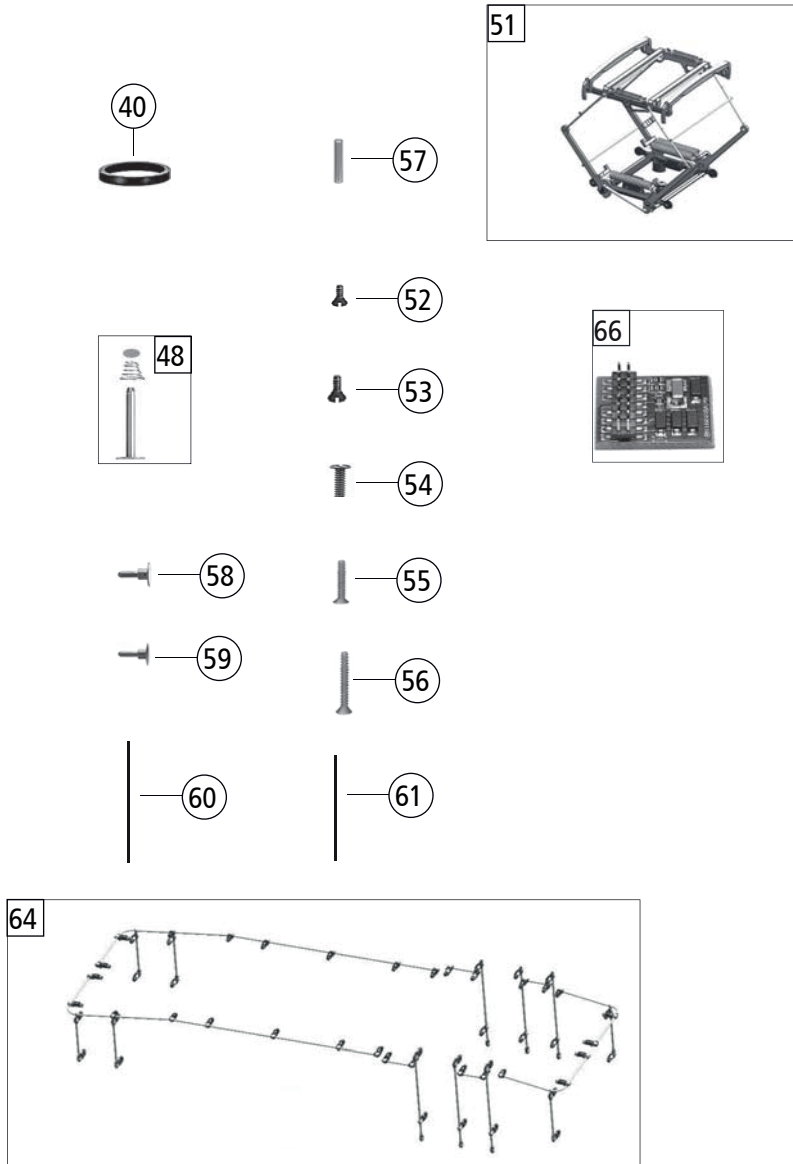

436001 BR E60 DRG		E 6008	=	HO
Pos. Nr. Pos.n.o.	Beschreibung Description	Art.-Nr. Art.n.o.	Preisgruppe Price bracket	
38	ACHSE Axle	00524011	1	
39	LAUFRADSATZ KPL. Carrying wheelset, complete	53432400	12	
40	HAFTREIFEN HO Traction tyre HO	00544006	1	
41	ZAHNRAD M. RATSCHRING Z:28 Gear wheel with ratchet ring Z=28	00564178	5	
	UNTERSATZUNGSRAD Z:18/24 (o. Abb.) Reduction gear wheel Z:18/24 (w/o illustr.)	00564179	6	
	ZAHNRAD M.FED. F.4046 (o. Abb.) Gear wheel with spring (w/o illustr.)	00564185	5	
44	SCHNECKE D = 4MM L = 7MM Worm gear D = 4MM L = 7MM	00567605	6	
45	ABDECKPLATTE MIT RADKONT Cover plate with wheel contacts	60436001	14	
46	MOTORKONTAKTFEDER LI Motor contact spring, left	61498500	6	
47	MOTORKONTAKTFEDER RE Motor contact spring, right	61498600	6	
48	KONTAKTPILZ GARNITUR Contacter pin assy	64441900	8	
49	LEITERPLATTE KPL. PCB, complete	65418300	24	
50	LEITERPLATTE PCB	65418400	13	
51	DACHSTROMABNEHMER Pantograph	67433800	18	
52	Senkschraube M1,6x4 DIN7500 RO Countersunk screw M 1.6 X 4 DIN7500	70900007	2	
53	SK-Schraube M2x5 DIN7500 EK/SW Countersunk screw M 2 X 5 DIN7500, black	70900009	1	
54	GF-Schraube M2x5 DIN7500 SW Self-cutting screw M2x5 DIN7500, black	70900011	3	
55	SENKKOPFBLECHSCHRAUBE B 2,2 x Countersunk tapping screw B 2.2	70900030	3	
56	SENKKOPFBLECHSCHRAUBE KREUZSCH Countersunk philipps screw	00712509	1	
57	ZYLINDERSTIFT 2 X 10 Cylinder pin 2x10	00730538	1	
58	STECKPUFFER Plug-in buffer, curved	00754006	2	
59	STECKPUFFER FLACH Plug-in buffer, flat	00754015	2	
60	RICHTFEDER Straightening spring	00764020	2	
61	RICHTFEDER F.4122 Straightening spring F.4122	00764021	2	
62	ANDRUCKFEDER F.RADSATZ Pressure spring for wheelset	00764328	1	
63	DEICHSELFEDER Pony truck spring	76433800	3	
64	GRIFFTANGENSATZ Hand-rail -set	19492600	14	
65	LICHTKONTAKT Light contact	61498700	6	
66	PLUX-Brückentecker Plux jumper	66401500	17	
	STECKKUPPLUNG (o. Abb.) Clip-in coupling (w/o illustration)	6510	---	
	STECKTAUSCHKUPPLUNG (o. Abb.) Clip-in standard coupling (w/o illustration)	6511	---	
	PROFI-STECKKUPPLUNG (o. Abb.) Profi plug-in coupling (w/o illustr.)	6515	---	
	ERSATZ-SCHLEIFKOHLEN (o. Abb.) Carbon brushes set (w/o illustr.)	6518	---	
71	GESTAENGEBOEZEN schwarz vern. Linkage pin black nickel-plated	00730549	002	