

480901		BR S10.1 KPEV	1110	=	HO
Pos. Nr. Pos.no.	Beschreibung Description	Art.-Nr. Art.no.	Preisgruppe Price bracket		
1	LOKKESEL BR S10.1 Loco boiler complete w/o driver's cab	10480901	033		
2	FUEHRERHAUS BR S10.1 Driver's cab complete	11480901	023		
	LICHTLEITER-SATZ F.4117 (o. Abb.) Light conductor (w/o illustration)	00134117	012		
5	UMLAUFBLECH KPL.F.S10.1 Running board complete	15480901	027		
6	PFEIFE Whistle	00194607	004		
7	RANGIERGRIF Shunter hand-rail	00194711	003		
8	HANDRAD Hand wheel	00194716	006		
9	GRIFSTANGEN-SATZ F.4117 Handrail set	00194724	009		
10	REICHSBAHNLATERNE VORN REICHSBAHN lamp, front	00194804	008		
	BREMSSCHLAEUCH-SATZ (o. Abb.) Brake hose-pipe set (w/o illustration)	00194815	011		
12	KUPPLUNGSHAKEN Coupling hook	00194824	002		
12	TENDERGEHAEUSE Tender body complete	20480901	028		
	LUFTKESSEL AM TENDER /ROTBRAUN (o.Abb.) Air tank at tender, red-brown (w/o illustr.)	22413801	006		
	TREPPEN/SATZ (o.Abb.) Set of ladders (w/o illustr.)	22480901	007		
15	LICHTLEITER/TENDER Light conductor (tender)	00234139	005		
16	TENDERBESCHWERUNG Tender ballast	00264138	017		
17	LOKFAHRGESTELL KPL.480901 Loco chassis complete	30480901	047		
18	STEUERUNG KPL. EINSCHL. KUPPEL Reversing gear complete, incl. coupling rod	32480901	032		
19	ZYLINDER LI.U.RE.U.KOLBENSTANG Cylinder l&r -set, incl. piston rod tube	33480901	015		
20	VORLAUFGESTELL 2 ACHS.F.480901 Bogie (front) complete	37480901	020		
22	KUKU-DEICHSEL SCHWARZ Short coupling reception, black	00384023	006		
21	KUKU-DEICHSEL TENDER/HINTEN Short coupling reception (tender)	38403200	006		
23	LOK-TENDERKUPPL.U.DEICHSEL-S. Coupling between loco and tender -set	00384113	012		
24	TENDERFAHRGEST.O.MOT.F.480901 Tender chassis w/o motor	40480901	036		
25	TENDERRAHMEN KPL.BR S 10.1 Tender framework	41480901	022		
26	ABDECKPLATTE UNTEN TENDER/SATZ S10 Tender bottom cover plate front/rear -set	43480901	008		
27	LICHTABDECKUNG Light cover	00454139	004		
28	MOTOR M.SCHWUNGM. Motor with flywheel complete	00504138	025		
29	MOTORHALTER Motor retainer clip	00504902	004		
30	MOTORHALTER M.KONTAKTEN Motor retainer clip with contacts	00504905	015		
31	ACHSE 10 MM Axle 10mm	00524002	002		
32	TENDERRADSATZ KPL.M.N.+M.Z. Tender wheelset with gear, with traction tyre, insul.	53414500	009		
33	TENDERRADSATZ O.Z.O.N.ISO. Tender wheelset w/o gear, w/o traction tyre	53414600	012		
34	VORLAUFRADSATZ KPL.ISO. Bogie wheelset	53418200	012		
35	KUPPELRADSATZ Coupled wheelset, front	53418300	016		
36	TREIBRADSATZ Driving wheelset	53418400	016		
37	KUPPELRADSATZ Coupled wheelset, rear	53418500	016		

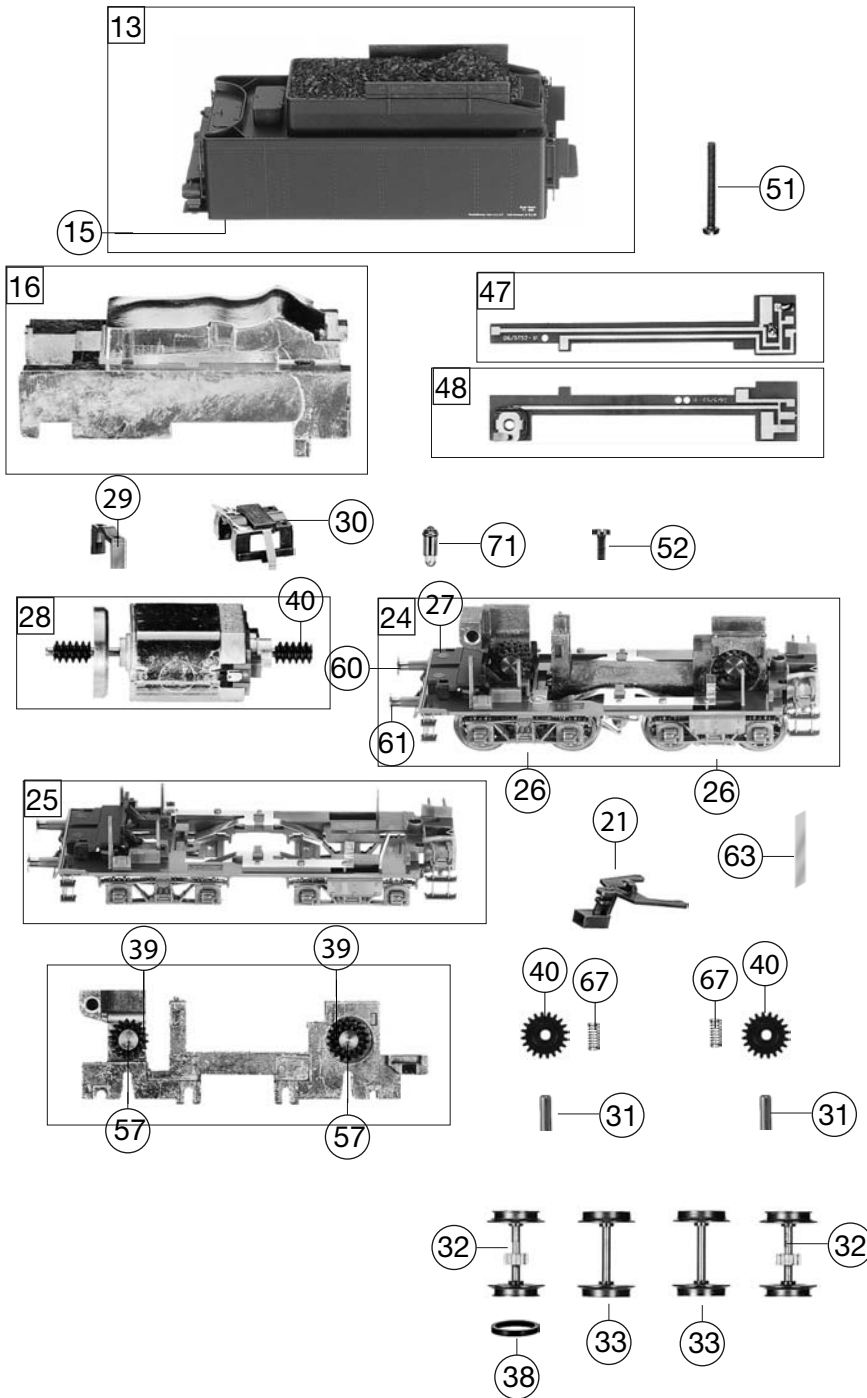

480901		BR S10.1 KPEV	1110	=	HO
Pos. Nr. Pos.no.	Beschreibung Description	Art.-Nr. Art.no.	Preisgruppe Price bracket		
38	HAFTREIFEN HO Traction tyre HO	00544007	001		
39	UNTERSETZUNGSRAD Z:18/13 SCHWA Reduction gear wheel Z:28/13, black	00564130	002		
40	ZAHNRAD Z:20 Gear wheel Z:20	00564161	005		
41	SCHNECKE Worm gear	00564606	005		
42	ABDECKPLATTE UNTEN M.RADKONT. (LOK) Power pick-up assembly	60480901	016		
43	HALTEWINKEL F.DECO. Mounting bracket for decoder	00624113	005		
44	LAMPENKONTAKTHALTER BR 17 Lamp contact support	00634117	013		
	ENTSTOERKONDENSATOR (o. Abb.) Capacitor (w/o illustr.)	00644202	006		
46	KONTAKTPILZGARN.F. BR 17 Contacter pin assembly	00644413	011		
47	SCHALTPL.LINKS F.TENDER Left tender PCB	00654099	012		
48	SCHALTPL.RECHTS F.TENDER Right tender PCB	00654100	014		
49	LEITERPLATTE M.SCHNITTSTELLE PCB with interface	00654111	019		
50	SCHNITTST.-BLINDSTECKER 6-POL. Jumper, 6-pin	00664002	013		
51	SCHRAUBE F.TENDERGEHAEUS Screw for tender body	00700420	001		
52	SCHRAUBE Screw	00700905	001		
53	KS-SENKKOPF-SCHRAUBE Countersunk tapping screw	00702405	001		
54	ZYLINDERKO.SCHRAUBE M.SCHLITZ Slotted cylinder head screw	00704405	001		
55	BLECHSCHRAUBE M.KREUZSCHLITZ Tapping screw	00713309	001		
56	SENKKOPFBLECHSCHR.2,2X16 KS Countersunk tapping screw	00714516	001		
57	BOLZEN F. ZAHNRAD Bolt for gear wheel	00730517	003		
58	GEST.BOLZEN Bolt for coupling rod	00730554	002		
59	GEST.BOLZ. Bolt for coupling rod	00730555	001		
61	STANGENPUFFER FLACH Plug-in shank buffer, flat	00754035	004		
60	STANGENPUFFER GEWOELBT Plug-in shank buffer, curved	00754036	004		
62	PUFFERBOHLE KPL.F.BR S10 Loco front framework complete	75480901	018		
63	BLATTRICHTF.F. TENDER L=30MM Flat straightening spring (tender), l=30mm	00764005	002		
64	RICHTFEDER Straighthening spring	00764021	002		
65	DRUCKFEDER F.LOKRADSATZ Flat pressure spring for loco wheelset	00764310	001		
	DRUCKFEDER (o. Abb.) Pressure spring (w/o illustr.)	00764318	001		
67	ANDRUCKFEDER F.RADSATZ Pressure spring for wheelset	00764328	001		
	Fleischmann- Steckkupplung (o. Abb.) Fleischmann plug-in coupling (w/o illustration)	6510	---		
	Standard- Steckkupplung (o. Abb.) Standard- coupling (w/o illustration)	6511	---		
	PROFI-STECKKUPPLUNG Profi coupling	6515	---		
71	ERS.-GLUEHLAMPE KLAR M.STECKFA Replacement bulb, clear, with plug-in socket	00006535	008		