

38	KUPPLUNGSATRAPPE Coupling dummy	00194835	005
39	FRONTWAND M. SCHÜRZE Front wall with skirt	00334407	014
40	KUPPELSTANGE Coupling rod	00386009	005

Pos. Nr. Pos.no.	Beschreibung Description	Art.-Nr. Art.no.	Preisgruppe Price bracket
481401	VT 795 DB	795201-3+ 995368-8	HO
1	GEHÄUSE KPL. F. MOTORWAGEN Body assembly complete (motor coach)	04814012	031
2	WAGENBODEN F. MOTORWAGEN Motor coach chassis	00114407	029
3	INNENBELEUCHTUNG KPL. F. MOTORW. Interior lighting -set (motor coach)	34814012	024
4	FENSTER-SATZ F. TRIEBWAGEN Set of windows (motor coach)	00144407	019
5	INNENEINRICHTUNG F. TRIEBWAGEN Interior fittings for motor coach	00154405	011
6	STIRNLAMPEN-SATZ Set of headlights	19488600	012
7	FAHRGESTELL KPL. OHNE MOTOR chassis complete w/o motor	00404407	033
9	KUKU-DEICHSEL Short coupling reception	00385005	004
12	ACHSHALTER-SATZ Axle guard -set	00434405	009
13	MOTOR KPL. M. SCHWUNGMASSE Motor, complete with flywheel	00504405	029
14	KOHLLENHALTER Brush holder	00507801	001
15	MOTORHALTEBUEGEL Motor retainer clip	00507903	004
16	SCHEIBENRAD ISO. Disc type wheel, insulated	00514341	006
17	SCHEIBENRAD Disc type wheel	00514342	006
18	ACHSE GEKERBT Milled axle	00524008	005
19	ACHSE Axle	00527008	001
20	RADSATZ M. Z. F. 4405 Wheelset with gear	00534058	012
21	UNTERSETZUNGSRAD Z:16/12 SCHWA Reduction gear wheel Z:16/12, black	00564159	006
22	ZAHNRAD Z:13 F. 4405 Gear wheel Z:13	00564160	006
23	SCHNECKE D = 4MM L = 5MM Worm gear	00567601	007
24	ZUSATZSTROMABNEHMEREINSATZ Additional power pick-up assy	00604406	017
25	STROMABNEHMEREINSATZ F. 4405/07 Power pick-up assy	00604407	023
26	LEITERPLATTE MIT DIODE PCB with diode (w.illustr.)	64402000	---
27	LEITERPLATTE MIT DIODE PCB with diode	64402100	---
28	KONDENSATOR Anti-noise capacitor	64420900	005
29	KONDENSATOR Capacitor	00644206	005
30	KONTAKTPILZGARNITUR L:11,5 MM Contacter pin assembly	00644403	011
31	STOSSFEDERBUEGEL F. 4405,4406 Clamp type buffer	00754028	002
32	DRAHTRICHTFEDER L=27 MM Thread straightening spring l=27mm	00764016	002
	STECK-TAUSCHKUPPLUNG (o. Abb.) Standard- plug-in coupling (w/o illustration)	6510	---
	PROFI-STECKKUPPLUNG (o. Abb.) Profi plug-in coupling (w/o illustration)	6515	---
	ERSATZ-SCHLEIFKOHLEN (o. Abb.) Carbon brushes (w/o illustration)	6518	---
36	ERS.-GLUEHLAMPE KLAR M. STECKFA Replacement bulb clear with plug-in socket	00006535	008
37	ENTSTÖRDROSSEL Suppressor choke	00644101	007

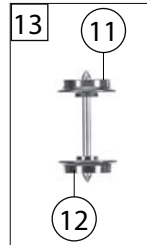
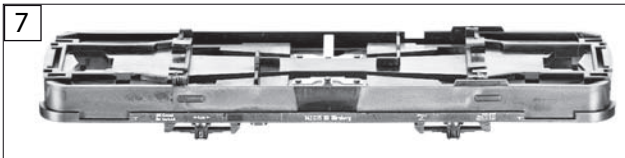
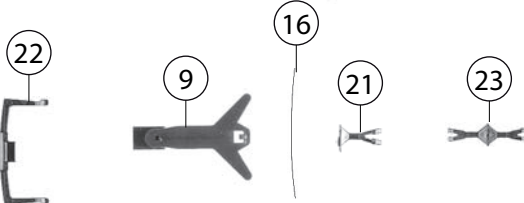
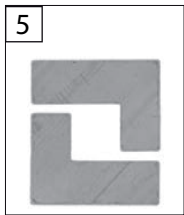
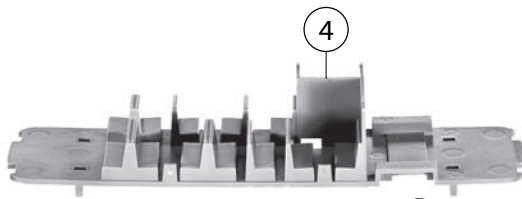
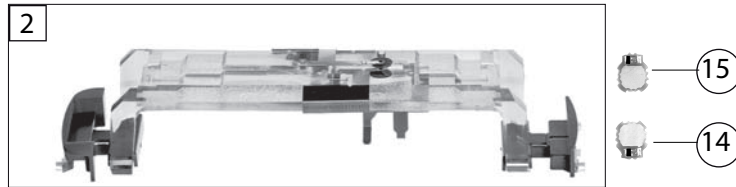

481401	VB 995 DB	795201-3+ 995368-8	=	HO
Pos. Nr. Pos.no.	Beschreibung Description	Art.-Nr. Art.no.	Preisgruppe Price bracket	
1	GEHÄUSE KPL. F.BEIWAGEN Body assembly complete (trailer coach)	104814013	031	
2	INNENBELEUCHTUNG-S.F. BEIWAGEN Interior lighting -set (trailer coach)	13481401	024	
3	FENSTER-S. F.BEIWAGEN Set of windows (trailer coach)	00144408	018	
4	INNENEINRICHTUNG F. BEIWAGEN Interior fittings for trailer coach	15440501	011	
5	BESCHWERUNG-SATZ Ballast set	00164406	009	
7	WAGENBODEN F. BEIWAGEN Trailer coach chassis	00304408	017	
9	KUKU-DEICHSEL Short coupling reception	00385005	004	
11	SCHEIBENRAD ISO. Disc type wheel, insulated	00514341	006	
12	SCHEIBENRAD Disc type wheel	00514342	006	
13	RADSATZ F.4406 Wheelset	00534059	008	
14	LEITERPLATTE M. DIODE PCB with diode	64402000	---	
15	LEITERPLATTE M. DIODE PCB with diode	64402100	---	
16	DRAHTRICHTFEDER L=27 MM Thread straightening spring l=27mm	00764016	002	
	STECK-TAUSCHKUPPLUNG (o. Abb.) Standard- plug-in coupling (w/o illustration)	6510	---	
	PROFI-STECKKUPPLUNG (o. Abb.) Profii plug-in coupling (w/o illustration)	6515	---	
19	ERS.-GLUEHLAMPE KLAR M.STECKFA Replacement bulb clear with plug-in socket	00006535	008	
20	STOSSFEDERBÜGEL Clamp type buffer	00754028	002	
21	KUPPLUNGSATRAPPE Coupling dummy	00194835	005	
22	FRONTWAND M. SCHÜRZE Front wall with skirt	00334407	014	
23	KUPPELSTANGE Coupling rod	00386009	005	