

707781		DB	BR 78.0-5		=	N
Pos. Nr. Pos.no.	Beschreibung Description	Art.-Nr. Art.no.	Preisgruppe Price bracket			
1	LOKGEHÄUSE KPL. Body assembly complete	10707701	034			
2	FLUTLICHTLEITER -SATZ Light conductor - set	00137078	012			
3	BESCHWERUNG Ballast	00167077	017			
4	GLOCKE Bell	00197502	004			
5	PFEIFE BRÜN. Whistle blackened	00197605	004			
6	FAHRGESTELL KPL. OHNE MOTOR Chassis w/o motor	04070751	039			
7	FAHRGESTELL M.LOKRÄDER,ZAHNRÄD Chassis with loco wheels and gear wheels	00417075	032			
8	KREUZKÖPFE MIT VERBUNDSTANGEN Cross-heads with coupling rods	00427075	018			
9	DECKPLATTE UNTEN Lower cover plate	00437078	007			
10	LAUFGESTELL KPL. Carrying wheels complete	00477078	019			
11	MOTOR O.SCHW.O.MASSEKONTAK.iso Motor w/o flywheel w/o ground contactor	00507077	028			
12	KOEHLENHALTER Brush holder	00507801	001			
13	LOKRAD Loco wheel	00517025	006			
14	LOKRAD Loco wheel	00517026	006			
15	LOKRAD Loco wheel	00517027	006			
16	ACHSE Axle	00527001	002			
17	RADSATZ KPL.F.BR 78 Wheelset complete for BR 78	00537029	011			
18	HAFTREIFEN Traction tyre	00547004	001			
19	ZAHNRAD Gear wheel	00567112	007			
20	ZAHNRAD Gear wheel	00567117	002			
21	SCHNECKE D = 4MM L = 8MM Worm gear D=4mm, L=8mm	00567604	006			
22	STROMABNEHMEREINSATZ KPL. MIT Power pick-up assembly	06070751	030			
23	BLATTFEDER Flat spring	00617905	001			
24	HALTEBLECH Sheet metal support	00627077	007			
25	LAMPENKONTAKTHALTER Lamp contact support	00637078	009			
26	ENTSTOERDROSSEL Suppressor choke	00644101	007			
27	KONDENSATOR Capacitor	64420900	005			
	LOKEMPFÄNGER DCC(RailCom) "N" (o.Abb.) N gauge DCC-decoder (railCom) (w/o Illustr.)	68707781	041			
29	SCHRAUBE M 1,4 X 3 Screw M 1,4 X 3	00700203	001			

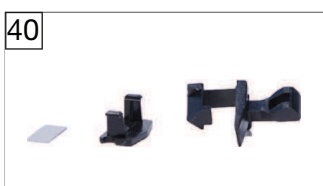
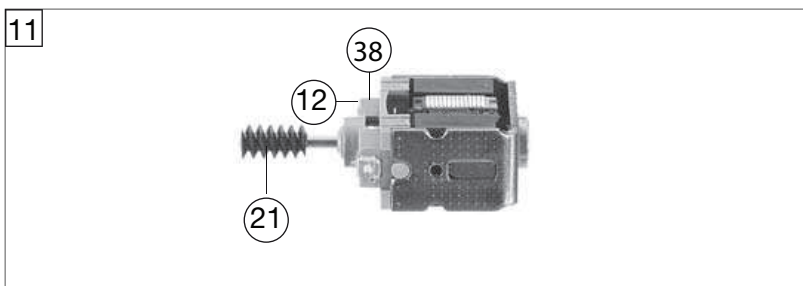
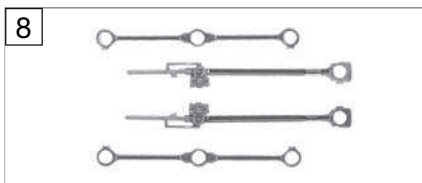
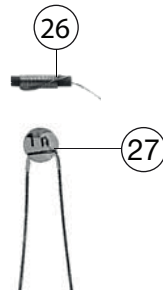
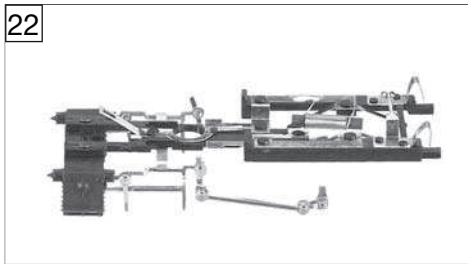
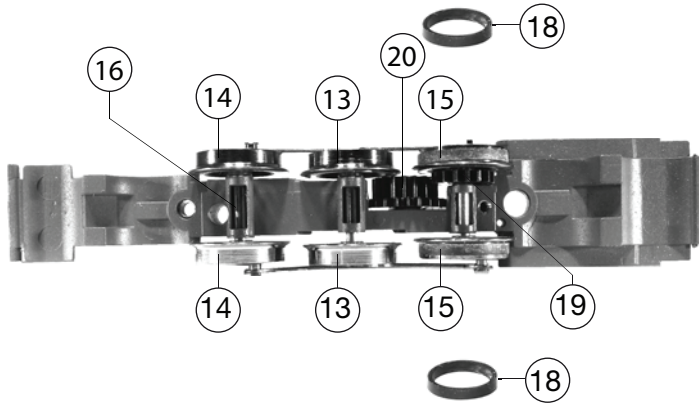
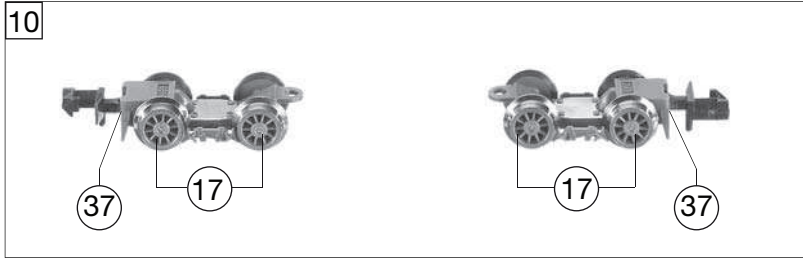

707781		DB	BR 78.0-5		=	N
Pos. Nr. Pos.no.	Beschreibung Description	Art.-Nr. Art.no.	Preisgruppe Price bracket			
30	SENKSCHRAUBE KS Countersunk screw	00702303	001			
31	BLECHSCHRAUBE M.KREUZSCHLITZ Tapping screw	00713309	001			
32	SCHRAUBE Screw	00730025	002			
33	ZAPFENSCHRAUBE VERN. Spigot screw nickel-plated	00730028	001			
34	BOLZEN F. ZAHNRAD Bolt for gear wheel	00730511	002			
35	BOLZEN F. KUPPELSTANGE Bolt for coupling rod	00730565	002			
36	STECKPUFFER Plug-in buffer	00757002	002			
37	BLATTRICHTFEDER F.KUPPLUNG N Flat straightening spring for coupling	00767006	001			
38	ERSATZ SCHLEIFKOHLEN Carbon brushes set	6518	---			
39	ERS.-GLUEHLAMPE KLAR M.STECKFA Replacement bulb, clear, with plug-in socket	00006535	008			
40	STANDARD-KUPPLUNG Standard coupling	9521	---			
41	PROFI-KUPPLUNG Profi coupling	9541	---			