

715211	150-Y-6982	SNCF	=	N
Pos. Nr. Pos.no.	Beschreibung Description	Art.-Nr. Art.no.	Preisgruppe Price bracket	
1	LOKGEHÄUSE KPL.BR 52 loco chassis complete	10715211	---	
2	UMLAUFBLECH running board	11715207	---	
3	LICHTLEITER light conductor set	13715201	006	
4	ZUGHAKEN-BREMSKUP.-KOLBENSTANG coupling hook break coupling piston rod	19715201	02	
5	PFEIFE Whistle	00197605	004	
6	TENDERGEHAEUSE KPL. Tender body complete	20715211	---	
7	TENDERRAHMEN KPL. Tender framework complete	21715211	---	
8	LEITER-TREPPE-HANDLAUF-ROHRLEI ladder-stares-handrail-pipestars	22715211	---	
9	LICHTLEITER FUER TENDER light conductor for tender	23715201	006	
10	LOKFAHRGESTELL KPL. Loco chassis complete	30715211	---	
11	LOKFAHRGESTELL MIT RÄDERN loco chassis with wheels	31715211	---	
12	STEUERUNG KPL.M.KUPPELSTANGEN Reversing gear complete with coupling rod	32715211	---	
13	DECKPLATTE UNTEN cover plate bottom side	00337186	006	
14	VORLAUFGESETZ KPL. Carrying wheel set complete	37715211	---	
15	ADAPTER adaptor	38702400	007	
16	KUPPELLASCHE LOK-TENDER coupling latch loco-tender	38802100	004	
17	TENDERFAHRGESTELL KPL.O.MOTOR tender chassis complete w/o motor	40715211	---	
18	TENDERFAHRGESTELL MIT ZAHNRÄDE tender chassis with gear wheels	41715205	---	
19	ZYLINDERKASTEN KPL.BR 52 cylinder box complete	48715206	014	
20	MOTOR motor	50715201	030	
21	MOTORHALTEBUEGEL motor retainer clip	50791400	002	
22	KUPPELRAD, schwarz, isol. coupled wheel, black, isolated	51716300	---	
23	TREIBRAD LINKS Driving wheel, left side	51716100	---	
24	TREIBRAD RECHTS Driving wheel right side, low flange	51716200	---	
25	KUPPELRAD, schwarz coupled wheel, low flange	51716800	---	
26	TENDERRAD O.Z.O.N.schwarz.UGR Tender wheel w/o gear, w/o groove, black, isol.	51716400	---	
27	LOKRAD O.Z.O.N. schwarz LACK. Loco wheel w/o gear, w/o groove, black	51716500	---	
28	TENDERRAD O.Z.M.N.schwarz LACK.UGR Tender wheel w/o gear, with groove, black, isol.	51716600	---	
29	TENDERRAD M.Z.M.N. schwarz LACK. Tender wheel w/o gear, with groove, black	51716700	---	
30	ACHSE axle	00527007	001	
31	ACHSE axle	52701200	001	
32	Vorlauf-Radsatz (Scheibenräder) Carrying wheelsset (disk type)	53715000	012	
33	HAFTREIFEN traction tyre	00547001	001	
34	ZAHNRAD gear wheel	56718100	003	
56	TENDERRAD O.Z.O.N. schwarz LACK. isol. Tender wheel w/o gear, w/o groove, black, isol.	51714100	---	
57	TENDERRAD O.Z.O.N. schwarz LACK. Tender wheel w/o gear, w/o groove, black	51714200	---	

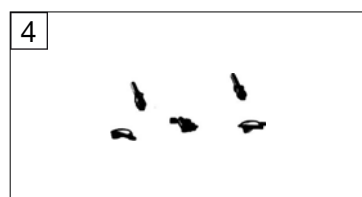
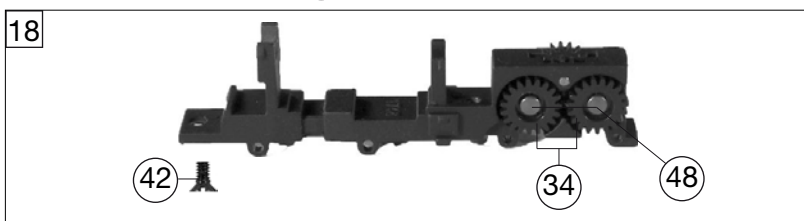
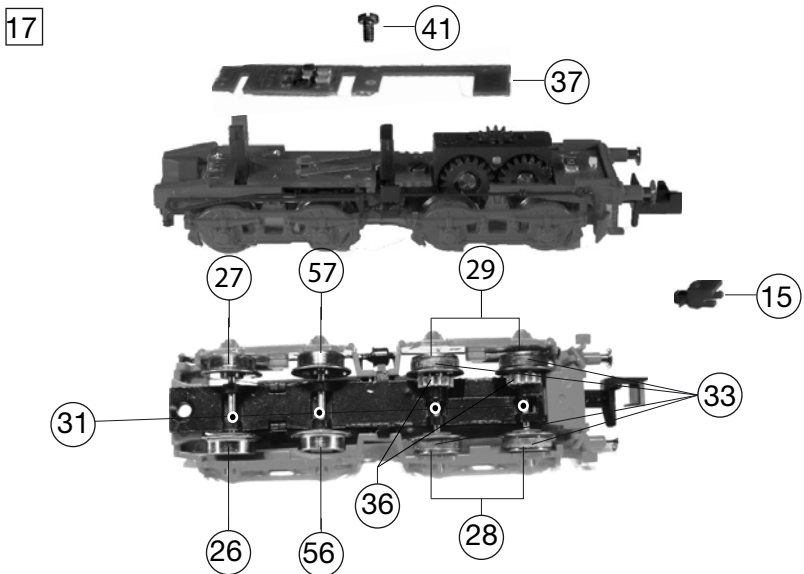
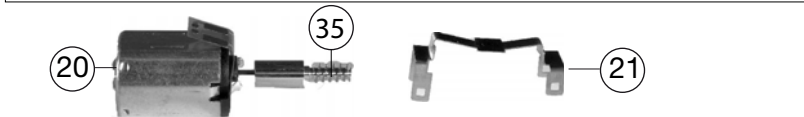

715211	150-Y-6982	SNCF	=	N
Pos. Nr. Pos. no.	Beschreibung Description	Art.-Nr. Art. no.	Preisgruppe Price bracket	
35	SCHNECKE MESS. D=3MM L=5,5 MM Worm gear, brass	56762200	009	
36	Ritzel Gear wheel	56762000	001	
37	LEITERPLATTE KPL. (TENDER) PCB complete (tender)	65714000	018	
38	LEITERPLATTE KPL. PCB complete	65714100	022	
39	LEITERPLATTE KPL. PCB complete	65714200	022	
40	SCHNITTST.-BLINDSTECKER 6-POL. Jumper 6-pin	00664005	013	
41	SCHRAUBE M 1,4 X 3 screw	00700203	001	
42	SCHRAUBE screw	00702304	001	
43	LINSENSCHRAUBE F.7181/82 button screw	00704902	002	
44	LINSENSCHRAUBE F.7339 button screw	00704904	002	
45	BLECHSCHRAUBE M.KREUZSCHLITZ tapping screw	00713309	001	
46	BOLZEN F.KUPPELSTANGE bolt for coupling rod	00730562	002	
47	BOLZEN F. KUPPELSTANGE Bolt for coupling rod	00730570	001	
48	BUNDBOLZEN F.7225 Flanged bolt	00730578	003	
49	STECKPUFFER (GEWÖLBT) plug-in buffer (curved)	00757011	002	
50	STECKPUFFER (FLACH) plug-in buffer (flat)	00757012	002	
51	ZUGFEDER SCHWARZ VERN. Draw spring black nickel-plated	76710800	001	
52	FEDERBÜGEL F.ZUGFEDER 76710800 spring clip for drawing spring	76711000	001	
53	STANDARD-KUPPLUNG standard coupling	9521	---	
54	STANDARD-STECKKUPPLUNG standard clip in coupling	9525	---	
55	PROFI-KUPPLUNG profi coupling	9541	---	
	PROFI-STECKKUPPLUNG (o. Abb.) profi clip in coupling (w/o illustr.)	9545	---	