

716082		P8 (BR 38)KPEV		DCC	==	N
Pos. Nr. Pos.no.	Beschreibung Description	Art.-Nr. Art.no.	Art.-Nr. Art.no.	Preisgruppe Price bracket		
1	LOKGEHÄUSE KPL. Body assembly complete	10716082		031		
2	LICHTLEITER light conductor	00137159		006		
3	GLOCKE bell	00197502		004		
4	TENDERGEHÄUSE KPL. Tender body complete	20716002		019		
5	TENDERBODENRAHMEN KPL. Tender body complete	21716002		015		
6	TENDERBESCHWERUNG BR 38 P8 tender weight	26716002		011		
7	LOKFAHRGESTELL KPL. Loco chassis complete	30716082		038		
8	LOKFAHRGESTELL MIT RÄDERN loco chassis w/it wheel	31716002		030		
9	KREUZKÖPFE MIT VERBUNDSTANGEN cross head w/shank stick	32716002		019		
10	DECKPLATTE UNTEN cover plate bottomside	33716002		006		
11	KUPPELLASCHE coupling tongue	00347160		002		
12	VORLAUFGESTELL KPL. Re chassis complete	37716002		016		
13	ADAPTER adapter	38701700		006		
14	TENDERFAHRGESTELL KPL. OHNE MO tender chassis complete w/ motor	40716002		031		
15	TENDERFAHRGESTELL MIT ZAHNRAD tender chassis w/ gear wheel	41716002		---		
16	MOTOR O.SCHW.M.MASSEKONTAKT motor w/o flywheel and weight contact	50716082		029		
17	KOHLLENHALTER carbon brush holder	00507801		001		
18	TENDERRAD O.Z.M.N.ISO. Tender wheel with isolation	51709900		008		
19	TENDERRAD O.N.O.Z.UGR. driving wheel w/o traction tyre w/o gear wheel	51710000		007		
20	LOKRAD M.H. GR.SCHWUNGMASSE UG loco wheel flywheel-weight	51710900		007		
21	LOKRAD M.H. KL.SCHWUNGMASSE UG loco wheel flywheel-weight	51711000		007		
22	TENDERRAD M.N. M.Z. UGR. Tender wheel with traction tyre and gear wheel	51711100		006		
23	TENDERRAD O.N. M.Z. UGR. Tender wheel w/o traction tyre and gear wheel	51711200		007		
24	TENDERRAD O.N. O.Z. UGR. driving wheel w/o traction tyre w/o gear wheel	51714300		---		
25	ACHSE axel	00527011		001		
26	ZAHNRAD Z:10 gear wheel	00527160		005		
27	RADSATZ KPL. Wheel set complete	53710400		015		
28	HAFTREIFEN traction tyre	00547001		001		
29	ZAHNRAD Z:14 SCHWARZ gear wheel black	00567106		004		
30	ZAHNRAD Z:20/20 SCHWARZ gear wheel black	00567107		006		
31	ZAHNRAD 04/12 gear wheel	56718200		---		
32	SCHNECKE D = 4MM L = 5MM worm	00567601		007		
33	STROMABNEHMEREINSATZ KPL.M.ZYL Power pick-up assembly	60716082		031		
34	HALTER F.DECODER 87160 holder for decoder	00627160		007		

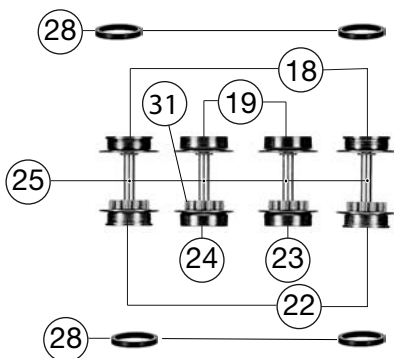
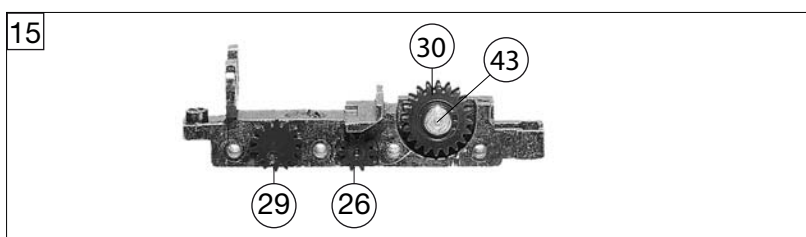
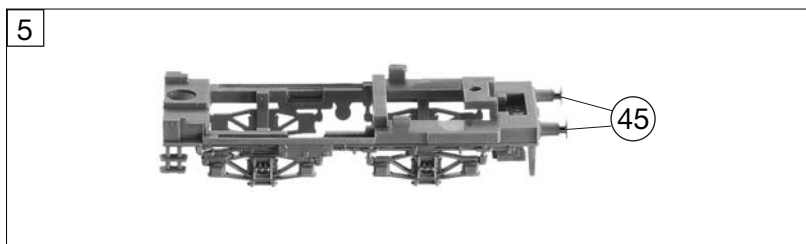
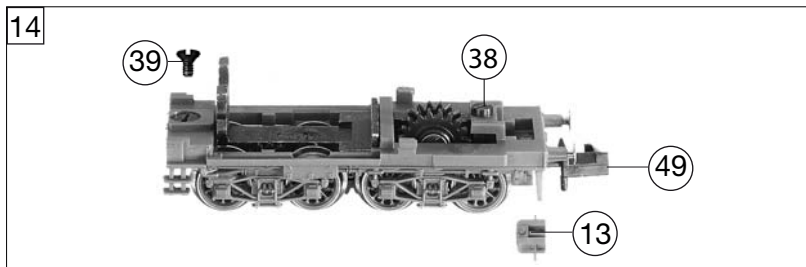
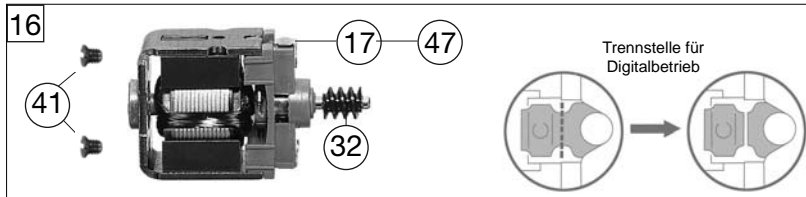
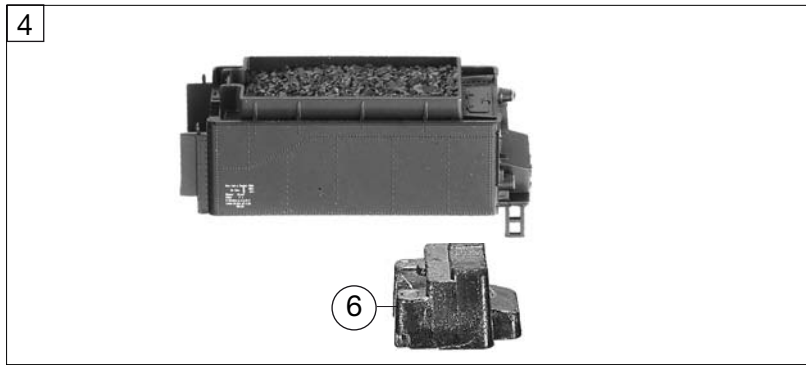

716002		P8 (BR 38)KPEV	DCC	=	N
Pos. Nr. Pos. no.	Beschreibung Description	Art.-Nr. Art. no.	Preisgruppe Price bracket		
35	HALTEPLATTE (KÜHLUNG) holder for air-condition	62716082	007		
36	ENTSTOERDROSSEL Suppressor choke	00644101	007		
37	ENTSTOERKONDENSATOR Suppression capacitor	00644202	006		
38	SCHALTPL.TENDER 7159/63/70-73 Switch plate complete	00657003	019		
39	SCHRAUBE M 1,4 X 3 worm	00700203	001		
40	SENKSCHRAUBE KS Countersunk screw	00702303	001		
41	SCHRAUBE worm	00702304	001		
42	BLECHSCHRAUBE M.KREUZSCHLITZ trapping screw	00713309	001		
43	SCHRAUBE worm	00730025	002		
44	SCHRAUBE worm	00730028	001		
45	BOLZEN F. ZAHNRAD Bolt for gear	00730504	002		
46	BOLZEN F. KUPPELSTANGE bolt for coupling rod	00730565	002		
47	STECKPUFFER plug-in buffer	00757002	002		
48	BLATTRICHTFEDER F.KUPPLUNG N Flat straightening spring for coupling	00767006	001		
49	ERSATZ-SCHLEIFKOHLEN carbon brushes set	6518	---		
50	ERS.-GLUEHLAMPE KLAR M.STECKFA blub clear with Screw-type bulb	00006535	008		
51	STANDARD-KUPPLUNG standard coupling	9522	---		