

716084 BR 38 DRG		DCC	=	N
Pos. Nr. Pos.no.	Beschreibung Description	Art.-Nr. Art.no.	Preisgruppe Price bracket	
1	LOKGEHÄUSE KPL. Body assembly complete	10716084	031	
2	LICHTLEITER light conductor	00137159	006	
3	GLOCKE bell	00197502	004	
4	TENDERGEHÄUSE KPL. Tender body complete	20716004	019	
5	TENDERBODENRAHMEN KPL. Tender body complete	21716002	015	
6	TENDERBESCHWERUNG BR 38 P8 tender weight	26716002	011	
7	LOKFAHRGESTELL KPL. Loco chassis complete	30716082	038	
8	LOKFAHRGESTELL MIT RÄDERN loco chassis w/it wheel	31716002	030	
9	KREUZKÖPFE MIT VERBUNDSTANGEN cross head w/shank stick	32716002	019	
10	DECKPLATTE UNTEN cover plate bottomside	33716002	006	
11	KUPPELLASCHE coupling tongue	00347160	002	
12	VORLAUFGEHÄUSE KPL. Front bogie complete	37716002	016	
13	ADAPTER adapter	38701700	006	
14	TENDERFAHRGESTELL KPL. OHNE MO tender chassis complete w/ motor	40716002	031	
15	TENDERFAHRGESTELL MIT ZAHNRAD tender chassis w/ gear wheel	41716002	---	
16	MOTOR O.SCHW.M.MASSEKONTAKT motor w/o flywheel and weight contact	50716082	029	
17	KOHLLENHALTER carbon brush holder	00507801	001	
18	TENDERRAD O.Z.M.N.ISO. Tender wheel with isolation	51709900	008	
19	TENDERRAD O.N.O.Z.UGR. driving wheel w/o traction tyre w/o gear wheel	51710000	007	
20	LOKRAD M.H. GR.SCHWUNGMASSE UG loco wheel flywheel-weight	51710900	007	
21	LOKRAD M.H. KL.SCHWUNGMASSE UG loco wheel flywheel-weight	51711000	007	
22	TENDERRAD M.N. M.Z. UGR. Tender wheel with traction tyre and gear wheel	51711100	006	
23	TENDERRAD O.N. M.Z. UGR. Tender wheel w/o traction tyre and gear wheel	51711200	007	
24	TENDERRAD O.N. O.Z. UGR. driving wheel w/o traction tyre w/o gear wheel	51714300	---	
25	ACHSE axel	00527011	001	
26	ZAHNRAD Z:10 gear wheel	00527160	005	
27	RADSATZ KPL. Wheel set complete	53710400	015	
28	HAFTREIFEN traction tyre	00547001	001	
29	ZAHNRAD Z:14 SCHWARZ gear wheel black	00567106	004	
30	ZAHNRAD Z:20/20 SCHWARZ gear wheel black	00567107	006	
31	ZAHNRAD 04/12 gear wheel	56718200	---	
32	SCHNECKE D = 4MM L = 5MM worm	00567601	007	
33	STROMABNEHMEREINSATZ KPL.M.ZYL Power pick-up assembly	60716082	031	
34	HALTER F.DECODER 87160 holder for decoder	00627160	007	

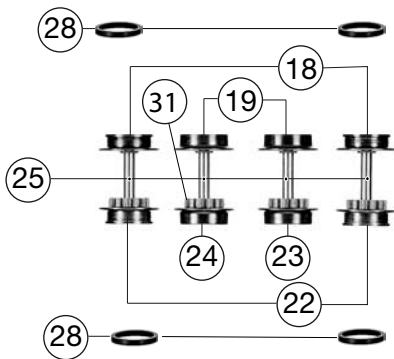
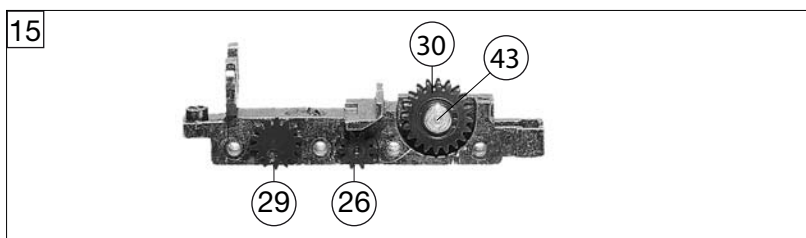
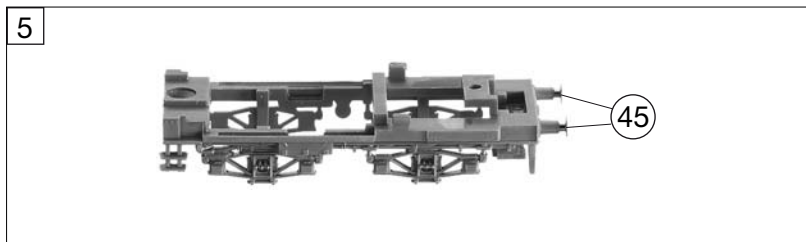
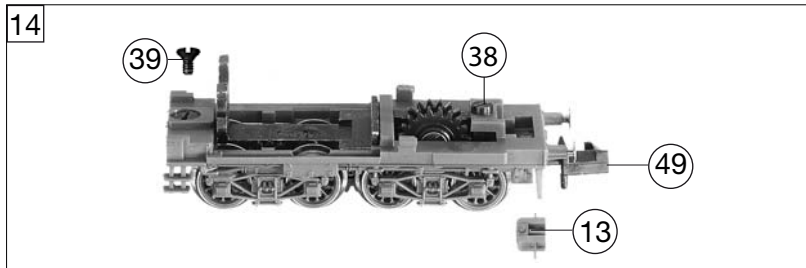
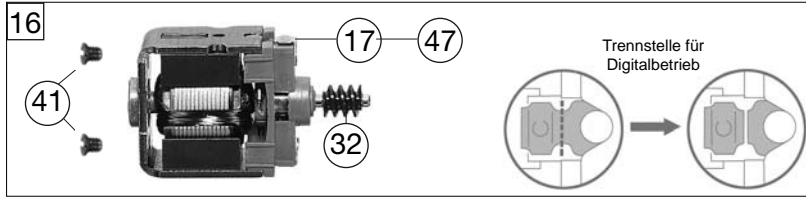
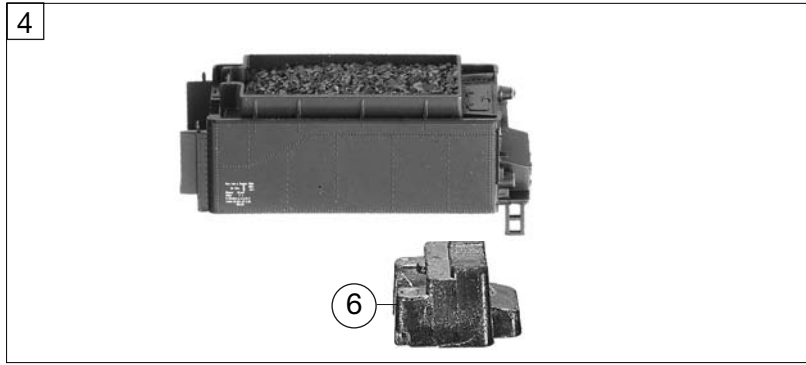

716084		BR 38 DRG		DCC	=	N
Pos. Nr. Pos. no.	Beschreibung Description	Art.-Nr. Art. no.	Preisgruppe Price bracket			
	HALTEPLATTE (KÜHLUNG) Mounting plate for cooling	62716082	007			
34	ENTSTOERDROSSEL Suppressor choke	00644101	007			
35	ENTSTOERKONDENSATOR Anti-noise capacitor	00644202	006			
36	SCHALTPL.TENDER 7159/63/70-73 Switch plate complete	00657003	019			
37	SCHRAUBE M 1,4 X 3 Screw	00700203	001			
38	SENKSCHRAUBE KS Countersunk screw	00702303	001			
39	SCHRAUBE Screw	00702304	001			
40	BLECHSCHRAUBE M.KREUZSCHLITZ tapping screw	00713309	001			
41	SCHRAUBE Screw	00730025	002			
42	SCHRAUBE Screw	00730028	001			
43	BOLZEN F. ZAHNRAD Bolt for gear wheel	00730504	002			
44	BOLZEN F. KUPPELSTANGE bolt for coupling rod	00730565	002			
45	STECKPUFFER plug-in buffer	00757002	002			
46	BLATTRICHTFEDER F.KUPPLUNG N Flat straightening spring for coupling	00767006	001			
47	ERSATZ-SCHLEIFKOHLEN carbon brushes set	6518	---			
48	ERS.-GLUEHLAMPE KLAR M.STECKFA Replacement bulb,clear,with plug-in socket	00006535	008			
	STANDARD-KUPPLUNG standard coupling	9522	---			
	STANDARD-STECKKUPPLUNG standard coupling	9525	---			