

716901 BR BR 01.10 ÖI DB			
Pos. Nr. Pos.no.	Beschreibung Description	Art.-Nr. Art.no.	Preisgruppe Price bracket
1	LOKGEHÄUSE KPL. Body assembly complete	10716901	028
2	UMLAUFBLECH F.7169 M.SS running board	01171711	024
3	LICHTLEITER light conductor	00137171	006
4	KUPPLUNGSHAKEN F.7170,7171 coupling hook	00197701	003
5	TOPFANTENNE pot antenna	00197801	003
6	TENDERGEHÄUSE KPL. Tender body complete	20716901	019
7	TENDER-RAHMEN F.7169/72/74 S tender framework	00217172	018
8	LICHTLEITER/TENDER 7172 light conductor tender	00237171	006
9	TENDERBESCHW.7169/71/72 S tender balast	00267172	012
10	LOKFAHRGESTELL F.7169S loco chassis	03071711	039
11	LOKFAHRGESTELL MIT RÄDERN loco chassis with wheels	00317172	028
12	KREUZKOEPFEN U. KUPPELSTANGEN S. Cross head and coupling stick	03271721	018
13	DECKPLATTE UNTEN F.7171/2/3 S cover plate under side	00337172	007
14	KUPPELLASCHE coupling tongue	00347171	004
15	VORLAUFGEST.M.ANDR.FED. 7170/1 carrying wheels with drive wheel	00377160	016
16	SCHLEPPGESTELL drag chassis	00397170	018
17	TENDERFAHRGESTELL F.7169/7172 tender chassis	00407172	031
18	TENDERFAHRGESTELL M.Z. Tender chassis	00417170	018
19	MOTOR O.SCHW.O.MASSEKONTAKT motor with flywheel w/weight contact	05071601	027
20	KOHLLENHALTER brush holder	00507801	001
21	TENDERRAD O.Z.M.N.ISO.ROT tender wheel red	00517003	006
22	TENDERRAD M.Z.M.N.ISO.ROT tender wheel red	00517004	006
23	TREIBRAD GR.GEGENGEW.ROT driving wheel counterwhigt red	00517011	007
24	KUPPELRAD KL.GEGENGEW.ROT coupling wheel small counterwhigt red	00517012	007
25	TENDERRAD O.Z.O.N.ISO.ROT tender wheel w/o contact red	00517013	007
26	TENDERRAD M.Z.O.N.ISO. ROT tender wheel red	00517017	007
27	ACHSE axel	00527001	002
28	ZAHNRAD M.METALLACHSE Z=12 gear wheel with metall axel	00527171	006
29	V.+ NACHLAUFRADSATZ carrying wheel set complete	00537007	011
30	NACHLAUFRADS.7123/70/71 carrying wheel set	00537020	012
31	HAFTREIFEN traction tyre	00547001	001
32	ZAHNRAD Z:14 SCHWARZ gear wheel black	00567106	004
33	ZAHNRAD Z:20/20 SCHWARZ gear wheel black	00567107	006
34	SCHNECKE D = 4MM L = 5MM worm	00567601	007

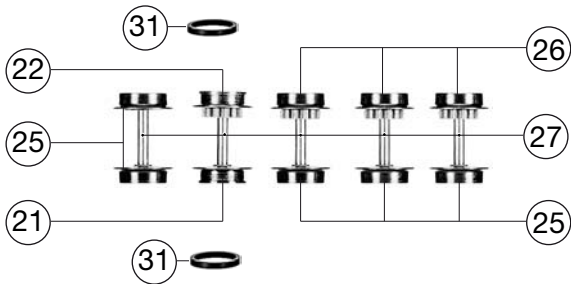
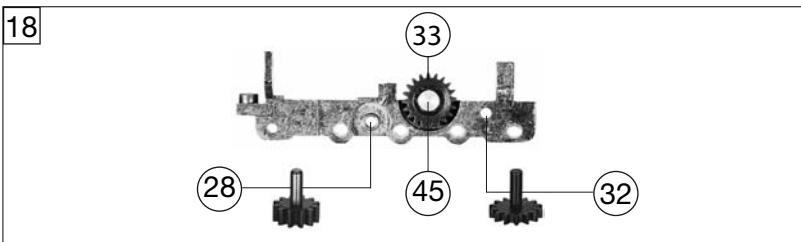
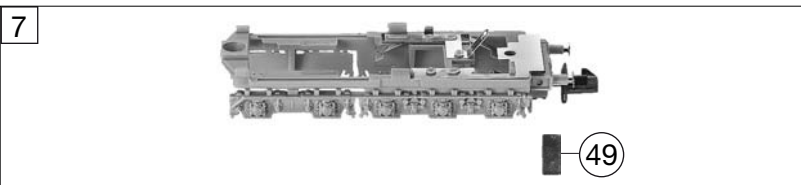
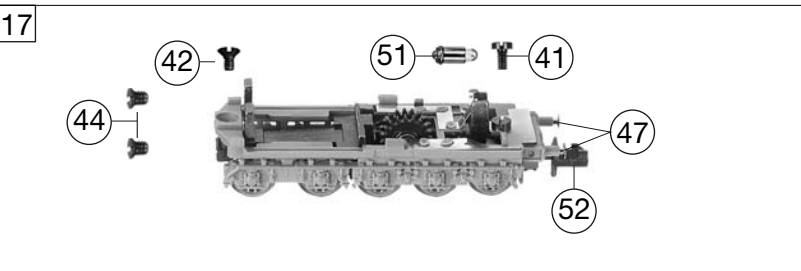
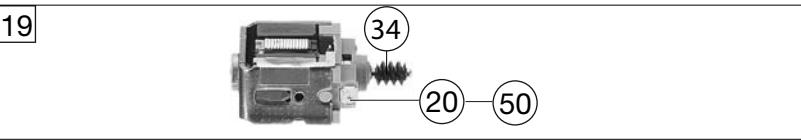
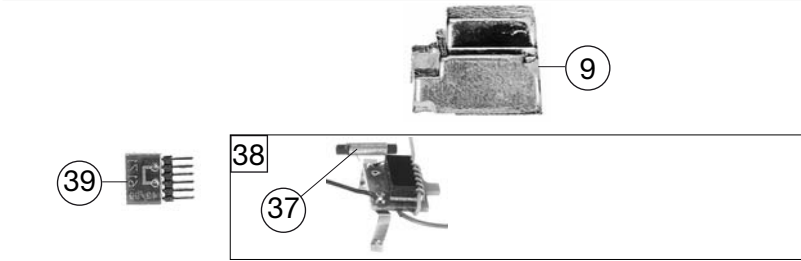
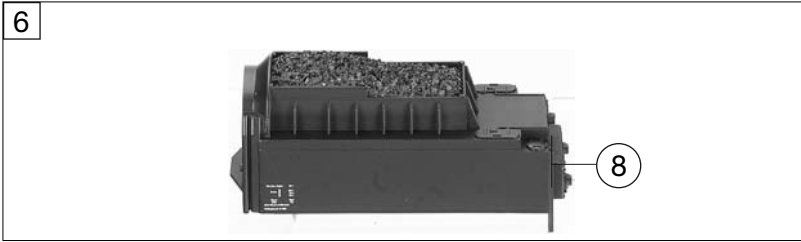

716901		BR 01.10 ÖI DB	NEM	N
Pos. Nr. Pos. no.	Beschreibung Description	Art.-Nr. Art. no.	Preisgruppe Price bracket	
35	STROMABNEHMEREINS.F.7171/7172S power pick-up assembly	06071711	028	
36	ABSTANDSHALTER move holder	00627172	006	
37	ENTSTOERDROSSEL suppressor choke	00644101	007	
38	SCHALTPL.TENDER F.7171/2/3 S switch plate tender complete	00657084	024	
39	SCHNITTST.-BLINDSTECKER 6-POL. Jumper (interface) bild 6-pin	00664002	013	
40	SCHRAUBE M 1,4 X 3 screw	00700203	001	
41	SCHRAUBE screw	00700303	001	
42	SCHRAUBE screw	00702304	001	
43	BLECHSCHRAUBE M.KREUZSCHLITZ tapping screw	00713309	001	
44	SCHRAUBE screw	00730025	002	
45	BOLZEN F. ZAHNRAD Flanged bolt for gear wheel	00730504	002	
46	BOLZEN F. KUPPELSTANGE bolt for coupling rod	00730565	002	
47	STECKPUFFER plug-in buffer	00757002	002	
48	ANDRUCKFEDER F.VORLAUFGESTELL pressure spring for carring wheel	00767002	001	
49	BLATTRICHTFEDER F.KUPPLUNG N flat straightening spring for coupling	00767006	001	
50	ERSATZ-SCHLEIFKOHLEN carbon brushes set	6518	---	
51	ERS.-GLUEHLAMPE KLAR M.STECKFA blub clear w/ jack	00006535	008	
52	STANDARD-KUPPLUNG standard coupling	9521	---	
--	PROFI-KUPPLUNG profi coupling	9541	---	