

717471 BR 01.10 DRB		=		N
Pos. Nr. Pos.no.	Beschreibung Description	Art.-Nr. Art.no.	Preisgruppe Price bracket	
1	Lokgehäuse kpl. Body assembly complete	10717471	---	
2	LICHTLEITER running board	00137172	006	
3	BESCHWERUNG ballast	16781201	---	
4	DAMPFFEIFE schw.vern. Steam wistle	19763400	---	
5	TENDERGEHÄUSE KPL. tender chassis complete	20717471	---	
6	TENDER-RAHMEN F.7169/72/74 S loco framework	00217172	018	
7	LICHTLEITER/TENDER 7169/73/74 light conductor / tender	00237170	006	
8	TENDERBESCHW.7169/71/72 S tender balast	00267172	012	
9	LOKFAHRGESTELL KPL. Loco chassis complete	30781201	---	
10	LOKFAHRGESTELL MIT RÄDERN loco chassis complete with wheels	31781201	---	
11	KREUZKOEPF E U.KUPPELSTANGEN S. Cross-head and coupling rod	00327174	019	
12	DECKPLATTE UNTEN F.7171/2/3 S cover plate bottom side	00337172	007	
13	KUPPELLASCHE coupled lash	00347171	004	
14	VORLAUFGESTELL F.BR 01 STROML. Bogie with power	00377172	016	
15	SCHLEPPGESTELL drag chassis	00397172	012	
16	TENDERFAHRGESTELL F.7169/7172 tender chassis	00407172	031	
17	TENDERFAHRGESTELL M.Z. Tender chassis with gear wheel	00417170	018	
18	MOTOR motor	50716082	029	
19	KOHLENHALTER carbon brush holder	00507801	001	
20	TENDERRAD O.Z.M.N.ISO.ROT Tender wheelset w/o gear, w/ traction tyre	00517003	006	
21	TENDERRAD M.Z.M.N.ISO ROT Tender wheelset w/ gear, w/ traction tyre	00517004	006	
22	TREIBRAD GR.GEGENGEW.ROT coupled wheel, big drilling, counterweight, red	00517011	007	
23	KUPPELRAD KL.GEGENGEW.ROT coupled wheel, small drilling, counterweight, red	00517012	007	
24	TENDERRAD O.Z.O.N.ISO.ROT Tender wheelset w/o gear, w/o traction tyre isul	00517013	007	
25	TENDERRAD M.Z.O.N.ISO. ROT Tender wheelset w/ gear, w/o traction tyre	00517017	007	
26	L.RAD F.VOR.-NACHLAUF ISO loco wheel carrying wheelset isolated	00517038	006	
27	ACHSE axel	00527001	002	
28	ACHSE axel	00527004	001	
29	ZAHNRAD M.METALLACHSE Z=12 gear wheel w/ metall lash	00527171	006	
30	V.+ NACHLAUFRADSATZ Carrying wheelset complete	00537007	011	
31	VORLAUFRADSATZ F.E 32/BR 56 set of carrying wheel set	00537011	011	
32	HAFTREIFEN traction tyre	00547001	001	
33	ZAHNRAD Z:14 SCHWARZ gear wheel	00567106	004	
34	ZAHNRAD Z:20/20 SCHWARZ gear wheel	00567107	006	

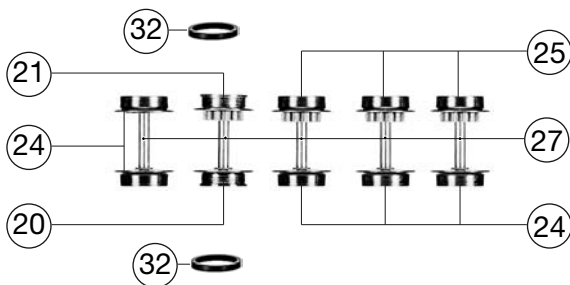

717471		BR 01.10 DRB		=	N
Pos. Nr. Pos. no.	Beschreibung Description	Art.-Nr. Art. no.	Preisgruppe Price bracket		
35	SCHNECKE D = 4MM L = 5MM worm	00567601	007		
36	STROMABNEHMEREINSATZ MIT LICHT Power pick-up assembly with light	60781201	---		
37	ENTSTOERPLATINE suppressor platine	65715700	---		
38	LEITERPLATTE PCB	65715800	---		
39	HALTEBÜGEL FÜR LAUTSPRECHER interface for loud speaker	68700500	---		
40	Lautsprecher 9,6 x 13,6 x 2,9 loud speaker	68700700	---		
41	LAUTSPRECHERAUFNAHME record for loud speaker	68700900	---		
42	SOUNDDECODER sound decoder	68717471	---		
43	SCHRAUBE M 1,4 X 3 worm	00700203	001		
44	SCHRAUBE worm	00700204	002		
45	SCHRAUBE worm	00700303	001		
46	SCHRAUBE worm	00700304	001		
47	SCHRAUBE worm	00702304	001		
48	BLECHSCHRAUBE M.KREUZSCHLITZ trapping screw	00713309	001		
49	SCHRAUBE worm	00730025	002		
50	BOLZEN F. ZAHNRAD bolt for gear wheel	00730504	002		
51	BOLZEN F. KUPPELSTANGE Bolt for coupling rod	00730565	002		
52	BOLZEN F. KUPPELSTANGE Bolt for coupling rod	00730566	002		
53	STECKPUFFER plug-in buffer	00757002	002		
54	ANDRÜCKFEDER F.VORLAUFGESTELL pressure spring for front bogie	00767002	001		
55	ANDRÜCKFEDER F.NACHLAUF 7173 pressure spring for rear bogie	00767003	001		
56	BLATTRICHTFEDER F.KUPPLUNG N Flat straightening spring for coupling	00767006	001		
57	ERSATZ-SCHLEIFKOHLEN carbon brushes set	6518	---		
58	ERS.-GLUEHLAMPE KLAR M.STECKFA Replacement bulb, clear, with plug-in socket	00006535	008		
59	STANDARD-KUPPLUNG standard coupling	9521	---		
--	PROFI-KUPPLUNG profi coupling	9541	---		
--	PROFI-KUPPLUNG VERKÜRZT profi coupling shortende	9543	---		

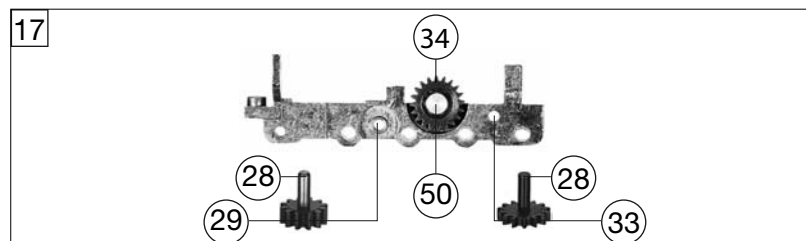
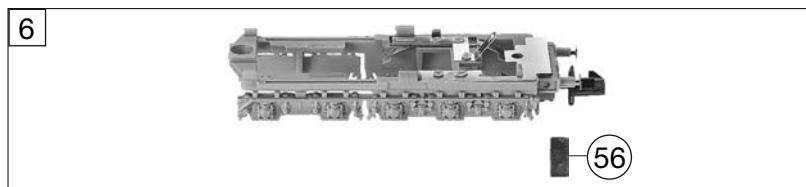
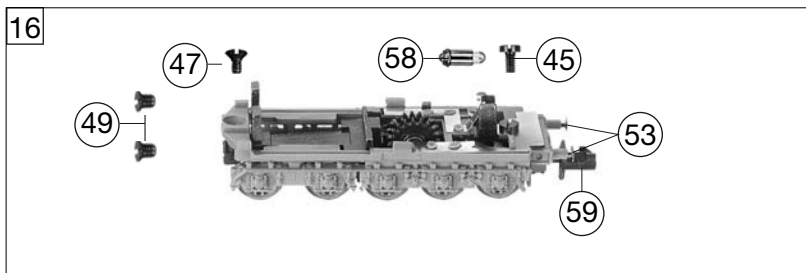
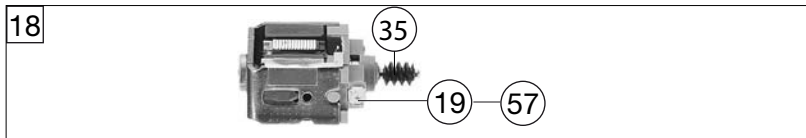