

718402	BR 50	50 981	DB	=	N
Pos. Nr. Pos.no.	Beschreibung Description		Art.-Nr. Art.no.	Preisgruppe Price bracket	
1	LOKGEHÄUSE KPL. Loco body complete		10718402	---	
2	UMLAUFBLECH Running board		00117184	19	
3	LICHTLEITER-SATZ Light conductor set		00137181	11	
4	KLEINTEILE-SATZ Set of small parts		00197181	7	
5	GRIFFSTANGEN F.TENDER Tender handrails		00197704	5	
6	TENDERGEHÄUSE KPL. Tender body complete		20718402	---	
7	TENDERRAHMEN KPL. Tender frame complete		21718402	---	
8	LICHTLEITER/TENDER Light conductor for tender		00237182	4	
9	TENDERBESCHWERUNG Tender ballast		02671821	15	
10	LOKFAHRGESTELL KPL. Loco chassis complete		30718402	---	
11	LOKFAHRGESTELL MIT RÄDER Loco chassis with wheels		31718402	---	
12	STEUERUNG KPL.SCHWARZ VERN. Reversing gear complete, darkened		00327184	28	
13	DECKPLATTE UNTEN Bottom cover plate		00337184	6	
14	LOK-TENDER KURZ-KUPPLUNG Loco-tender short coupling		00347181	5	
15	VORLAUFGESELL KPL. Set of carrying wheels (front)		37718402	---	
16	ADAPTER F.DAMPFLOKS (Tender) Steam loco coupling adapter (tender)		00387003	7	
17	TENDERFAHRGESTELL KPL. OHNE MOTOR Tender chassis complete, w/o motor		40718402	---	
18	TENDERFAHRGESTELL M.Z. Tender chassis with gearset		00417181	20	
19	TENDERDECKPLATTE UNTEN Bottom tender cover plate		00437181	6	
20	ZYLINDERKASTEN/SATZ Cylinder box set, complete with boiler support		00487182	18	
21	MOTOR M.SCHW.M.MASSEKONTAKT Motor complete with flywheel, with ground cont.		00507181	28	
22	KOHLENHALTER Carbon brush holder		00507801	1	
23	TENDERRAD O.Z.M.N.ISO.ROT Tender wheel w/o gear, with trac. tyre, insul, red		00517003	6	
24	TENDERRAD M.Z.M.N.ISO.ROT Tender wheel with gear, with trac. tyre, insul, red		00517004	6	
25	TENDERRAD O.Z.O.N.ISO.ROT Tender wheel w/o gear, w/o trac. tyre, insul, red		00517013	7	
26	TENDERRAD M.Z.O.N.ISO.ROT Tender wheel with gear, w/o trac. tyre, insul, red		00517017	7	
27	TREIBRAD LINKS F.BR 50 4-DOM. Left driving wheel		00517072	8	
28	TREIBRAD RECHTS NIEDR.SPURKR. Right driving wheel, low flanges		00517073	8	
29	KUPPELRAD NIEDR.SPURKRANZ Coupled wheel, low flanges		00517074	8	
30	ACHSE Axle		00527007	1	
31	VORLAUF-SCHEIBEN-RS BR 50 KAB Forward carrying wheelsset (disc type wheels)		00537066	12	
32	HAFTREIFEN Traction tyre		00547001	1	
33	ZAHNRAD Z:16 SCHWARZ Gear wheel Z=16, black		00567104	3	
34	ZAHNRAD Z:14/22 SCHWARZ Gear wheel Z=14/22, black		00567113	2	
35	ZAHNRAD Z:17 SCHWARZ Gear wheel Z=17, black		00567147	6	
36	SCHNECKE D = 4MM L = 5MM Worm gear		00567601	7	
37	STROMABNEHMEREINSATZ KPL. Power pick-up, complete		00607181	13	

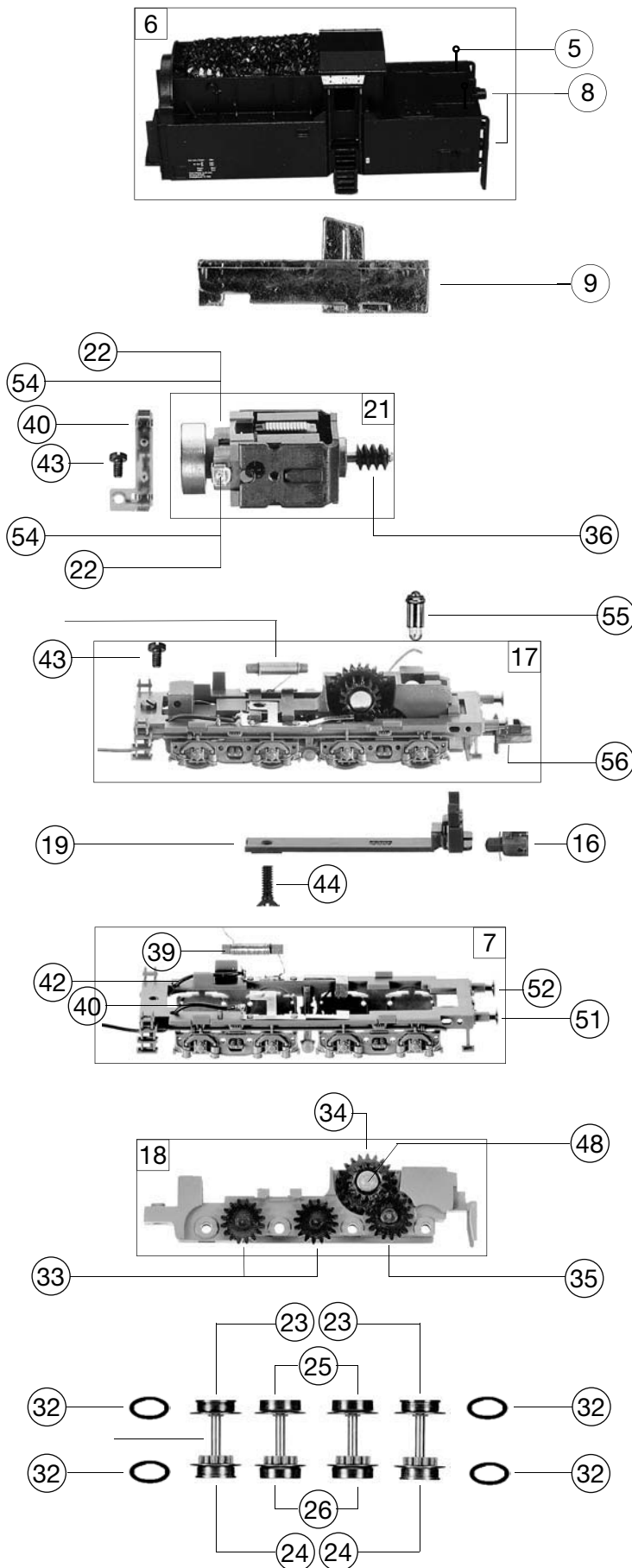

718402	BR 50	50 981	DB	=	N
Pos. Nr. Pos.no.	Beschreibung Description		Art.-Nr. Art.no.	Preisgruppe Price bracket	
38	LAMPENHALTER M.BELEUCHTUNGSFE. Lamp holder with contact spring		00637181	11	
39	ENTSTOERDROSSEL Suppressor choke		00644101	7	
40	SCHALTPLATTE TEND.KPL.F.BR 50 Tender PCB, complete		00657095	18	
41	SCHALTLEITZE SCHWARZ 350 MM Connecting cable, black, 350 mm long		00667000	9	
42	SCHALTLEITZE BRAUN 350 MM Connecting cable, brown, 350 mm long		00667001	9	
43	SCHRAUBE M 1,4 X 3 Metric screw M 1.4x3		00700203	1	
44	SENKSCHR.F.MOTOR Countersunk screw for motor		00702908	1	
45	LINSENSCHRAUBE Button screw		00704902	2	
46	LINSENSCHRAUBE Button screw		00704904	2	
47	BLECHSCHRAUBE M.KREUZSCHLITZ Phillips screw		00713309	1	
48	BOLZEN F. ZAHNRAD Bolt for gear wheel		00730504	2	
49	BOLZEN F.KUPPELSTANGE Bolt for coupling rod		00730562	2	
50	BOLZEN F. KUPPELSTANGE Bolt for coupling rod		00730570	1	
51	STECKPUFFER (GEWÖLBT) Plug-in buffer, curved		00757011	2	
52	STECKPUFFER (FLACH) Plug-in buffer, flat		00757012	2	
53	DRUCKFEDER F.LOK-TENDER-KUKU Pressure spring for loco-tender coupling		00767012	1	
54	ERSATZ-SCHLEIFKOHLEN Spare carbon brushes		6518	---	
55	ERS.-GLUEHLAMPE KLAR M.STECKFA Clear bulb with plug-in socket		00006535	8	
56	STANDARD-STECKKUPPLUNG Standard plug-in coupling		9525	---	
	PROFI-STECKKUPPLUNG (o. Abb.) Profi plug-in coupling (w/o illustr.)		9545	---	