

| 742272 | 5022 | ÖBB | ☞ | ≡ | N |
|---------------------|---|---------------------|------------------------------|---|---|
| Pos. Nr. Pos.no. | Beschreibung Description | Art.-Nr. Art.no. | Preisgruppe Price bracket | | |
| 1 | GEHÄUSE F. TRIEBWAGEN M. MOTOR Motor-railcar housing | 10742202 | --- | | |
| 2 | INNENEINRICHTUNG F. Triebw. m.M. Interior fittings | 11742077 | 9 | | |
| 3 | FALTENBALG Gangway bellows | 00128118 | 7 | | |
| 4 | LICHTLEITER-FÜHRERSTAND-SATZ Light conductor&driver's cab | 13742202 | --- | | |
| 5 | FENSTER-SATZ F. MOT. WAGEN Motor coach window -set | 14742202 | --- | | |
| 6 | FENSTER-SATZ F. TW O. MOTOR Trailer coach window set | 147422021 | --- | | |
| 7 | BESCHWERUNG MIT BUCHSE Ballast | 00167422 | 12 | | |
| 8 | KUPPLUNGSATTRAPPE F. 7420 Coupling imitation | 00197708 | 6 | | |
| 9 | ABGASHÜTZEN SILBER F. 7420 Exhaust silencer | 00197828 | 5 | | |
| 10 | GEHÄUSE F. Triebw. ohne Motor Railcar housing w/o Motor | 20742202 | --- | | |
| 11 | INNENEINRICHTUNG F. TK O. MOTOR Interior fittings for motor coach body | 00257420 | 9 | | |
| 12 | WAGENBODEN-EINSATZ-SATZ F. TRIE Set of floor plates | 30742202 | --- | | |
| 13 | WAGENBODEN-EINSATZ-SATZ FÜR TR Set of floor plates | 307422021 | --- | | |
| 14 | JAKOBS-DREHGEST. 7420 JAKOBS bogie | 00317420 | 13 | | |
| 15 | SCHÜRZEN-SATZ Skirts set | 00337420 | 14 | | |
| 16 | KUPPLUNGSADAPTER Coupling adaptor | 00387012 | 5 | | |
| 17 | FAHRGESTELL F. TRIEBWAGEN MIT Chassis for railcar with motor | 00407420 | 14 | | |
| 18 | FAHRGESTELL F. TRIEBWAGEN OHNE Chassis for railcar w/o motor | 04074201 | 13 | | |
| 19 | DREHGESTELLRAHMEN Bogie framework | 00417420 | 7 | | |
| 20 | DREHGEST.BLOCK KPL. F. TRIEBW Bogie block | 00457420 | 17 | | |
| 21 | DREHGESTELLBLOCK KPL. F. TRIEB Bogie block | 00467420 | 12 | | |

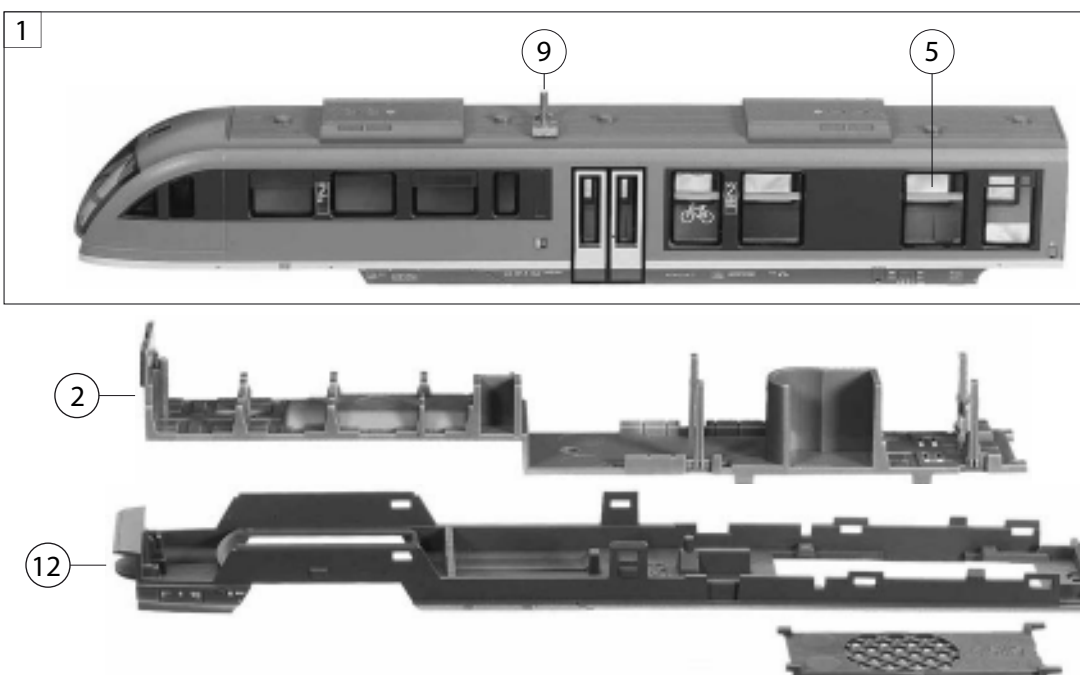

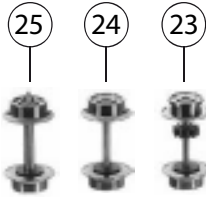
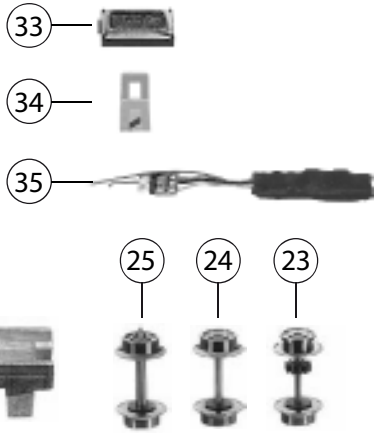
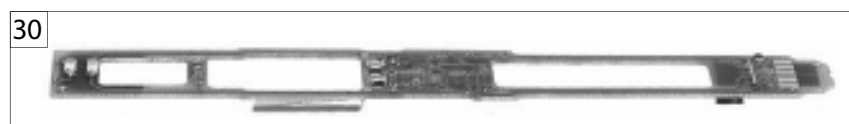
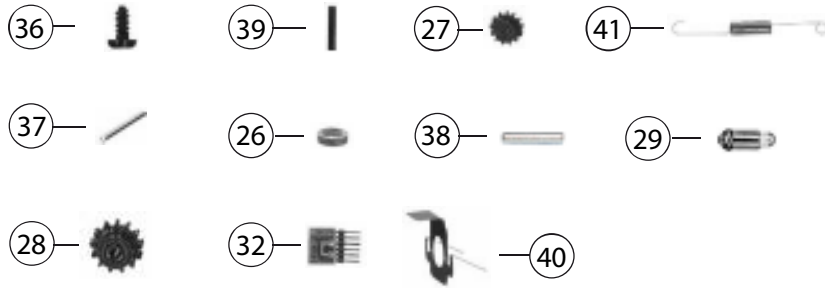

| 742272 | 5022 | ÖBB | | N |
|---------------------|---|---------------------|------------------------------|---|
| Pos. Nr. Pos.no. | Beschreibung Description | Art.-Nr. Art.no. | Preisgruppe Price bracket | |
| 22 | MOTOR Motor | 50742007 | 29 | |
| 23 | RADSATZ KPL. Wheelset complete | 00537090 | 12 | |
| 24 | RADSATZ KPL. Wheelset complete | 00537091 | 7 | |
| 25 | RADSATZ KPL. Wheelset complete | 53712500 | 7 | |
| 26 | HAFTREIFEN F. DESIRO Traction tyre | 00547006 | 1 | |
| 27 | Untersetzungsrad Z:14/9 sw RO Reduction gear wheel | 00567145 | 6 | |
| 28 | ZAHNRAD Z:16 M0.3 F.7420 Gear wheel | 00567154 | 6 | |
| 29 | GLÜHLAMPE KLAR 16 V 35 mA Bulb clear | 00627420 | 9 | |
| 30 | SCHALTPLATTE M.SS F.7420 PCB with interface | 00657098 | 27 | |
| 31 | SCHALTPLATTE FÜR TRIEBWAGEN OH PCB for Railcar | 00657099 | 20 | |
| 32 | STECKER 6-POLIG 6-pin jumper | 00666846 | 15 | |
| 33 | LAUTSPRECH.9x16 Fox m.Klebeпад Loudspeaker | 68701100 | 16 | |
| 34 | HALTEBÜGEL FÜR LAUTSPRECHER Loudspeaker fixation | 68700600 | 5 | |
| 35 | SOUND-DECODER m.6 pol.Stecker Sound Decoder | 68742077 | --- | |
| 36 | LINSENSCHRAUBE M1.6X6 F.7420 Button screw | 00704906 | 3 | |
| 37 | Achse f. Zahnrad RO Axle for gear wheel | 00730541 | 1 | |
| 38 | ACHSE Axle | 00730573 | 1 | |
| 39 | BLATTTRICHTFEDER L=9,5MM Flat straightening spring | 00764007 | 1 | |
| 40 | KONTAKTFEDER Contact spring | 00767015 | 1 | |
| 41 | ZUGFEDER F.7420 Draw spring | 00767103 | 9 | |
| | PROFI-STECKKUPPLUNG (o. Abb) Profi coupling (w/o illustration) | 9545 | --- | |