

74230	BR V100 DB	V1002079	=	HO
Pos. Nr. Pos.no.	Beschreibung Description	Art.-Nr. Art.no.		Preisgruppe Price bracket
1	LOKGEH.O.DACH F.74230 Body assembly complete, w/o roof	01042301		029
2	LOKRAHMEN F.74230 Loco framework	01142301		031
3	DACH F.74230 Roof	01242301		014
4	LICHTLEITER Light conductor	00134230		007
5	BUEHNENGELENDER Platform hand rail	00144230		007
6	FENSTER-SATZ F.74230 Set of windows	01542301		014
7	BESCHWERUNG Ballast	00164230		012
8	BESCHWERUNG F 74230 Ballast	01642301		016
9	LAUFDREHGESTELL O.RAHMEN Bogie	00304231		024
10	DREHGEST.RAHMEN F.4215/28/30 Bogie framework	00310230		016
11	MOTORDREHGEST.M.SCH.F.74230 Motor with flywheel, complete	04042301		035
12	DREHGEST.RAHMEN F.MOTORDREHG. Bogie framework	00410230		016
13	MOTOR F.74230 Motor	05042301		033
14	ANKER KPL.M.SCHWUNGMASSE Rotor complete with integr. flywheel	00504607		025
15	LAGERSCHILD ISOL. Motor PCB, insulated	00504741		017
16	KOHLLENROHRKAPPE Brush pipe cap	00504801		002
17	L.RAD O.Z.O.N.ISO Wheel w/o gear wheel, w/o trac. tyre, insul.	00514182		006
18	L.RAD O.Z.M.N.ISO. Wheel w/o gear wheel, with trac. tyre, insul.	00514183		006
19	L.RAD M.Z.M.N. Wheel with gear wheel, with trac. tyre	00514209		007
20	L.RAD M.Z.O.N. Wheel complete with gear wheel, w/o trac.	00514232		007
21	ACHSE GERAENDELT 20 MM Milled axle	00524006		002
22	HAFTREIFEN HO Traction tyre	00544007		001
23	UNTERSETZUNGSRAD Z:28/13 SCHWA Reduction gear wheel Z:28/13 black	00564102		002
24	ZWISCHENRAD Z:18 SCHWARZ Gear wheel Z:18 black	00564105		002
25	RITZEL Z:10 Gear wheel Z:10	00564602		004
26	SICHERUNGSRING KLEIN Securing ring, small	00564701		001
27	SICHERUNGSRING GROSS Securing ring, big	00564702		001
	UNTERLEGSCH. 2,3 X 5 X 0,1 Washer 2,3 X 5 X 0,1	00564747		001
	UNTERLEGSCH.ROT 2,2X5X0,3 Washer 2,2X5X0,3, red	00564751		001
30	STROMABNEHMER ISOL. Power pick-up, insulated	00614005		007
31	STROMABNEHMER Power pick-up	00614012		007
32	MASSEFEDER Ground contact	00614934		001
33	MOTORSTROMABN.F.4215/28/29/30 Motor contact clip	00614935		001
34	LAMPENHALTER F."V 60 U.V 100" Lamp support complete f. "V 60 U.V 100"	00624335		011
35	ENTSTOERDROSSEL Suppressor choke	00644101		007
36	KONTAKTPILZGARNITUR L:10 MM Contacter pin assembly L:10 MM	00644401		011
37	SCHRAUBE Screw	00700313		001

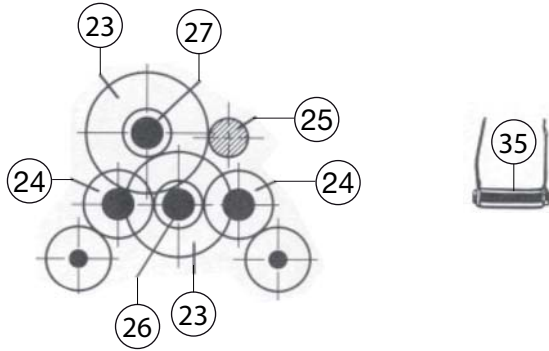
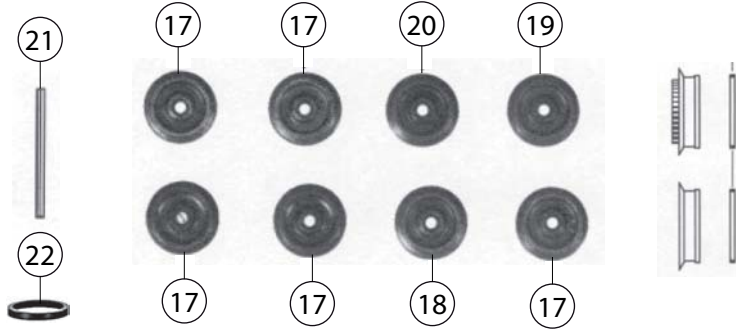
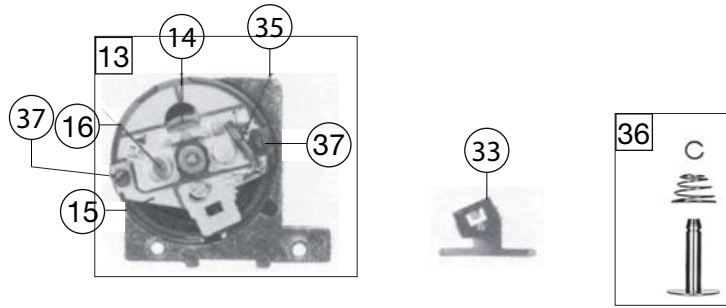

74230		BR V100 DB	V1002079	=	HO
Pos. Nr. Pos.no.	Beschreibung Description	Art.-Nr. Art.no.	Preisgruppe Price bracket		
38	ZYLINDERKOPFSCHRAUBE Cylinder head screw	00700403	001		
39	SCHRAUBE Screw	00701405	001		
40	SCHRAUBE Screw	00713516	001		
41	ANSATZSCHRAUBE Flanged screw	00730014	004		
42	SCHRAUBPUFFER MITTEL GEW. 4,5 Srew-in buffer	00754002	002		
43	BLATTRICHTFEDER L=14 MM Flat straightening spring l=14mm	00764012	002		
	PROFI-ZAPFENKUPPLUNG (o. Abb.) Profii button coupling (w/o illustr.)	6517	---		
	ERSATZ-SCHLEIFKOHLEN (o. Abb.) Carbon brushes (w/o illustr.)	6519	---		
	ZAPFENKUPPLUNG (o. Abb.) Fleischmann button coupling (w/o illustr.)	6521	---		
	ZAPFEN-TAUSCHKUPPLUNG (o. Abb.) Standard button coupling (w/o illustr.)	6524	---		
48	ERS.-GLÜHLAMPE M.SCHRAUBFAS. Spare bulb with screw base	00006530	007		