

74423	LINT Syntus 43	NS			HO
Pos. Nr. Pos.no.	Beschreibung Description	Art.-Nr. Art.no.	Preisgruppe Price bracket		
1	GEHAUESE F.MOT.TK 71423 SYNTUS Motor coach body	01044231	036		
2	FUEHRERSTAND M. LOKF. Driver's cab inset	00124420	012		
3	FALTENBALG F.4420 Gangway bellows	00125116	009		
4	LICHTLEITER-SATZ F.4420,4423 Light conductor set	00134420	009		
5	LICHTLEITER-SATZ F.71423 Light conductor set	01344231	011		
6	FENSTERSATZ F.TRIEBWAGEN M.MOT. Motor coach window -set	01444232	020		
7	FENSTERSATZ F.TRIEBWA. O.MOT. Window set for trailer coach	01444233	020		
8	INNENEINRICHTUNG F.74420 Interior fittings for motor coach	01544201	011		
9	BESCHWERUNG F.4420,4423 Ballast for power car	00164420	014		
10	BESCHWERUNG F.LINT O.MOTOR Ballast for trailer car	01644201	013		
11	SCHEIBENWISCHER,KUPPL.ATTR./S. Windshield wipers, coupling imitations-set	00194420	007		
12	ABGASHUTZEN F.4420,4423 Exhaust silencer	00194855	003		
13	GEH.M.STUFEN F.TK O.M.71423 Body with treadles for trailer car	02044231	036		
	TUERTRITTSTUFEN/SATZ F.4423 (o. Abb.) Set of treadles (w/o illustration)	00224423	009		
14	INNENEINRICHTUNG F.TK O.MOT. Interior fittings for trailer car	00254420	011		
15	JAKOBSDREHGESTELL F.4420,4423 JAKOBS bogie	00304420	018		
16	DREHGESTELLRAHMEN F.4420,4423 Bogie framework	00314420	009		
17	WAGENBODEN F.4423 F.TK M.MOT. Floor plate for motor coach	00334423	021		
18	DREHGEST.AUFN.F.JAKOBSDREHGEST Bogie reception connector	00384420	003		
19	KUPPELSTANGE F.4420,4423 Coupling rod	00386012	002		
20	DREHGESTELLRAHMEN F.LAUFGEST. Bogie framework	00414420	009		
21	WAGENBODEN F.4423 O.MOT. Floor plate for trailer car	00434423	021		
22	DREHGEST.BLOCK F.4420,4423 Bogie block	00454420	016		
23	LAUFDREHGEST.BLOCK F.4420,4423 Bogie block	00464420	013		
24	MOTOR KPL.M.SCHWUNGMASSE Motor with flywheel, complete	00504420	029		
25	KOEHLENHALTER Brush holder	00507801	001		
26	MOTORHALTEBUEGEL Motor retainer clip	00507903	004		
27	ACHSE Axle	00524014	002		
28	ACHSE Axle	00527001	002		
29	RADSATZ M.Z.M.1 N.F.4420,4423 Wheelset with gear wheel, with traction tyre	00534119	012		
30	RADSATZ EINS.ISO. 25MM F.4420 Wheelset single sided insulated	00534120	007		
31	RADSATZ O.Z.O.N.F.4420,4423 Wheelset w/o gear wheel, w/o traction tyre	00534121	012		
32	HAFTREIFEN H0 Traction tyre	00544011	001		
33	ZAHNRAD Z:16/0.4 Gear wheel	00564189	005		
34	ZAHNRAD Z:13 SCHWARZ Gear wheel	00567149	006		
35	SCHNECKE D = 4MM L = 5MM Worm gear	00567601	007		
36	KONTAKTBUEGEL SATZ F.4420,4423 Contact plate assy	00614978	008		

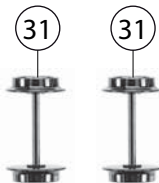
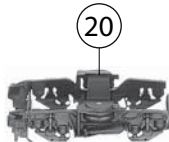
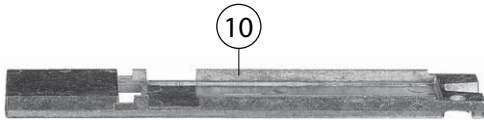
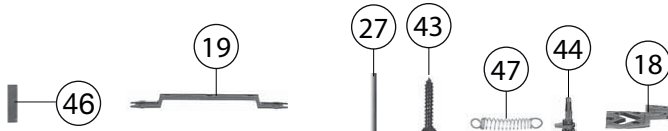
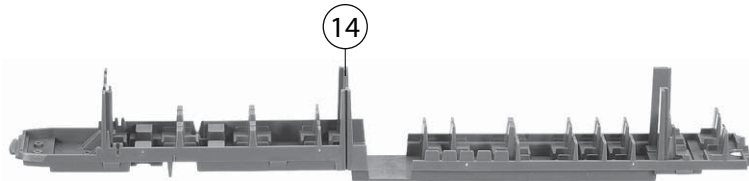
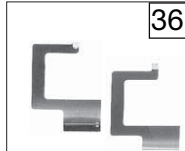
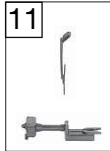
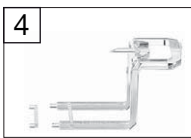
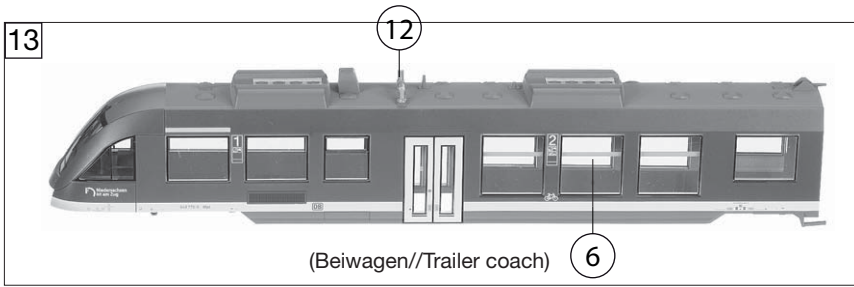

74423		LINT Syntus 43	NS	🔊	=	HO
Pos. Nr. Pos. no.	Beschreibung Description		Art.-Nr. Art. no.	Preisgruppe Price bracket		
37	KONTAKTPILZGARNITUR L:10 MM Contacter pin assembly		00644407	011		
38	MOTORLEITERPLATTE F.4420,4423 Motor PCB		00654108	018		
39	SCHALTPL.M.SS U.LICHTLEITER PCB with interface and light conductor		00654109	030		
40	LEITERPL.M.LICHTLEITER F.4420 PCB with light conductor		00654110	027		
42	FLACHLEITER M.STECKER 8-POL. Flat light conductor with jumper 8-pin		00664004	018		
43	SENKKOPFBLECHSCHR.2,2X16 KS Countersunk tapping screw		00714516	001		
44	SPLINT F. 4420,4423 Split pin		00730576	001		
45	SPLINT F. 4420,4423 Split pin		00730577	003		
46	BLATTRICHTFEDER L=14 MM Flat straightening spring		00764012	002		
47	ZUGFEDER F.4420,4423 Draw spring		00764115	002		
48	KONTAKTFEDER F.4420,4423 Contact spring		00764333	001		
	ERSATZ-SCHLEIFKOHLEN (o. Abb.) Carbon brushes set (w/o illustr.)		6518	---		