

781201 BR 01.10 DRB		NEM	==	N
Pos. Nr. Pos.no.	Beschreibung Description	Art.-Nr. Art.no.	Preisgruppe Price bracket	
1	Lokgehäuse kpl. Body assembly complete	10781201	027	
2	LICHTLEITER running board	00137172	006	
3	BESCHWERUNG ballast	16781201	---	
4	DAMPFPFEIFE schw.vern. Steam wistle	19763400	---	
5	TENDERGEHÄUSE KPL. tender chassis complete	20781201	---	
6	TENDER-RAHMEN F.7169/72/74 S loco framework	00217172	018	
7	LICHTLEITER/TENDER 7169/73/74 light conductor / tender	00237170	006	
8	TENDERBESCHW.7169/71/72 S tender ballast	00267172	012	
9	LOKFAHRGESTELL KPL. Loco chassis complete	30781201	---	
10	LOKFAHRGESTELL MIT RÄDERN loco chassis complete with wheels	31781201	---	
11	KREUZKOEPFEN U.KUPPELSTANGEN S. Cross-head and coupling rod	00327174	019	
12	DECKPLATTE UNTEN F.7171/2/3 S cover plate bottom side	00337172	007	
13	KUPPELLASCHE coupled lash	00347171	004	
14	VORLAUFGESTELL F.BR 01 STROML. Bogie with power	00377172	016	
15	SCHLEPPGESTELL drag chassis	00397172	012	
16	TENDERFAHRGESTELL F.7169/7172 tender chassis	00407172	031	
17	TENDERFAHRGESTELL M.Z. Tender chassis with gear wheel	00417170	018	
18	MOTOR O.SCHW.O.MASSEKONTAKT Motor with flywheel w/o ground conductor	05071601	027	
19	KOHLENHALTER carbon brush holder	00507801	001	
20	TENDERRAD O.Z.M.N.ISO.ROT Tender wheelset w/o gear, w/ traction tyre	00517003	006	
21	TENDERRAD M.Z.M.N.ISO.ROT Tender wheelset w/ gear, w/ traction tyre	00517004	006	
22	TREIBRAD GR.GEGENGEW.ROT coupled wheel, big drilling, counterweight, red	00517011	007	
23	KUPPELRAD KL.GEGENGEW.ROT coupled wheel, small drilling, counterweight, red	00517012	007	
24	TENDERRAD O.Z.O.N.ISO.ROT Tender wheelset w/o gear, w/o traction tyre isul	00517013	007	
25	TENDERRAD M.Z.O.N.ISO.ROT Tender wheelset w/ gear, w/o traction tyre	00517017	007	
26	L.RAD F.VOR.-NACHLAUF ISO loco wheel carrying wheelset isolated	00517038	006	
27	ACHSE axel	00527001	002	
28	ACHSE axel	00527004	001	
29	ZAHNRAD M.METALLACHSE Z=12 gear wheel w/ metall lash	00527171	006	
30	V.+ NACHLAUFRADSATZ Carrying wheelset complete	00537007	011	
31	VORLAUFRADSATZ F.E 32/BR 56 set of carrying wheel set	00537011	011	
32	HAFTREIFEN traction tyre	00547001	001	
33	ZAHNRAD Z:14 SCHWARZ gear wheel	00567106	004	
34	ZAHNRAD Z:20/20 SCHWARZ gear wheel	00567107	006	

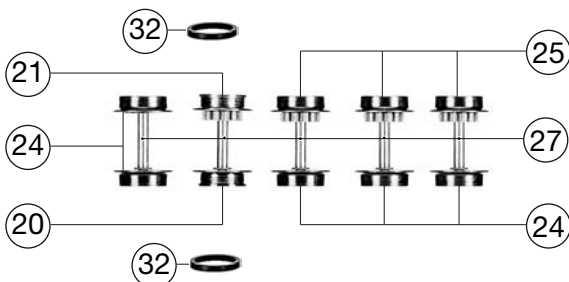
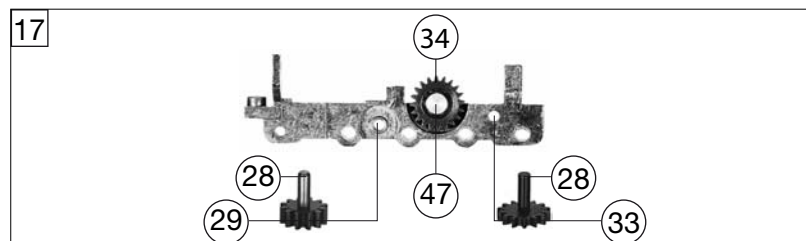
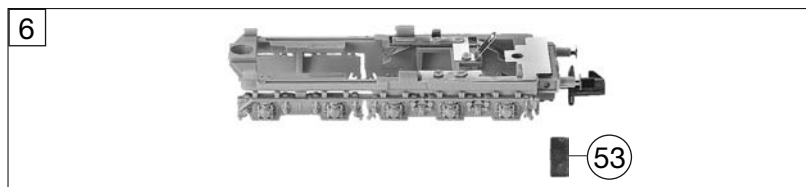
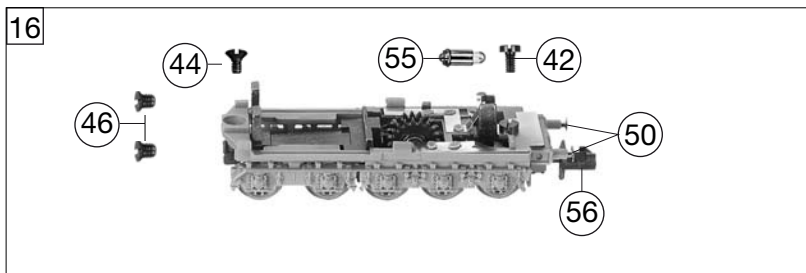
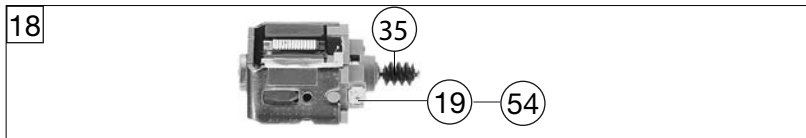
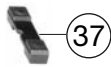
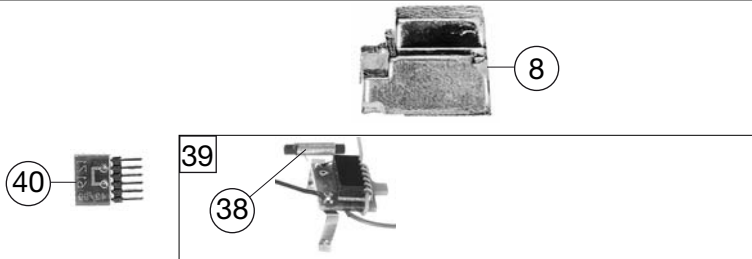

781201		BR 01.10 DRB		NEM		=		N	
Pos. Nr. Pos. no.	Beschreibung Description				Art.-Nr. Art. no.	Preisgruppe Price bracket			
35	SCHNECKE D = 4MM L = 5MM worm				00567601	007			
36	STROMABNEHMEREINSATZ MIT LICHT Power pick-up assembly with light				60781201	---			
37	ABSTANDSHALTER spacer				00627172	006			
38	ENTSTOERDROSSEL suppressor choke				00644101	007			
39	SCHALTPL. TENDER F.7171/2/3 S switch for tender				00657084	024			
40	SCHNITTST.-BLINDSTECKER 6-POL. Interface for blind 6-pin jumper				00664002	013			
41	SCHRAUBE M 1,4 X 3 worm				00700203	001			
42	SCHRAUBE worm				00700303	001			
43	SCHRAUBE worm				00700307	001			
44	SCHRAUBE worm				00702304	001			
45	BLECHSCHRAUBE M.KREUZSCHLITZ trapping screw				00713309	001			
46	SCHRAUBE worm				00730025	002			
47	BOLZEN F. ZAHNRAD bolt for gear wheel				00730504	002			
48	BOLZEN F. KUPPELSTANGE Bolt for coupling rod				00730565	002			
49	BOLZEN F. KUPPELSTANGE Bolt for coupling rod				00730566	002			
50	STECKPUFFER plug-in buffer				00757002	002			
51	ANDRUECKFEDER F.VORLAUFGESTELL pressure spring for front bogie				00767002	001			
52	ANDRUECKFEDER F.NACHLAUF 7173 pressure spring for rear bogie				00767003	001			
53	BLATTRICHTFEDER F.KUPPLUNG N Flat straightening spring for coupling				00767006	001			
54	ERSATZ-SCHLEIFKOHLEN carbon brushes set				6518	---			
55	ERS.-GLUEHLAMPE KLAR M.STECKFA Replacement bulb, clear, with plug-in socket				00006535	008			
56	STANDARD-KUPPLUNG standard coupling				9521	---			
--	PROFI-KUPPLUNG profi coupling				9541	---			
--	PROFI-KUPPLUNG VERKUERZT profi coupling shortende				9543	---			