

Pos. Nr. Pos.no.	Beschreibung Description	Art.-Nr. Art.no.	Preisgruppe Price bracket
722403	DB Br 260	==	N
722483		==	N
1	Gehäuse kpl. Betr. Nr. 260 269-6 Body complete Loco. no. 260 269-6	10722403	35
2	Dach Roof	12722401	9
3	TS - Lichtleiter Part set - Light conductor	13722401	8
4	TS - Fenster Part set - Window	14722401	10
5	TS - Griffe Part set - Handles	19722403	7
6	Antenne Antenna	00197830	3
7	Antenne 3,4 mm Antenna	19787900	7
8	Horn Horn	19762820	3
9	Auspuff + Verkleidung Chimney + casing	19786010	12
10	Umlaufblech Runway	11722403	22
11	TS - Griffe Part set - Handles	19783400	11
12	TS - Bühnengeländer Part set - Platform railing	19786110	18
13	Bühne lang + kurz Platform long + short	19786210	15
14	Platine vorne PCB front	65714710	14
15	Platine hinten PCB rear	00657115	13
16	Stromabnehmereinsatz Power pick-up assembly	60722584	18
17	Kühlblech Cooling plate	62722581	7
<b>Digital</b>			
18	Platine vorne PCB front	00657118	13
19	DCC decoder DCC decoder	68722581	33

Änderungen in Konstruktion und Ausführung vorbehalten  
We reserve the right to change the construction and specification

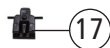
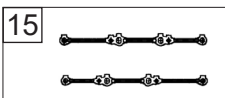
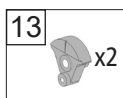
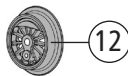
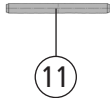
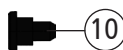
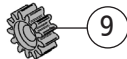
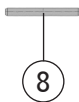
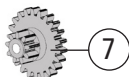
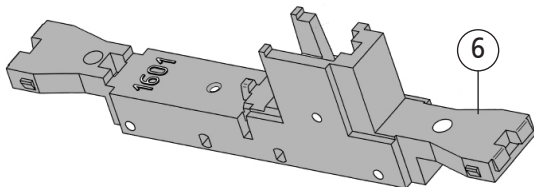
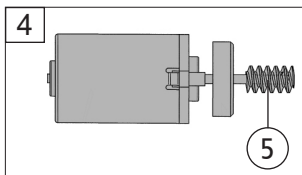
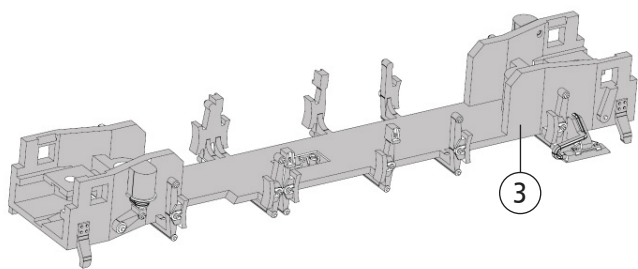

Pos. Nr. Pos.no.	Beschreibung Description	Art.-Nr. Art.no.	Preisgruppe Price bracket
722403	DB Br 260		N
722483			N
1	Puffer gewölbt Buffer curved	00757011	2
2	Puffer flach Buffer flat	00757012	2
3	Abdeckplatte Getriebe Cover plate for gears	43722401	11
4	Motor m. Schwungm. + Schnecke Motor w. flywheel + wormgear	50722504	30
5	Schnecke Wormgear	00567608	8
6	Grundrahmen Base frame	146577	12
7	Unterstützungsrad Z=9/22 Reduction gearwheel	00567158	6
8	Achse f. Zahnrad Axle for gearwheel	00730541	1
9	Zahnrad Z=13 Gearwheel	00567159	5
10	Bundbolzen L=2,6 D=1/1,5 mm Flanged bolt	00730578	3
11	Achse D=1 L=11,8 mm Axle	00527003	1
12	Lokrad Loco wheel	00517088	6
13	TS - Blindwellenkurbel Part set - Jackshaft crank	00517900	8
14	Zahnrad Z=16 Gearwheel	00567137	5
15	TS - Kuppelstangen Part set - Coupling rod	00427225	11
16	Bolzen f. Kuppelstangen Bolt for coupling rods	00730579	1
17	Kupplungsadapter Coupling adaptor	00387005	7
18	Kupplung N Coupling	98189	6
19	Schraube M1,6x10 mm Screw	85746	3
20	Standard Steckkupplung Standard plug-in coupling	9525	---