

781705	ÖBB	Rh 1116	=		N
781775			=	🔊	N

Pos. Nr. Pos.no.	Beschreibung Description	Art.-Nr. Art.no.	Preisgruppe Price bracket
1	GEHÄUSE O. PANTO. BETR.NR. 1116 199 Body ass. w/o panto.Loco no. 1116 199	10781705	33
2	TS - FÜHRERSTAND-LICHTLEITER Part set - Driver's cab - Light conductor	13781703	8
3	TS - STIRNFENSTER-SEITENFENSTER Part set - Front and side window	14781703	19
4	ISOLATOREN-SATZ Set of isolators	19731101	12
5	STIRNGRIFF Front handrail	19731105	6
6	HAUPTSCHALTER-ISOLATOR Mains switch, isolator	197311012	3
7	ISOLATOR Isolator	197311013	3
8	ISOLATOR Isolator	197311014	3
9	LEITUNG AM DACH Roof wiring	197311015	2
10	ARMATURENTEIL (UNTERFLUR) Fittings assy	33781705	12
11	MOTOR KPL.M.SCHWUNGMASSE Motor with flywheel, complete	50731212	31
12	KOHLHALTER Brush holder	00507801	1
13	MOTORDISTANZPLATTE,LED-ABDECK., Motor spacer plate, LED-cover,	50791600	9
14	LEITERPLATTE KPL. ANALOG PCB complete	65716400	28
15	BRÜCKENSTECKER Jumper	126404	9
16	EINHOLMSTROMABNEHMER Single arm pantograph	67703800	22
17	FK - SCHRAUBE M1,2x2,6 mm FK - Screw	70900005	2
18	ANTENNE LANG Antenna long	00197802	2
19	KOHLEBÜRSTE+FEDER Carbon brush+spring	133936	6
Sound			
20	LEITERPLATTE KPL. SOUND PCB complete	65716800	36
21	LAUTSPRECHERHALTER+KLAMMER Loudspeaker holder+Bracket	68702600	4
22	LAUTSPRECHER Loudspeaker	68702500	16

Änderungen in Konstruktion und Ausführung vorbehalten
We reserve the right to change the construction and specification

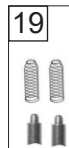
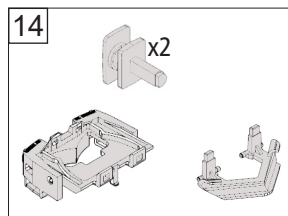
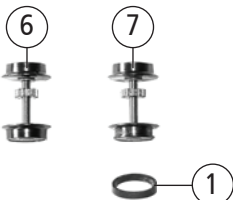
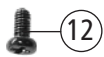
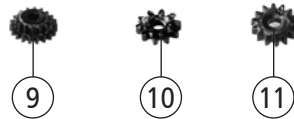
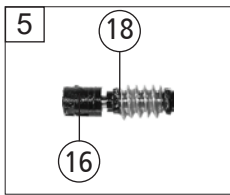
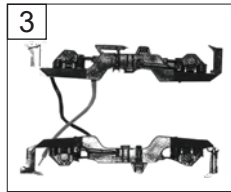

Pos. Nr. Pos.no.	Beschreibung Description	Art.-Nr. Art.no.	Preisgruppe Price bracket
781705	ÖBB Rh 1116		N
781775			N
1	HAFTREIFEN Traction tyre	00547002	1
2	LOKFAHRGESTELL O.MOTOR Loco chassis w/o motor	40731212	20
3	DREHGESTELLBLENDEN Bogie frames	41781303	14
4	GETRIEBE-SATZ 3-tlg. Gear set 3-piece	45731111	17
5	SCHNECKENBAUGRUPPE KPL. Worm gear assembly, complete	52731201	15
6	RADSATZ M. ZR O. HAFTRING Wheelset w.gear wheel w/o trac.tyre	53713900	15
7	RADSATZ M. ZR M. 1 HAFTRING Wheelset w.gear wheel w. 1trac.tyre	53714000	15
8	DEICHSEL Bogie	38801800	6
9	UNTERSETZUNGSRAD Z=14/19 Reduction gear wheel	56717700	6
10	ZAHNRAD Z=10 Gear wheel	56717800	3
11	ZAHNRAD Z=14 Gear wheel	56717900	3
12	GF - SCHRAUBE M1,6x4 mm GF - Screw	114850	3
13	SK - SCHRAUBE M1,6x4 mm SK - Screw	115161	3
14	TS - PUFFER,PUFFERBRUST Part set - Buffer, buffer beam	75781705	11
15	ZUGFEDER Draw spring	86208	3
16	KARDASCHALE F. SCHNECKENSATZ Cardan reception f. wormgear set	145585	3
17	ACHSLAGER N Axle bearing	145530	6
18	BEILAGSCHEIBE Washer	145804	4
19	ERSATZ-SCHLEIFKOHLEN Carbon brushes set	6518	---
20	STANDARD-STECKKUPPLUNG Standard clip-in coupling	9525	---
21	PROFI-STECKKUPPLUNG Profi clip-in coupling	9545	---
22	Kupplung N-Spur Coupling	98189	6