

871420		BR VT4.04	Eurobahn	~	HO
Pos. Nr. Pos. no.	Beschreibung Description	Art.-Nr. Art. no.	Preisgruppe Price bracket		
1	GEHAUESE F.MOT.TK LINT DBAG (n. lieferb.) Motor coach body (not available)				
2	FUEHRERSTAND M. LOKF. Driver's cab inset	00124420	012		
3	FALTENBALG F.4420 Gangway bellows	00125116	009		
4	LICHTLEITER-SATZ F.4420,4423 Light conductor set	00134420	009		
5	LICHTLEITER-SATZ F.4420 (n. lieferb.) Light conductor set (not available)				
6	FENSTERSATZ F.TRIEBWAGEN O.MOT. (n. lieferb.) Trailer coach window set (not available)				
7	FENSTERSATZ F.TRIEBWAGEN M.MOT. (n. lieferb.) Motor coach window set (not available)				
8	INNENEINRICHTUNG F.MOTORWAGEN (n. lieferb.) Interior fittings for motor coach (not available)				
9	BESCHWERUNG F.4420,4423 Ballast for power car	00164420	014		
10	BESCHWERUNG F.LINT O.MOTOR Ballast for trailer car	01644201	013		
11	SCHEIBENWISCHER,KUPPL.ATTR./S. Windshield wipers, coupling imitation-set	00194420	007		
12	ABGASHUTZEN F.4420,4423 Exhaust silencer	00194855	003		
13	GEH.TK O.M.4420 (n. lieferb.) Trailer car body (not available)				
14	INNENEINRICHTUNG F.TK O.MOT. (n. lieferb.) Interior fittings for trailer car (not available)				
15	JAKOBSDREHGESTELL F.4420,4423 JAKOBS bogie	00304420	018		
16	DREHGESTELLRAHMEN F.4420,4423 Bogie framework	00314420	009		
17	WAGENBODEN F.4420 F.TK M.MOT. (n. lieferb.) Floor plate for motor coach (not available)				
18	DREHGEST.AUFN.F.JAKOBSDREHGEST Bogie reception connector	00384420	003		
19	KUPPELSTANGE F.4420,4423 Coupling rod	00386012	002		
20	DREHGESTELLRAHMEN F.LAUFGEST. Bogie framework	00414420	009		
21	WAGENBODEN F.4420 O.MOT. (n. lieferb.) Floor plate for trailer car (not available)				
22	DREHGEST.BLOCK F.4420,4423 Bogie block	00454420	016		
23	LAUFDREHGEST.BLOCK F.4420,4423 Bogie block	00464420	013		
24	MOTOR KPL.M.SCHWUNGMASSE Motor with flywheel, complete	00504420	029		
25	KOEHLENHALTER Brush holder	00507801	001		
26	MOTORHALTEBUEGEL Motor retainer clip	00507903	004		
27	ACHSE Axle	00524014	002		
28	ACHSE Axle	00527001	002		
29	RADSATZ M.Z.M.1 N.F.4420,4423 Wheelset with gear wheel, with trac. tyre	00534119	012		
30	RADSATZ EINS.ISO. 25MM F.4420 Wheelset single side insulated	00534120	007		
31	RADSATZ O.Z.O.N.F.4420,4423 Wheelset w/o gear wheel, w/o trac. tyre	00534121	012		
32	HAFTREIFEN HO Traction tyre	00544011	001		
33	ZAHNRAD Z:16/0.4 Gear wheel	00564189	005		
34	ZAHNRAD Z:13 SCHWARZ Gear wheel	00567149	006		
35	SCHNECKE D = 4MM L = 5MM Worm gear	00567601	007		
36	KONTAKTBUEGEL SATZ F.4420,4423 Contact plate assy	00614978	008		
37	KONTAKTPILZGARNITUR L:10 MM Contacter pin assembly	00644407	011		

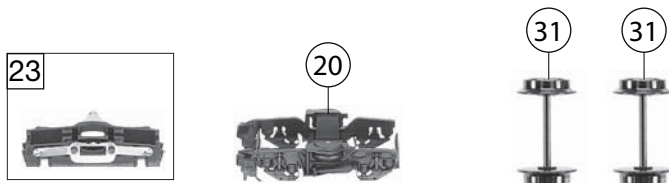
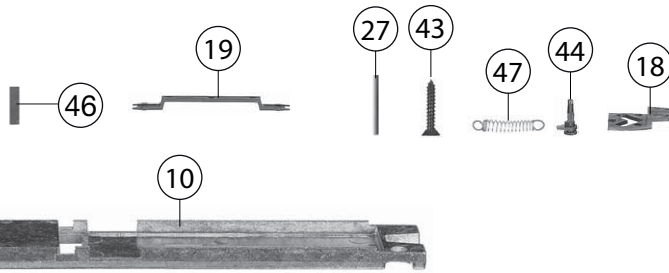
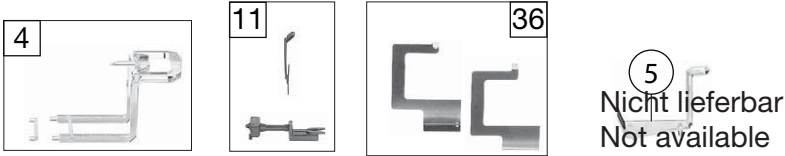
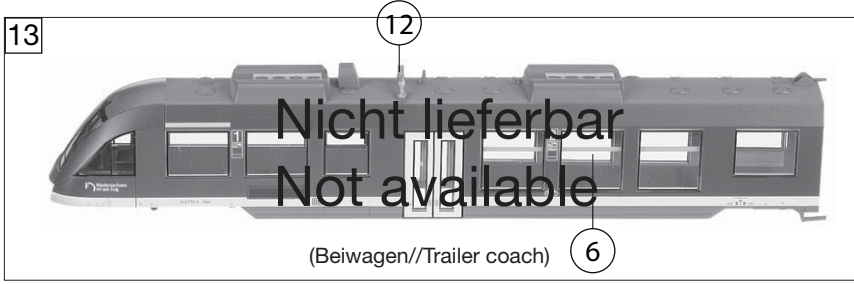

871420		BR VT4.04	Eurobahn	~	HO
Pos. Nr. Pos.no.	Beschreibung Description	Art.-Nr. Art.no.	Preisgruppe Price bracket		
38	MOTORLEITERPLATTE F.4420,4423 Motor PCB	00654108	018		
39	SCHALTPL.M.SS U.LICHTLEITER PCB with interface, with light conductor	00654109	030		
40	LEITERPL.M.LICHTLEITER F.4420 PCB with light conductor	00654110	027		
41	SCHNITTST.-BLINDSTECKER 8-POL. Jumper 8-pin	00664001	012		
42	FLACHLEITER M.STECKER 8-POL. Ribbon cable with plug, 8-pin	00664004	018		
43	SENKKOPFBLECHSCHR.2,2X16 KS Countersunk tapping screw	00714516	001		
44	SPLINT F. 4420,4423 Split pin	00730576	001		
45	SPLINT F. 4420,4423 Split pin	00730577	003		
46	BLATTRICHTFEDER L=14 MM Flat straightening spring	00764012	002		
47	ZUGFEDER F.4420,4423 Draw spring	00764115	002		
48	KONTAKTFEDER F.4420,4423 Contact spring	00764333	001		
	ERSATZ-SCHLEIFKOHLEN (o. Abb.) Carbon brushes (w/o illustr.)	6518	---		