

| Pos. Nr.<br>Pos.no. | Beschreibung<br>Description  | Art.-Nr.<br>Art.no. | Preisgruppe<br>Price bracket |
|---------------------|--|---------------------|------------------------------|
| 991355              | BR 101 DBAG  | 101029-7            | ~ HO                         |
| 1                   | LOKGEH.O.PANTO BR 101 DBAG<br>Body assembly complete, w/o pantographs            | 00104355            | 039                          |
| 2                   | LOKRAHMEN F.4355<br>Loco framework complete                                      | 00114355            | 027                          |
| 3                   | FUEHRERSTAND M.LOKF.<br>Driver's cab inset, with driver                          | 00124355            | 013                          |
| 4                   | LICHTLEITER-SATZ F.BR 101<br>Light conductor - set                               | 00134355            | 011                          |
| 5                   | STIRN-FENSTER-SATZ<br>Set of windows   | 00144355            | 018                          |
| 6                   | ARMATURENTEIL F.BR 101<br>Fittings assy  | 00154355            | 014                          |
| 7                   | ISOLAT.U.DACHSTECKT./S.BR 101<br>Set of isolators&roof equipment                 | 00184355            | 013                          |
| 8                   | SIGNALHORN-SATZ (4 ST.)F.4355<br>Signal horn set (4 pcs.)                        | 00194616            | 011                          |
| 9                   | SCHIENENRAEUMER/SATZ BR 101<br>Rail guard -set                                   | 00224355            | 008                          |
| 10                  | DREHGESTELLRAHMEN 1 F.BR 101<br>Bogie framework #1                               | 00314355            | 016                          |
| 11                  | KUKU-DEICHEL F.4320,4355<br>Short coupling reception                             | 00384016            | 006                          |
| 12                  | DEICHELABDECKUNG F. 4355<br>Shaft cover plate                                    | 00384355            | 011                          |
| 13                  | DREHGESTELLRAHMEN 2 F.BR 101<br>Bogie framework #2                               | 00414355            | 013                          |
| 14                  | DREHGEST.BLOCK 1 KPL.<br>Bogie block #1, complete                                | 00454355            | 026                          |
| 15                  | DREHGEST.BLOCK 2 KPL.<br>Bogie block #2, complete                                | 00464355            | 026                          |
| 16                  | MOTOR KPL.5 POLIG F.BR 101<br>Motor, complete                                    | 00504355            | 027                          |
| 17                  | MOTORHALTER F.5-POL.BÜHLERMOT<br>Motor retainer spring                           | 00504904            | 002                          |
| 18                  | ACHSE F.DREHGEST.HALT.4320/55<br>Bogie fixation pin                              | 00524012            | 001                          |
| 19                  | RADSATZ M.Z.O.N.F.BR 101<br>Wheelset complete with gear wheel, w/o trac. tyre    | 00534061            | 015                          |
| 20                  | RADSATZ M.Z.M.1 N.F.BR 101<br>Wheelset complete with gear wheel, with trac. tyre | 00534062            | 015                          |
| 21                  | HAFTREIFEN HO<br>Traction tyre   | 00544006            | 001                          |
| 22                  | KARDANWELLE F.4320/4355<br>Cardan shaft  | 00564500            | 002                          |
| 23                  | KONTAKTBAND F.BR 101<br>Contact band   | 00614962            | 008                          |
| 24                  | UMSCHALTER F. OBERLEITUNG<br>Switch for overhead catenary                        | 00644355            | 012                          |
| 25                  | KONTAKTPILZGARNITUR L:12 MM<br>Contactor pin assembly                            | 00644404            | 011                          |
| 26                  | LEITERPLATTE UNTEN F.BR 101<br>Lower PCB   | 00654056            | 018                          |
| 27                  | LEITERPLATTE OBEN M.SCHNITTST.<br>Upper PCB, with interface                      | 00654072            | 027                          |
| 28                  | SCHNITTST.-BLINDSTECKER 8-POL.<br>Jumper, 8-pin                                  | 00664001            | 012                          |
| 29                  | EINHOLMPANTO.F.4320/22/24/55<br>Single arm pantograph                            | 00674323            | 020                          |
| 30                  | SCHRAUBE<br>Screw  | 00702403            | 001                          |
| 31                  | LINSENSCHRAUBE M.KREUZSCHLITZ<br>Button screw                                    | 00704905            | 001                          |
| 32                  | RICHTFEDER L=27 MM<br>Straightening spring l=27mm                                | 00764014            | 002                          |
|                     | PROFI-STECKKUPPLUNG (o. Abb.)<br>Profi coupling (w/o illustration)               | 6515                | ---                          |
| 34                  | GLUEHLAMPE WEISS F.4355 - 8V<br>Bulb, clear, with plug-in socket, 8V             | 00006538            | 008                          |
| 35                  | GLUEHLAMPE ROT F.4355 - 8V<br>Bulb, red, with plug-in socket, 8V                 | 00006539            | 009                          |

|                      |                             |                      |                              |           |
|----------------------|-----------------------------|----------------------|------------------------------|-----------|
| <b>991355</b>        | <b>BR 101 DBAG</b>          | <b>101029-7</b>      | ~                            | <b>H0</b> |
| Pos. Nr.<br>Pos. no. | Beschreibung<br>Description | Art.-Nr.<br>Art. no. | Preisgruppe<br>Price bracket |           |

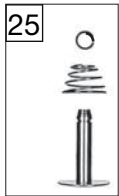
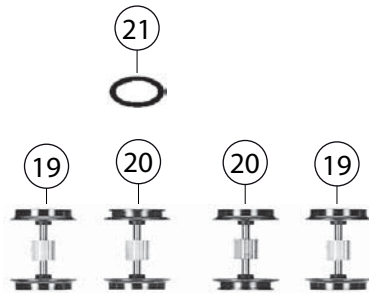

Achtung,  
wichtiger Hinweis:

Der Motor darf unter  
keinen Umständen  
geölt werden!