

717201		BR 012	DB	=	N
Pos. Nr. Pos.no.	Beschreibung Description	Art.-Nr. Art.no.	Preisgruppe Price bracket		
1	LOKGEHÄUSE KPL. Body assembly complete	10717201	028		
2	UMLAUFBLECH KPL. Running board complete	11717201	024		
3	LICHTLEITER Light conductor	00137171	006		
4	KUPPLUNGSHAKEN Coupling hook	00197701	003		
5	TOPFANTENNE BRÜN. Antenna	00197801	003		
6	TENDERGEHÄUSE KPL. Tender body complete	20717201	019		
7	TENDERRAHMEN Tender framework	21717201	018		
8	FLUTLICHTEINSATZ F. TENDER Light conductor for tender	00237171	006		
9	BESCHWERUNG Ballast	00267172	012		
10	LOKFAHRGESTELL KPL. Loco chassis complete	30717201	037		
11	LOKFAHRGESTELL M. RÄDERN Loco chassis with wheels	31717201	030		
12	KREUZKÖPFE MIT VERBUNDSTANGEN Cross-heads with coupling rod	03271721	018		
13	DECKPLATTE UNTEN Cover plate	00337172	007		
14	KUPPELLASCHE Coupling latch	00347171	004		
15	VORLAUFGESTELL KPL. MIT BLATTF Set of carrying wheels complete w.flat spring	00377160	016		
16	SCHLEPPGESTELL KPL. Set of carrying wheels (rear) complete	00397170	018		
17	TENDERFAHRGESTELL KPL. O. MOTOR Tender chassis complete w/o motor	40717201	031		
18	TENDERFAHRGESTELL M.Z. Tender chassis with gear wheels	41717403	018		
19	MOTOR O.SCHW.O.MASSEKONTAKT Motor with flywheel w/o ground contactor	05071601	027		
20	KOHLENHALTER Brush holder	00507801	001		
21	TENDERRAD O.Z.M.N.ISO.ROT Tender wheel. w/o gear wheel, w. traction tyre	00517003	006		
22	TENDERRAD M.Z.M.N.ISO.ROT Tender wheel w.gear wheel, w.traction tyre	00517004	006		
23	TREIBRAD GR.GEGENGEW.ROT Driving wheel with big counterweight,red	00517011	007		
24	KUPPELRAD KL.GEGENGEW.ROT Coupled wheel with small counterweight, red	00517012	007		
25	TENDERRAD O.Z.O.N.ISO.ROT Tender wheel. w/o gear wheel, w/o traction tyre	00517013	007		
26	TENDERRAD M.Z.O.N.ISO.ROT Tender wheel. w/o gear wheel, w/o traction tyre	00517017	007		
27	ACHSE Axle	00527001	002		
28	ZAHNRAD M.METALLACHSE Z=12 Gear wheel with metal axle Z=12	00527171	006		
29	V.+ NACHLAUFRADSATZ Carrying wheelset complete	00537007	011		
30	NACHLAUFRADS.7123/70/71 Carrying wheelset (rear)	00537020	012		
31	HAFTREIFEN Traction tyre	00547001	001		
32	ZAHNRAD Gear wheel	00567106	004		
33	ZAHNRAD Z:20/20 SCHWARZ Gear wheel Z:20/20 black	00567107	006		
34	SCHNECKE D = 4MM L = 5MM Worm gear D=4mm, L=5mm	00567601	007		

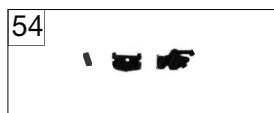
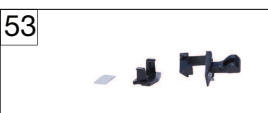
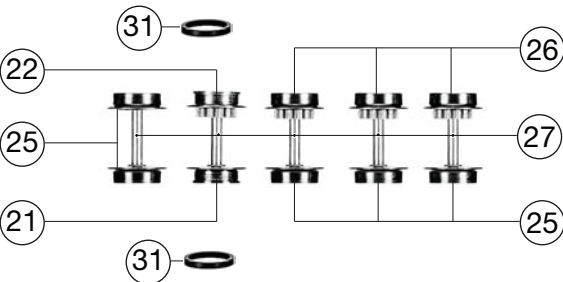
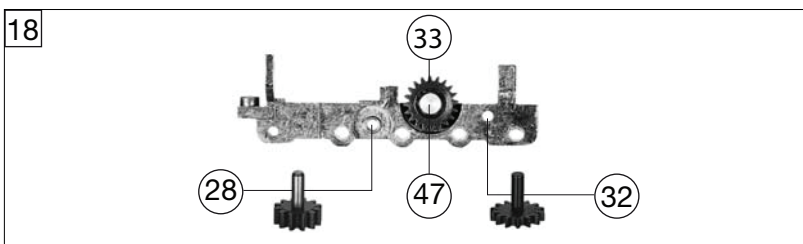
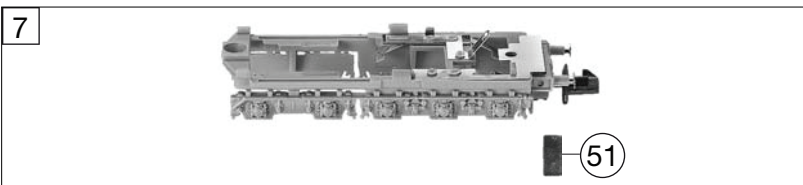
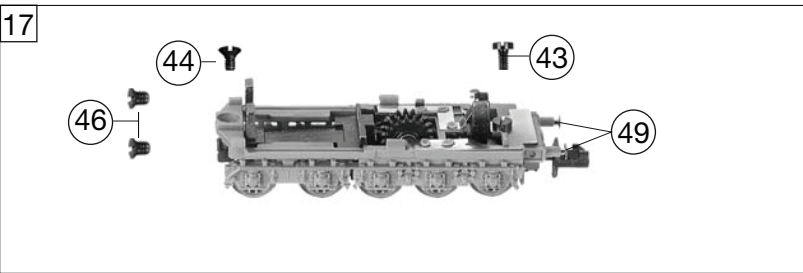
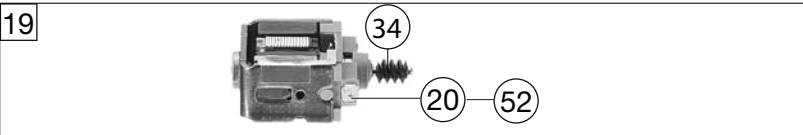
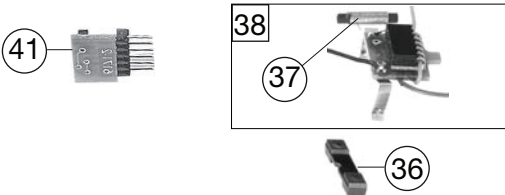
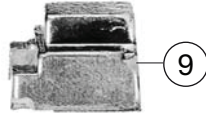
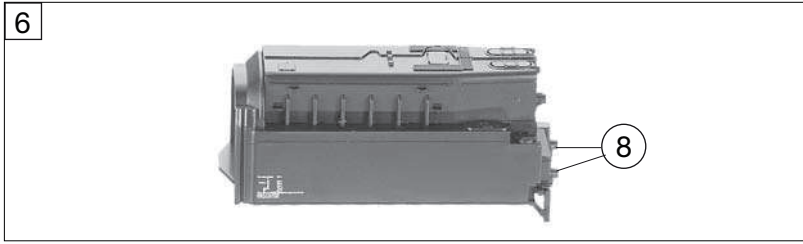

717201		BR 012	DB	=	N
Pos. Nr. Pos.no.	Beschreibung Description	Art.-Nr. Art.no.	Preisgruppe Price bracket		
35	STROMABNEHMEREINSATZ Power pick-up assembly	60717201	018		
36	ABSTANDSHALTER Spacer	00627172	006		
37	ENTSTOERDROSSEL Suppressor choke	00644101	007		
38	SCHALTPL.TENDER F.7171/2/3 S Tender PCB	00657084	024		
	LICHTPLATINE VORNE BR 01 N (o.Abb.) Forward light PCB (w/o illustration)	65719700	014		
	LICHTPLATINE HINTEN BR 01 N (o.Abb.) Rear light PCB (w/o illustration)	65719800	014		
41	SCHNITTST.-BLINDSTECKER 6-POL. Jumper 6-pin	66401600	013		
42	SCHRAUBE M 1,4 X 3 Screw M 1,4 X 3	00700203	001		
43	SCHRAUBE (M 1,7 X 3) Screw (M 1,7 X 3)	00700303	001		
44	SCHRAUBE M 1,7x4 brüniert Screw M 1,7x4	00702304	001		
45	BLECHSCHRAUBE M.KREUZSCHLITZ Tapping screw	00713309	001		
46	SCHRAUBE Screw	00730025	002		
47	BOLZEN F. ZAHNRAD Bolt for gear wheel	00730504	002		
48	BOLZEN F. KUPPELSTANGE Bolt for coupling rod	00730565	002		
49	STECKPUFFER gestempelt Plug-in buffer	75710500	002		
50	ANDRUCKFEDER F.VORLAUFGESTELL Pressure spring for wheelset front	00767002	001		
51	BLATTRICHTFEDER F.KUPPLUNG N Flat straightening spring for coupling	00767006	001		
52	ERSATZ SCHLEIFKOHLEN Carbon brushes set	6518	---		
53	STANDARD-KUPPLUNG Standard coupling	9521	---		
54	PROFI-KUPPLUNG Profi coupling	9541	---		